



TIMBER SALE MAP

This information provided by authority of Part 525, 1994 PA 451, as amended.

Forest Management Unit Atlanta		County Montmorency	Mapped By Natzke	Date 06/08/2023	Page 2	of 3
Township 32N	Range 03E	Section(s) and Subdivision(s) Sec.6 NWNW, Sec 7 E2NW, NE, E2SW, SE, Sec 8 SWSW.		Scale 1:15,840		
Cover Type			Density			

A = Aspen	H = Hemlock	N = Marsh	U = Upland Brush
B = Paper Birch	J = Jack Pine	O = Oak	UM = Upland Mixed
C = Cedar	L = Lowland Brush	P = Lowland Poplar	V = Bog or Marsh
D = Treed Bog	LM = Lowland Mixed	Q = Mixed Swamp Conifer	W = White Pine
E = Swamp Hdwoods	M = Mpl, Bch, Brch	R = Red Pine	X = Non Stocked
F = Spruce Fir	MC = Mixed Conifer	S = Black Spruce	Z = Water
G = Grass	MD = Mixed Deciduous	T = Tamarack	

0 = Non Stocked	5 = Pole Timber Medium
1 = Seedling Sapling Poor	6 = Pole Timber Well
2 = Seedling Sapling Medium	7 = Saw Timber Poor
3 = Seedling Sapling Well	8 = Saw Timber Medium
4 = Pole Timber Poor	9 = Saw Timber Well

Big Rock Mix

Compartment 70

176.2 Acres

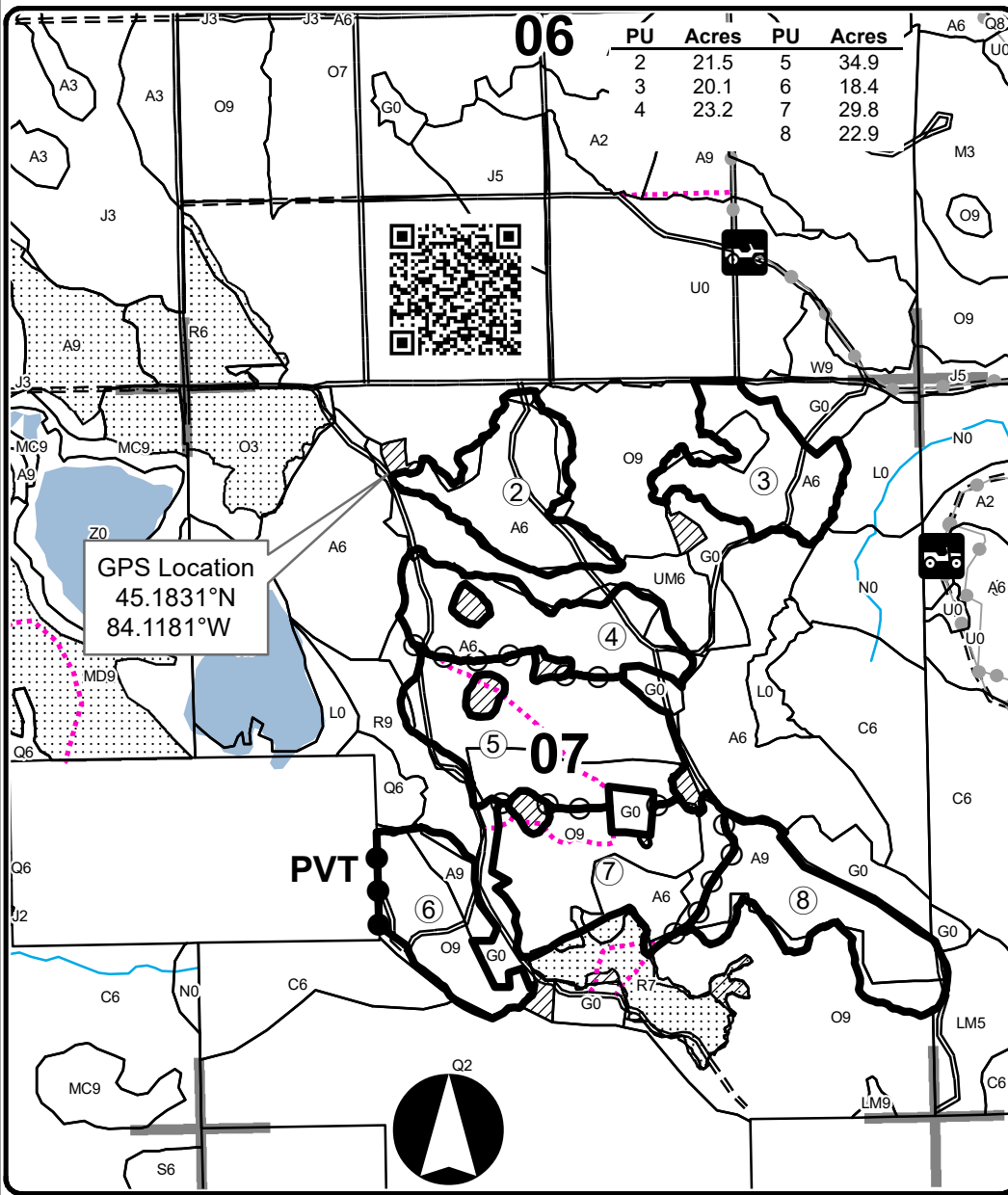

- Against State (Red)
- Payment Unit (Yellow)
- Private Line (Blue)
- Payment Unit
- Retention Area
- Nearby Timber Sales
- Stand Boundaries
- Recreational Trail
- ORV Routes
- Secondary Forest Road
- Forest Access Route
- Temporary Management Access
- Perennial River
- Lakes and Rivers
- Section Corners

Locator Map

1:150,000

