



Sale Number	Year
54 - 020	20

# TIMBER SALE MAP

This information provided by authority of Part 525, 1994 PA 451, as amended.

Forest Management Unit Atlanta Management Unit		County Montmorency	Mapped By Coy	Date 4/10/2020	Page 1	of 2
Township 31N & 32N	Range 03E	Section(s) and Subdivision(s) 3- SENW 22- SESW, SE4 27-NENW, E2SW, W2SE 34- NENW, NWNE, NWSW, & S2SW		Scale 1:15,840		
<b>Cover Type</b>				<b>Density</b>		
A = Aspen	H = Hemlock	N = Marsh	U = Upland Brush	0 = Non Stocked	5 = Pole Timber Medium	
B = Paper Birch	J = Jack Pine	O = Oak	UM = Upland Mixed	1 = Seedling Sapling Poor	6 = Pole Timber Well	
C = Cedar	L = Lowland Brush	P = Lowland Poplar	V = Bog or Marsh	2 = Seedling Sapling Medium	7 = Saw Timber Poor	
D = Treed Bog	LM = Lowland Mixed	Q = Mixed Swamp Conifer	W = White Pine	3 = Seedling Sapling Well	8 = Saw Timber Medium	
E = Swamp Hdwoods	M = Mpl, Bch, Brch	R = Red Pine	X = Non Stocked	4 = Pole Timber Poor	9 = Saw Timber Well	
F = Spruce Fir	MC = Mixed Conifer	S = Black Spruce	Z = Water			
G = Grass	MD = Mixed Deciduous	T = Tamarack				

PU	Acres	PU	Acres
1	23.6	6	14.4
2	24.5	7	15.6
3	19.8	8	23.2
4	20.8	9	14.3
5	15.9	10	9.2

## CR 628 and Voyer Aspen

### Compartment 74

### 181.3 Acres

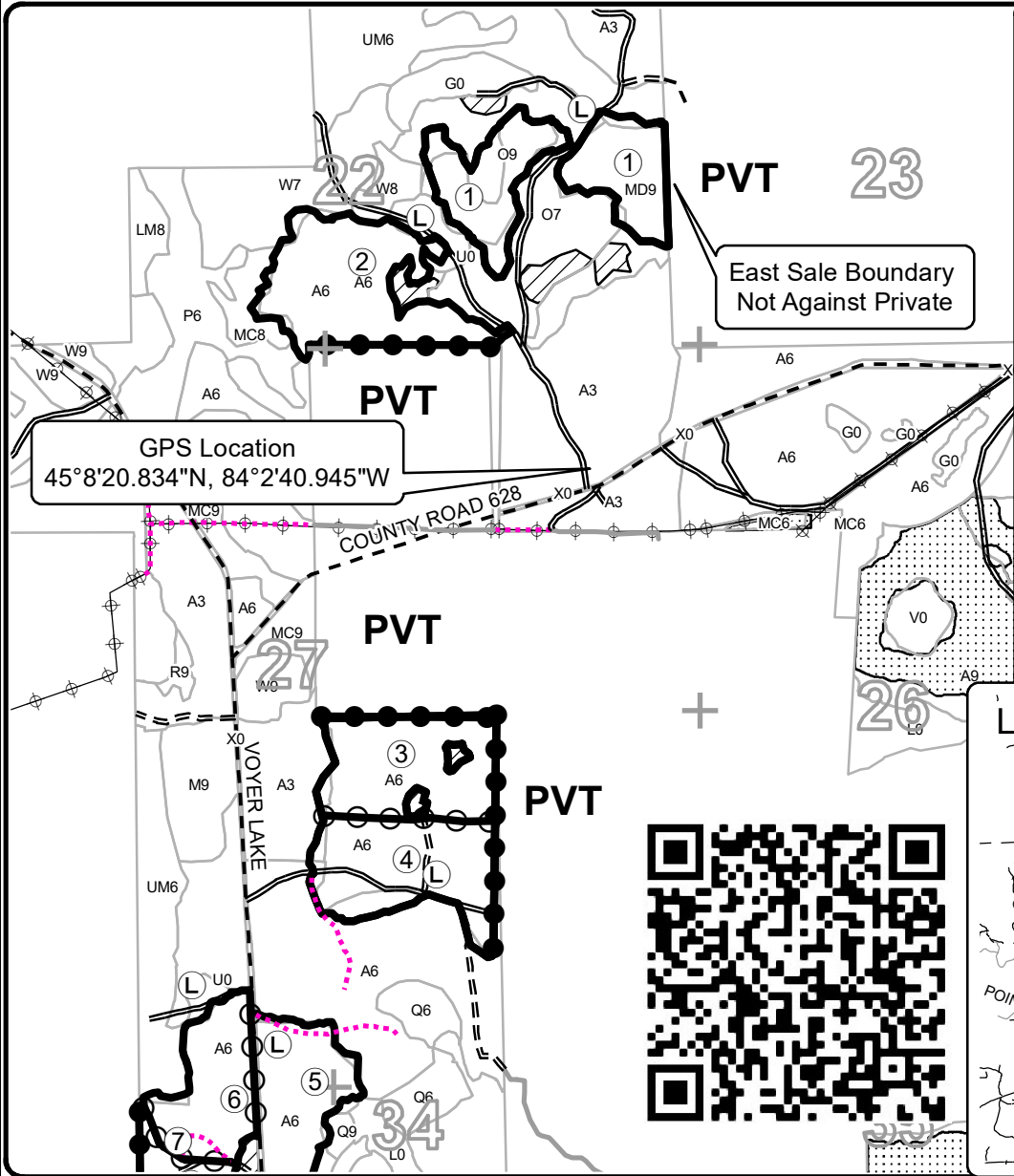
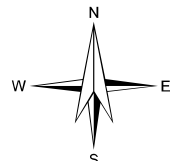

### Legend

- Against State (Red)
- Private Line (Blue)
- Payment Unit (Green)
- ▨ Retention Area (Red)
- ▤ Nearby Timber Sales
- Stand Boundaries
- ⊙ Landing
- Payment Unit
- == Secondary Forest Road
- == Forest Access Route
- - Gravel Road
- Private
- ⋯ Temporary Management Access
- ⊕ Powerline
- ⊕ Section Corners

