



# TIMBER SALE MAP

This information provided by authority of Part 525, 1994 PA 451, as amended.

Forest Management Unit Atlanta Management Unit		County Montmorency	Mapped By A Krugh	Date 09/21/2017	Page 1	of 2
Township 32N	Range 03E	Section(s) and Subdivision(s) Sec 25 S2NE SENW NESE NESW Sec 26 W2NE N2NW SENW NESW Sec 35 E2NW		Scale 1:15,840		

Cover Type				Density	
A = Aspen	H = Hemlock	N = Marsh	U = Upland Brush	0 = Non Stocked	5 = Pole Timber Medium
B = Paper Birch	J = Jack Pine	O = Oak	UM = Upland Mixed	1 = Seedling Sapling Poor	6 = Pole Timber Well
C = Cedar	L = Lowland Brush	P = Lowland Poplar	V = Bog or Marsh	2 = Seedling Sapling Medium	7 = Saw Timber Poor
D = Treed Bog	LM = Lowland Mixed	Q = Mixed Swamp Conifer	W = White Pine	3 = Seedling Sapling Well	8 = Saw Timber Medium
E = Swamp Hdwoods	M = Mpl, Bch, Brch	R = Red Pine	X = Non Stocked	4 = Pole Timber Poor	9 = Saw Timber Well
F = Spruce Fir	MC = Mixed Conifer	S = Black Spruce	Z = Water		
G = Grass	MD = Mixed Deciduous	T = Tamarack			

## Cinnamon Roll Aspen/Oak

Compartment 75  
87.9 Acres

PU	Acres
1	19.1
2	24.2
3	4.9
4	13.3
5	11.0
6	23.8

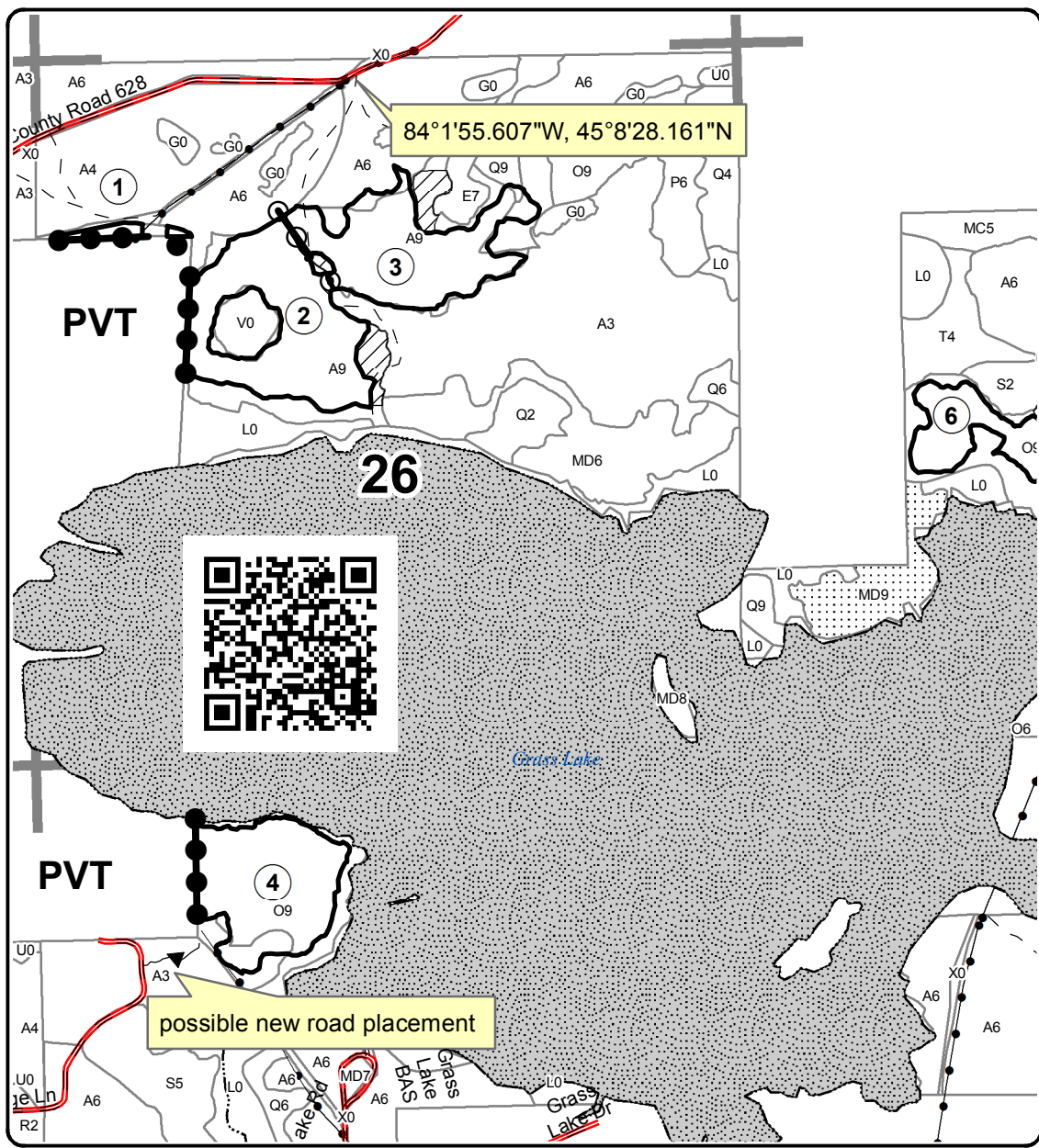

### Legend

- Against State (Red)
- Payment Unit (Yellow)
- Private Line (Blue)
- Payment Unit
- ▨ Retention Area
- ▤ Nearby Timber Sale
- Stand Boundaries
- Section Corners
- Pipeline; Powerline
- ▤ Lakes

Locator Map  
1:200,000

