



TIMBER SALE MAP

This information provided by authority of Part 525, 1994 PA 451, as amended.

Forest Management Unit
Atlanta Management Unit

County
Montmorency

Mapped By Natzke
Cruised By Natzke

Date
07/08/2021

Page of
1 1

Township
29N

Range
01E

Section(s) and Subdivision(s)
Sec. 6 NENW, NWNE, S2NE, T30N R01E Sec. 31 S2SW, SWSE

Scale
1:15,840

Cover Type

- | | | | |
|-------------------|----------------------|-------------------------|-------------------|
| A = Aspen | H = Hemlock | N = Marsh | U = Upland Brush |
| B = Paper Birch | J = Jack Pine | O = Oak | UM = Upland Mixed |
| C = Cedar | L = Lowland Brush | P = Lowland Poplar | V = Bog or Marsh |
| D = Treed Bog | LM = Lowland Mixed | Q = Mixed Swamp Conifer | W = White Pine |
| E = Swamp Hdwoods | M = Mpl, Bch, Brch | R = Red Pine | X = Non Stocked |
| F = Spruce Fir | MC = Mixed Conifer | S = Black Spruce | Z = Water |
| G = Grass | MD = Mixed Deciduous | T = Tamarack | |

Density

- | | |
|-----------------------------|------------------------|
| 0 = Non Stocked | 5 = Pole Timber Medium |
| 1 = Seedling Sapling Poor | 6 = Pole Timber Well |
| 2 = Seedling Sapling Medium | 7 = Saw Timber Poor |
| 3 = Seedling Sapling Well | 8 = Saw Timber Medium |
| 4 = Pole Timber Poor | 9 = Saw Timber Well |

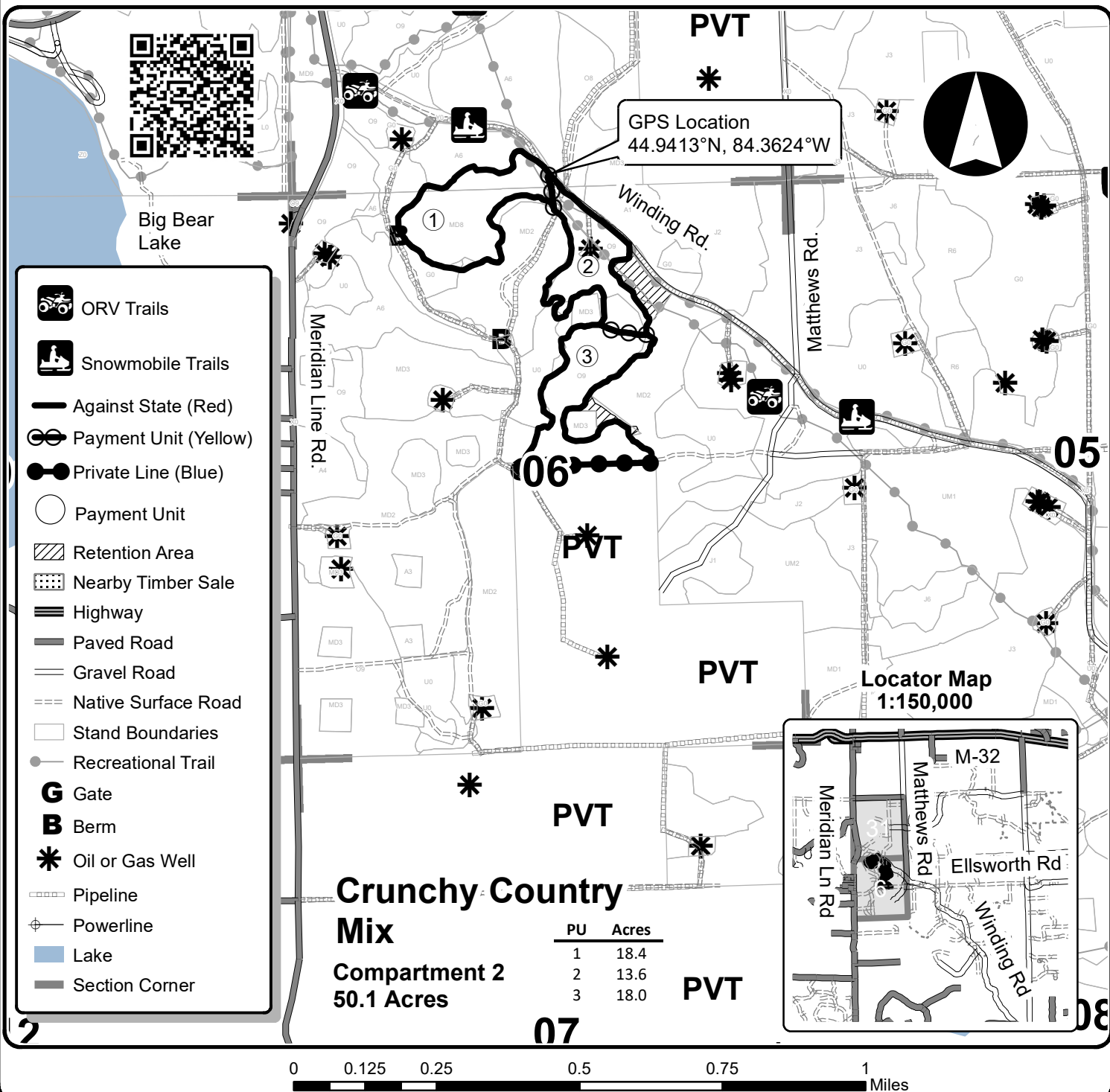

Big Bear Lake

GPS Location
44.9413°N, 84.3624°W



- ORV Trails
- Snowmobile Trails
- Against State (Red)
- Payment Unit (Yellow)
- Private Line (Blue)
- Payment Unit
- Retention Area
- Nearby Timber Sale
- Highway
- Paved Road
- Gravel Road
- Native Surface Road
- Stand Boundaries
- Recreational Trail
- Gate
- Berm
- Oil or Gas Well
- Pipeline
- Powerline
- Lake
- Section Corner

Crunchy Country

Mix

Compartment 2
50.1 Acres

PU	Acres
1	18.4
2	13.6
3	18.0

