

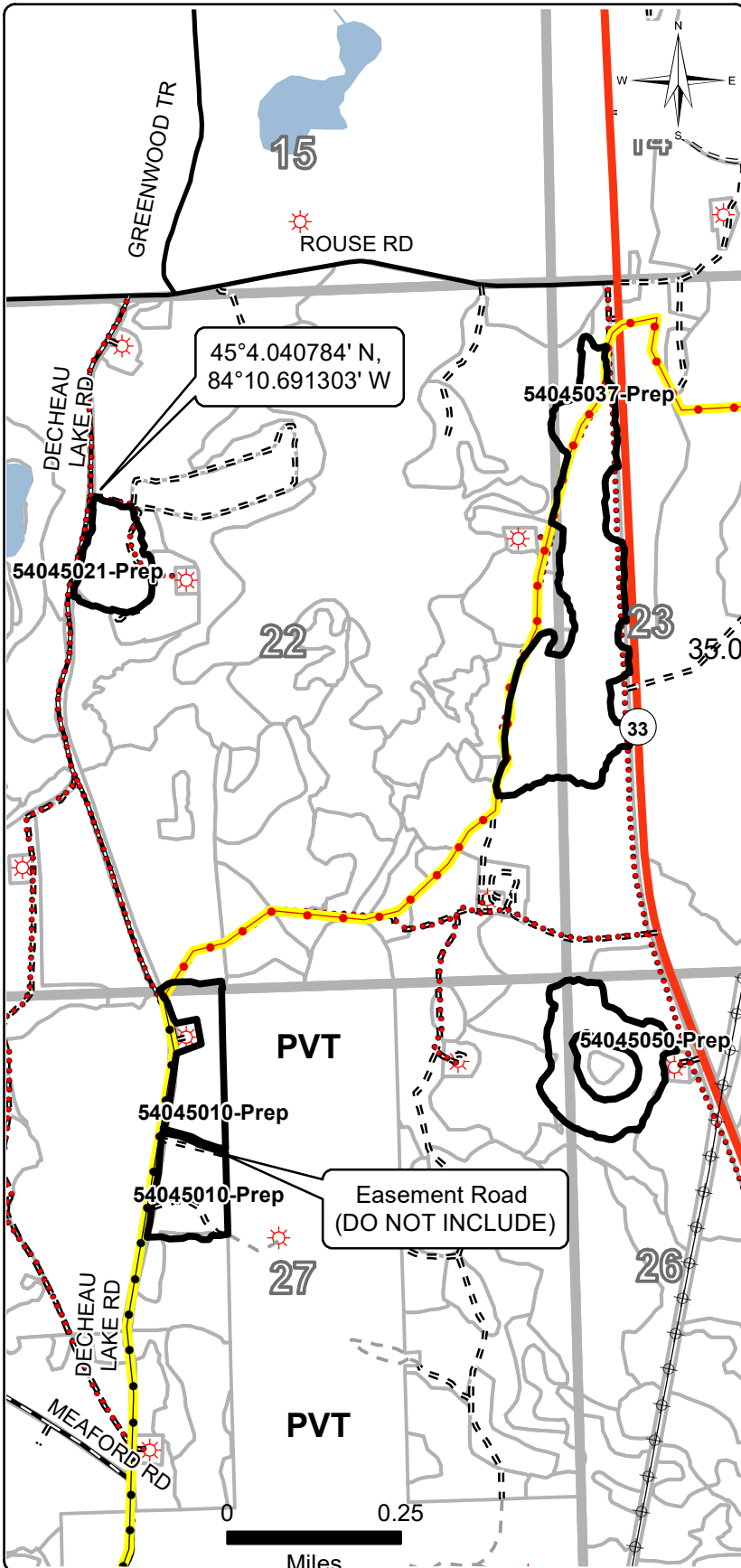

C54-1148

County	Town	Range	Subdivision	YOE	Compartment(s)	Stand(s)
Montgomery	31N	02E	Sec. 22-SENE & NESE 23-W1/2NW & NWSW 26-NWNW 27-NENE & E1/2NW	2018	045	10, 21, 37, 50



Cover Type Objective:	PLANTED RP	Acres:	83.1
Approved Methods:	Rollerchop, herbicide, trench, and plant RP per TMS specs. For all treatments- Retain areas of deciduous regeneration with a goal of 10-30% of RX per RX.		
Treatment Number(s):	54045050-Prep, 54045037-Prep 54045021-Prep, 54045010-Prep		
Timber Sale Number:	54-004-18-01		
Sale Admin Staff:	Coy		
Contract TCR Date:	7/30/21		
Comments:	Do not trench roads, gas pads, pipelines, easement road (54045010 split as mapped) or the ORV and MCCCT Trails. Terrain is flat. Stands have low slash (all chipped) and stumps. Stands will probably need to be rollerchopped and sprayed depending on timing of prep work. There are many wells and pipelines within or near the planting areas.		

Acres	Proofing Comments
Recreation:	Altanta ORV and MCCCT Trail
Water:	None.
HAL:	No hits w/in Rx areas
MNFI:	No hits w/in Rx areas
Other Comments:	54045050-Prep- 15.2 Acres 54045037-Prep- 40.2 Acres 54045021-Prep- 8.5 Acres 54045010-Prep-19.2 Acres

Legend

- C54-1148 Boundary
- Designated Motorcycle Trails**
- License_Type**
- ORV License
- ORV License & Trail Permit
- MCCCT Trail
- Pipeline
- Powerline
- DNR - Secondary Forest Road
- DNR - Forest Access Route
- Federal / State Highway
- Federal / State / County - Paved Road
- County - Gravel Road
- County - Dirt Road (Seasonal)
- Private - Dirt / Gravel Road
- Gas Well
- Lake/Pond
- Perennial River
- Lakes and Rivers All

