



C54-1173

Page 1 of 1



County Montmorency	Town 31N	Range 01E	Subdivision Sec. 1: S2NE, SESE, Sec. 12: N2NE	YOE 2022	Compartment(s) 28	Stand(s) 87, 99
-----------------------	-------------	--------------	---	-------------	----------------------	--------------------

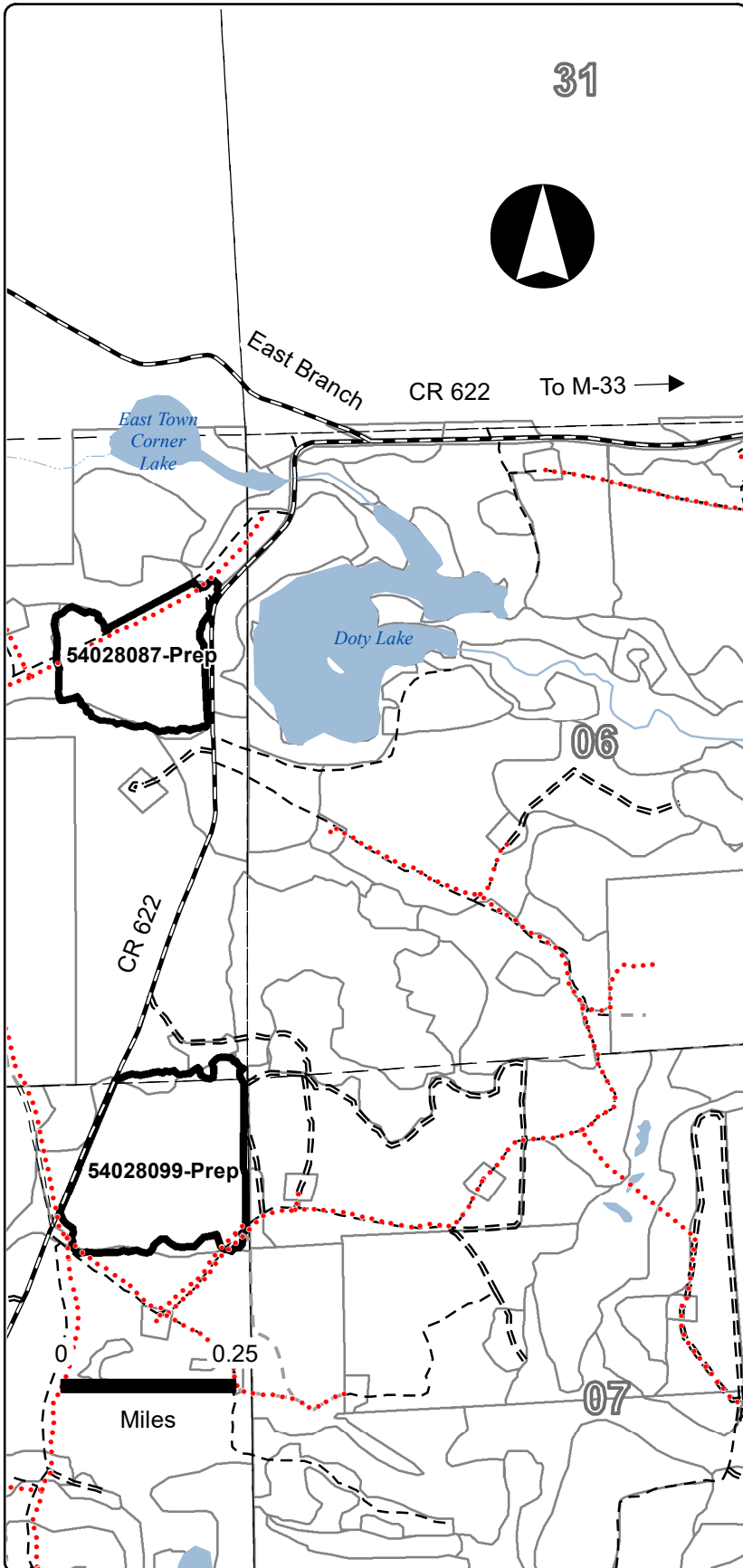

Cover Type Objective:	PLANTED RP	Acres:	59.9
Approved Methods:	Roller chop to set back undesirable deciduous vegetation during the active growing season outside the period April 15 to July 15 to avoid spreading oak wilt.		
Treatment Number(s):	54028087-Prep, 54028099-Prep		
Timber Sale Number:	622 3-spot 540321601		
Sale Admin Staff:	Natzke		
Contract TCR Date:	01/27/2021		
Comments:	Flat to gently-rolling, dry upland. Clear cut using 4' top lopping standard in place of chipping requirement due to lack of chip market.		

Proofing Comments	
Recreation:	No trails within 500-ft
Water:	Doty Lake and associated marsh within 500-ft
HAL:	No hits within Rx areas
MNFI:	54028099-Prep within buffer for ram's head lady slipper, last obs 1946 in cedar swamp
Other Comments:	

Legend	
Pipeline	County - Gravel Road
DNR - Secondary Forest Road	County - Dirt Road (Seasonal)
DNR - Forest Access Route	Private - Dirt / Gravel Road
	Site Prep
	Stand Boundary