

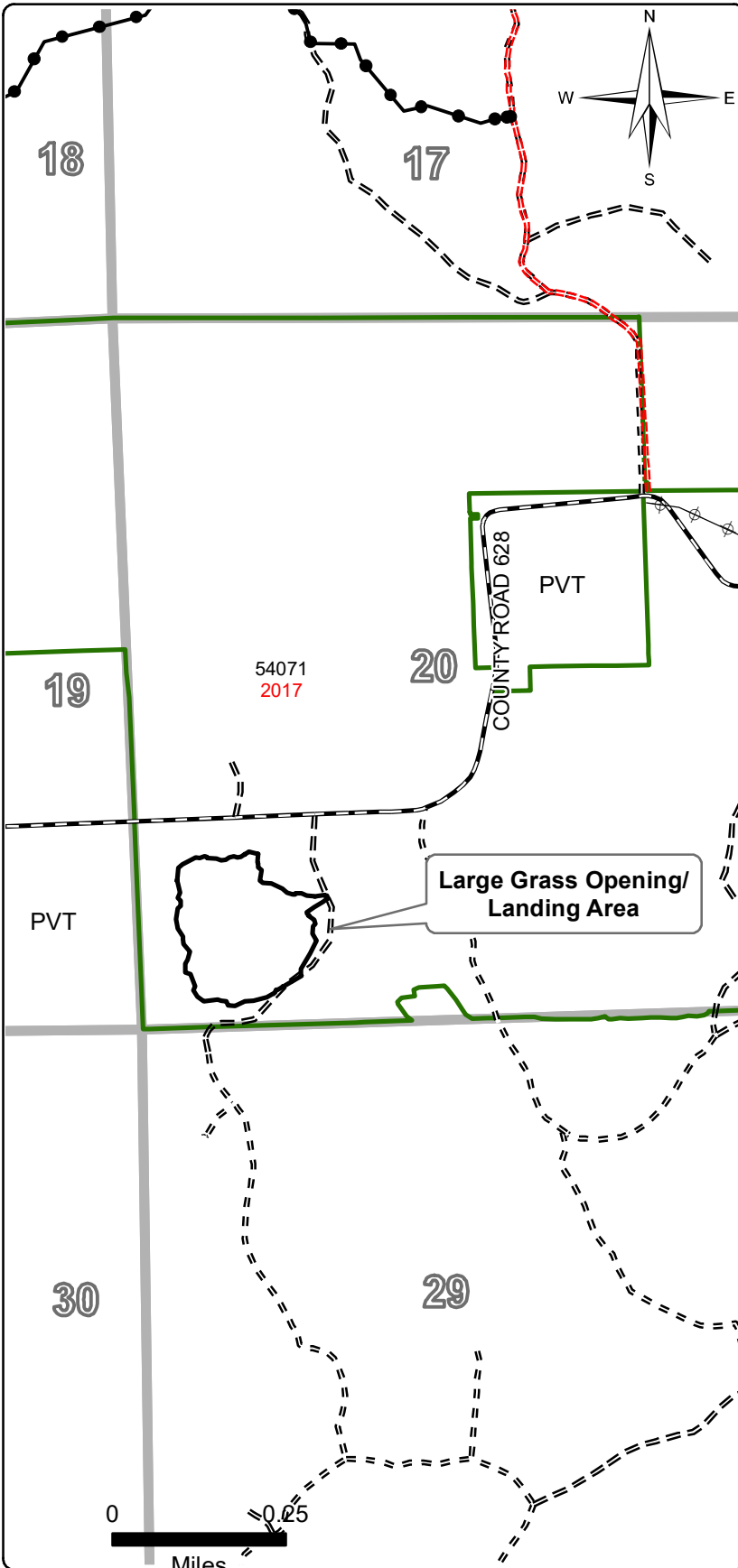

C54-1174

County	Town	Range	Subdivision	YOE	Compartment(s)	Stand(s)
Montmorency	32N	03E	Sec. 20- SWSW	2017	71	29



Cover Type Objective:	PLANTED RP	Acres:	21.2
Approved Methods:	Rollerchop, trench, spray, and plant RP per TMS specs. Plant small pockets of oak throughout treated area. Eradicate autumn olive as a follow-up, if it exists after regeneration surveys.		
Treatment Number(s):	54071029-Prep		
Timber Sale Number:	54-002-17-01		
Sale Admin Staff:	Coy		
Contract TCR Date:	On Active Sale- Cut Complete 3/9/21		
Comments:	Terrain is flat to rolling. Tops were chipped and stumps are low. Clearcut was complete 3/9/21. Pockets of tall deciduous saplings from sub-canopy that were not knocked down (about 2 acres). Could possibly knock down pockets with brush saws on foot vs using rollerchopper. Do not trench or plant through existing roads as mapped. Landing and access site using NE 2-Track.off CR 628 into a large grass opening.		

Proofing Comments	
Recreation:	None.
Water:	Greater than 300ft away.
HAL:	No hits w/in Rx area.
MNFI:	No confirmed hits in Rx area.
Other Comments:	This harvested area/stand was primarily Beech with high sub-canopy coverage of beech saplings before it was cut. Work with wildlife division and plant small pockets of oak throughout stand with or without fencing to increase stand diversity and composition of oak within the area. Eradicate autumn olive as a follow-up within this stand, if it exists after regeneration surveys.
54071029-Prep- 21.2 Acres	



Legend	
	C54-1174 Boundary
	Powerline
	DNR - Secondary Forest Road
	DNR - Forest Access Route
	County - Gravel Road
	County - Dirt Road (Seasonal)