



### TIMBER SALE MAP

This information provided by authority of Part 525, 1994 PA 451, as amended.

Sale Number <b>54-032-24</b>	Date 10/30/2024	
Scale 1:15,840	Page 1	Of 1

Forest Management Unit Atlanta Mgt Unit	County Cheboygan	Mapped By: TSP Cruised By: J. St. Pierre, TSP
--	---------------------	--

Township 36N	Range 01E	Section(s) and Subdivision(s) Sec. 11 SW,SE; Sec. 14 NENW,NWNE;
-----------------	--------------	---

Cover Type			
A = Aspen	J = Jack Pine	O = Oak	U = Upland Brush
B = Paper Birch	K = Rock	P = Lowland Poplar	UM = Upland Mix Forest
C = Cedar	L = Lowland Brush	Q = Mixed Swamp Conifer	V = Bog or Marsh
D = Treed Bog	LM = Lowland Mix Forest	R = Red Pine	W = White Pine
E = Swamp Hardwoods	M = Maple, Beech, Birch	S = Black Spruce	X = Non Stocked
F = Spruce/Fir	MC = Mixed Conifer	T = Tamarack	Y = Sand
G = Grass	MD = Mixed Deciduous	Z = Water	
H = Hemlock	N = Marsh		

Density	
0 = Non Stocked	5 = Pole Timber Medium
1 = Seedling Sapling Poor	6 = Pole Timber Well
2 = Seedling Sapling Medium	7 = Saw Timber Poor
3 = Seedling Sapling Well	8 = Saw Timber Medium
4 = Pole Timber Poor	9 = Saw Timber Well

PU #	Acres	PU #	Acres
1	20.5	5	32.7
2	32.6	6	36.4
3	34.3	7	18.3
4	20.7		

## Higgle Wiggle Red Pine

### 195.5 Acres

### Compartment 176

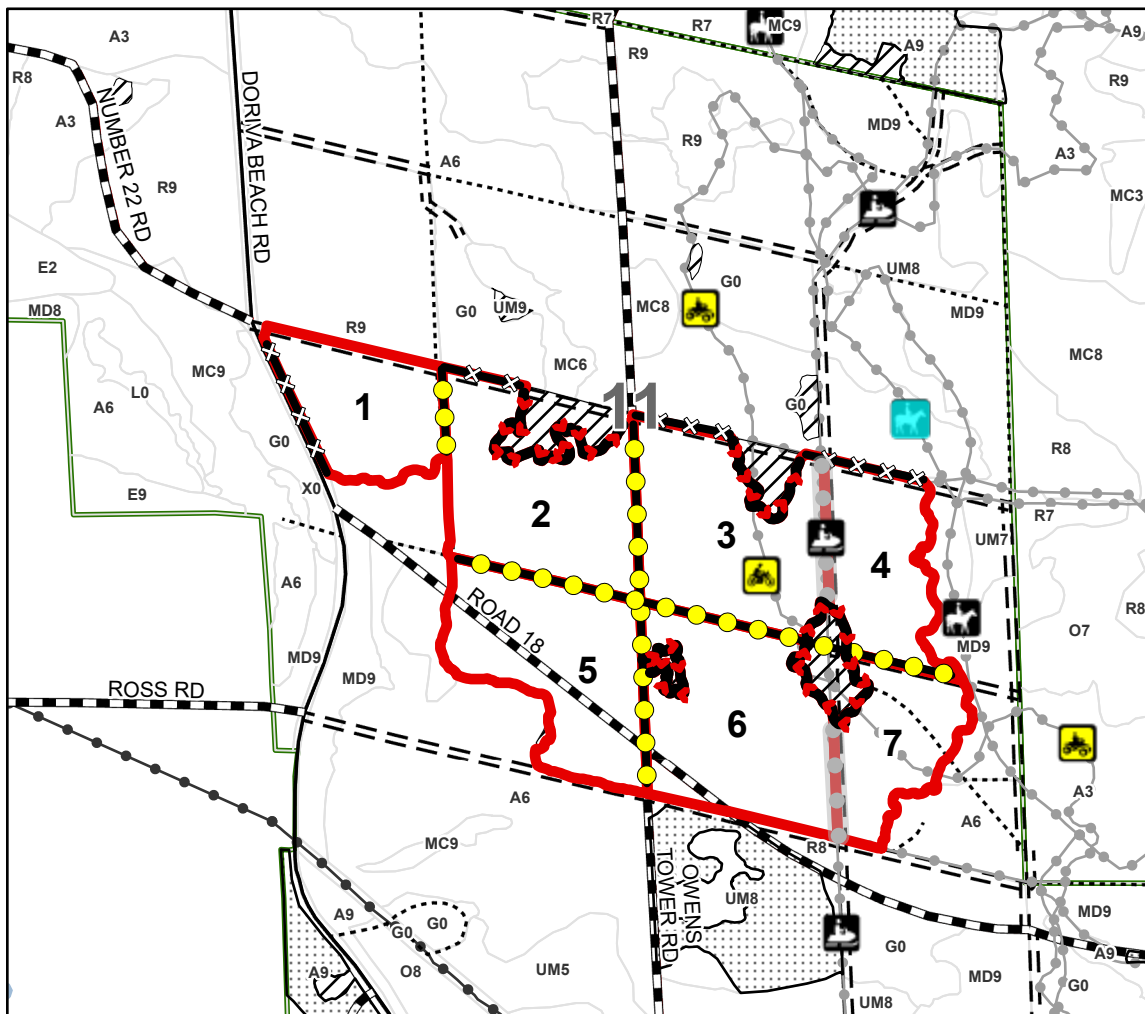
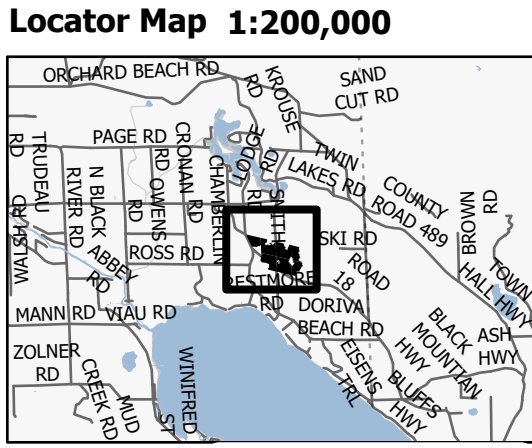

### Legend

- Sale Boundary (Red)
- ✗ Against State (Red X)
- Against State (Unpainted)
- Payment Unit (Yellow)
- Payment Unit (Unpainted)
- Stand
- Retention Areas
- Forest Access Route
- Administrative Access Only
- Paved Road
- Government Gravel/Dirt
- Recreational Trails
- Powerline

Use QR Code to open Map in App

