



TIMBER SALE MAP

This information provided by authority of Part 525, 1994 PA 451, as amended.

Sale Number	Year
54-020	21

Forest Management Unit Atlanta	County Alpena	Mapped By D. Parris	Date 08/28/2021	Page 1	of 1
Township 31N	Range 07E	Section(s) and Subdivision(s) Sec. 34 NENW, SWNE, SE	Scale 1:15,840		

Cover Type				Density	
A = Aspen	H = Hemlock	N = Marsh	U = Upland Brush	0 = Non Stocked	5 = Pole Timber Medium
B = Paper Birch	J = Jack Pine	O = Oak	UM = Upland Mixed	1 = Seedling Sapling Poor	6 = Pole Timber Well
C = Cedar	L = Lowland Brush	P = Lowland Poplar	V = Bog or Marsh	2 = Seedling Sapling Medium	7 = Saw Timber Poor
D = Treed Bog	LM = Lowland Mixed	Q = Mixed Swamp Conifer	W = White Pine	3 = Seedling Sapling Well	8 = Saw Timber Medium
E = Swamp Hdwoods	M = Mpl, Bch, Brch	R = Red Pine	X = Non Stocked	4 = Pole Timber Poor	9 = Saw Timber Well
F = Spruce Fir	MC = Mixed Conifer	S = Black Spruce	Z = Water		
G = Grass	MD = Mixed Deciduous	T = Tamarack			

PU	Acres	PU	Acres
1	3.0	5	10.0
2	14.8	6	12.5
3	20.4	7	9.7
4	12.2		

JC Island Mix
Compartment 105
82.6 Acres

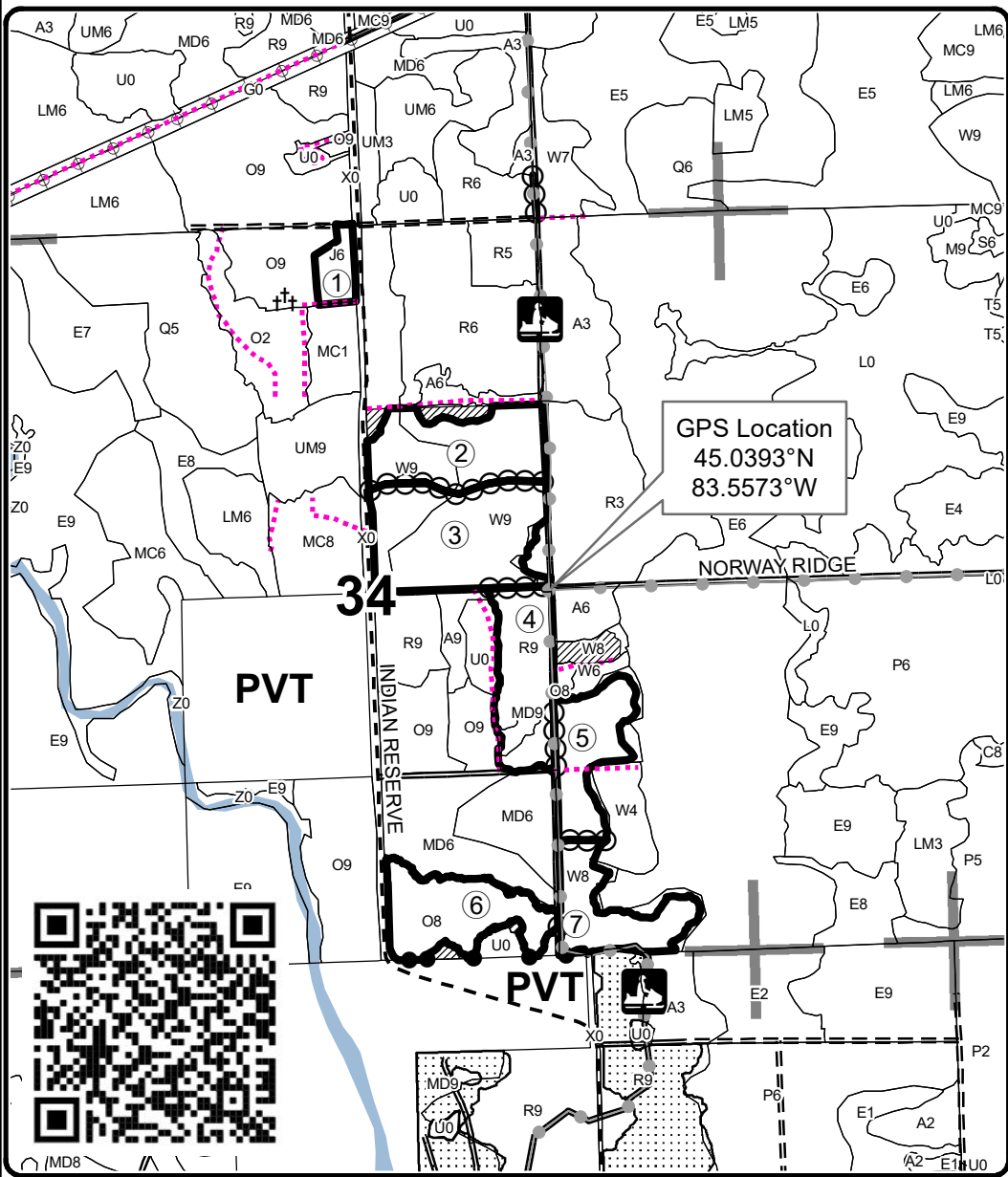
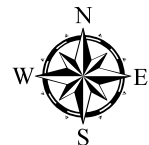

Legend

- Against State (Red)
- Payment Unit (Yellow)
- Private Line (Blue)
- Stand Boundaries
- ▨ Retention Area
- ▤ Nearby Timber Sales
- Payment Unit
- †† Cemetery
- Secondary Forest Road
- == Forest Access Route
- - Gravel Road
- ⋯ Temporary Management Access
- Recreational Trail
- ⊕ Powerline
- Lakes and Rivers
- Section Corners

Locator Map
1:150,000

