



TIMBER SALE MAP

This information provided by authority of Part 525, 1994 PA 451, as amended.

Forest Management Unit Atlanta		County Montmorency	Mapped By Natzke	Date 08/29/2023	Page 1	of 1
Township 31N	Range 02E	Section(s) and Subdivision(s) Sec 23 E1/2NW, W1/2NE, NWSE, N1/2SW		Scale 1:15,840		
Cover Type				Density		
A = Aspen	H = Hemlock	N = Marsh	U = Upland Brush	0 = Non Stocked	5 = Pole Timber Medium	
B = Paper Birch	J = Jack Pine	O = Oak	UM = Upland Mixed	1 = Seedling Sapling Poor	6 = Pole Timber Well	
C = Cedar	L = Lowland Brush	P = Lowland Poplar	V = Bog or Marsh	2 = Seedling Sapling Medium	7 = Saw Timber Poor	
D = Treed Bog	LM = Lowland Mixed	Q = Mixed Swamp Conifer	W = White Pine	3 = Seedling Sapling Well	8 = Saw Timber Medium	
E = Swamp Hdwoods	M = Mpl, Bch, Brch	R = Red Pine	X = Non Stocked	4 = Pole Timber Poor	9 = Saw Timber Well	
F = Spruce Fir	MC = Mixed Conifer	S = Black Spruce	Z = Water			
G = Grass	MD = Mixed Deciduous	T = Tamarack				

Kinzie Conversion Oak

Compartment 46

70.1 Acres

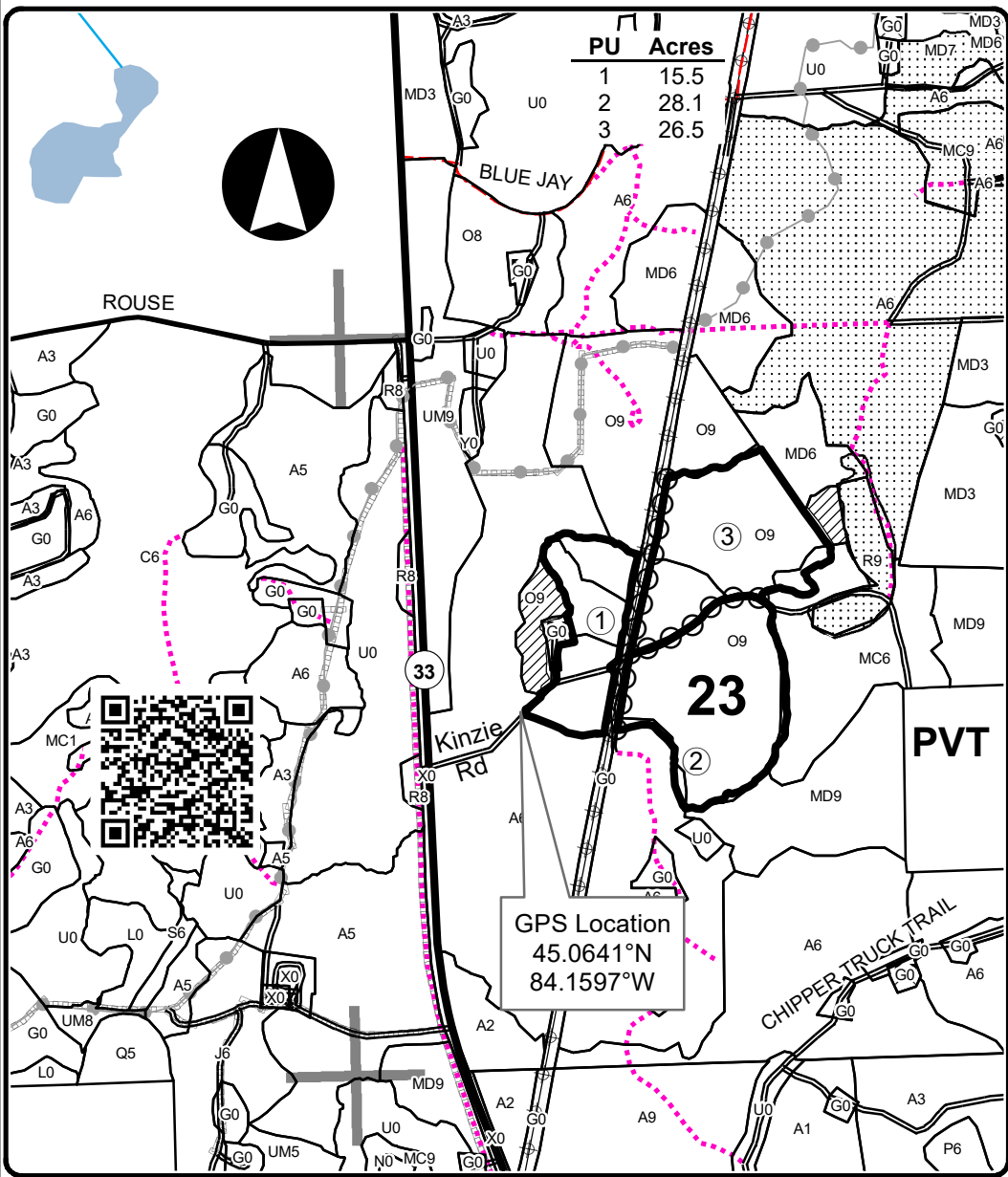

PU	Acres
1	15.5
2	28.1
3	26.5

Legend

- Against State (Red)
- Payment Unit (Yellow)
- Payment Unit
- Stand Boundaries
- Retention Area
- Nearby Timber Sales
- Pipeline
- Powerline
- Recreational Trail
- Highways
- Secondary Forest Road
- Paved Road
- County Road - Seasonal
- Temporary Management Access
- Perennial River
- Lakes and Rivers
- Section Corners

Locator Map
1:150,000

