



TIMBER SALE MAP

This information provided by authority of Part 525, 1994 PA 451, as amended.

Forest Management Unit Atlanta Management Unit		County Montmorency	Mapped By Natzke	Date 04/11/2021	Page 1	of 1
Township 32N	Range 03E	Section(s) and Subdivision(s) Sec. 19 SESW, SWSE; Sec. 30 E2NW, NWNE, S2NE, N2SW, N2SE		Scale 1:15,840		
Cover Type				Density		
A = Aspen	H = Hemlock	N = Marsh	U = Upland Brush	0 = Non Stocked	5 = Pole Timber Medium	
B = Paper Birch	J = Jack Pine	O = Oak	UM = Upland Mixed	1 = Seedling Sapling Poor	6 = Pole Timber Well	
C = Cedar	L = Lowland Brush	P = Lowland Poplar	V = Bog or Marsh	2 = Seedling Sapling Medium	7 = Saw Timber Poor	
D = Treed Bog	LM = Lowland Mixed	Q = Mixed Swamp Conifer	W = White Pine	3 = Seedling Sapling Well	8 = Saw Timber Medium	
E = Swamp Hdwoods	M = Mpl, Bch, Brch	R = Red Pine	X = Non Stocked	4 = Pole Timber Poor	9 = Saw Timber Well	
F = Spruce Fir	MC = Mixed Conifer	S = Black Spruce	Z = Water			
G = Grass	MD = Mixed Deciduous	T = Tamarack				

Long Haul Mix Compartment 72 93.0 Acres

Best access to
PU 2-8
is from the north

PU	Acres	PU	Acres
1	4.4	5	16.1
2	11.9	6	17.6
3	7.0	7	13.8
4	17.9	8	4.7

Locator Map 1:150,000

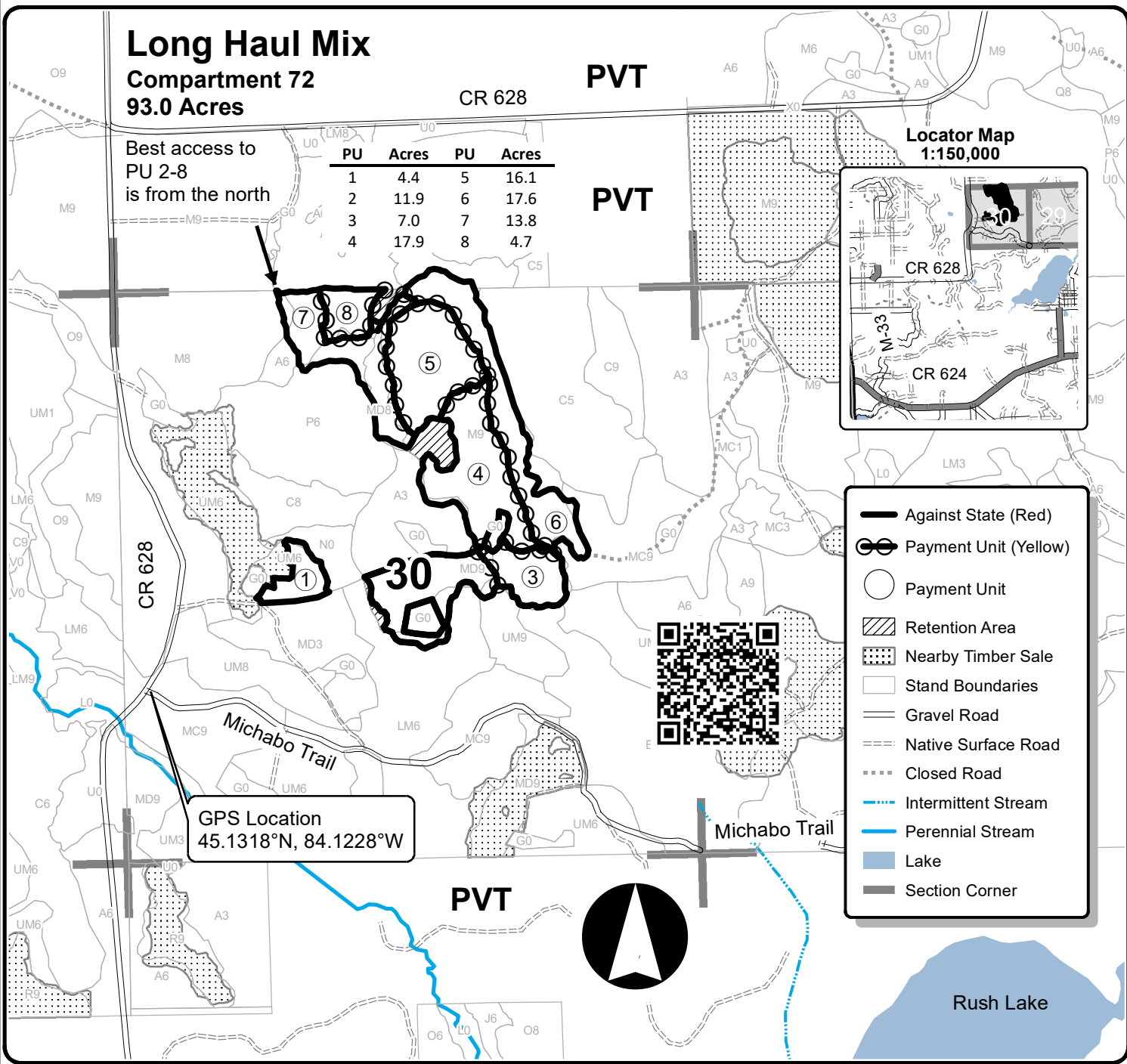
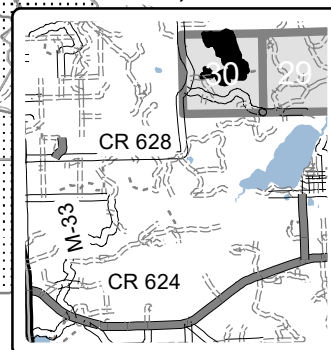

GPS Location
45.1318°N, 84.1228°W

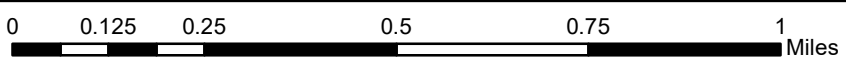

Rush Lake