



TIMBER SALE MAP

This information provided by authority of Part 525, 1994 PA 451, as amended.

Forest Management Unit Baraga		County Baraga	Mapped By Brodeur	Date 08/10/2020	Page 1	of 1
Township 50N	Range 35W	Section(s) and Subdivision(s) Section 12 - NE, NESE		Scale 1:15,840		
Cover Type				Density		
A = Aspen	H = Hemlock	N = Marsh	U = Upland Brush	0 = Non Stocked	5 = Pole Timber Medium	
B = Paper Birch	J = Jack Pine	O = Oak	UM = Upland Mixed	1 = Seedling Sapling Poor	6 = Pole Timber Well	
C = Cedar	L = Lowland Brush	P = Lowland Poplar	V = Bog or Marsh	2 = Seedling Sapling Medium	7 = Saw Timber Poor	
D = Treed Bog	LM = Lowland Mixed	Q = Mixed Swamp Conifer	W = White Pine	3 = Seedling Sapling Well	8 = Saw Timber Medium	
E = Swamp Hdwoods	M = Mpl, Bch, Brch	R = Red Pine	X = Non Stocked	4 = Pole Timber Poor	9 = Saw Timber Well	
F = Spruce Fir	MC = Mixed Conifer	S = Black Spruce	Z = Water			
G = Grass	MD = Mixed Deciduous	T = Tamarack				

GNA2 Cobra	
27.5 Acres	
Baraga County	
Compartment 5001	
UNIT	1
ACRES	27.5
Sawlogs MBF	
Red Maple	12.3
Sugar Maple	16.5
Yellow Birch	2.7
TOTAL	31.5
Pulpwood Cords	
Balsam Fir	8
Basswood	5
Mixed Hwd	274
Quaking Aspen	8
TOTAL	295

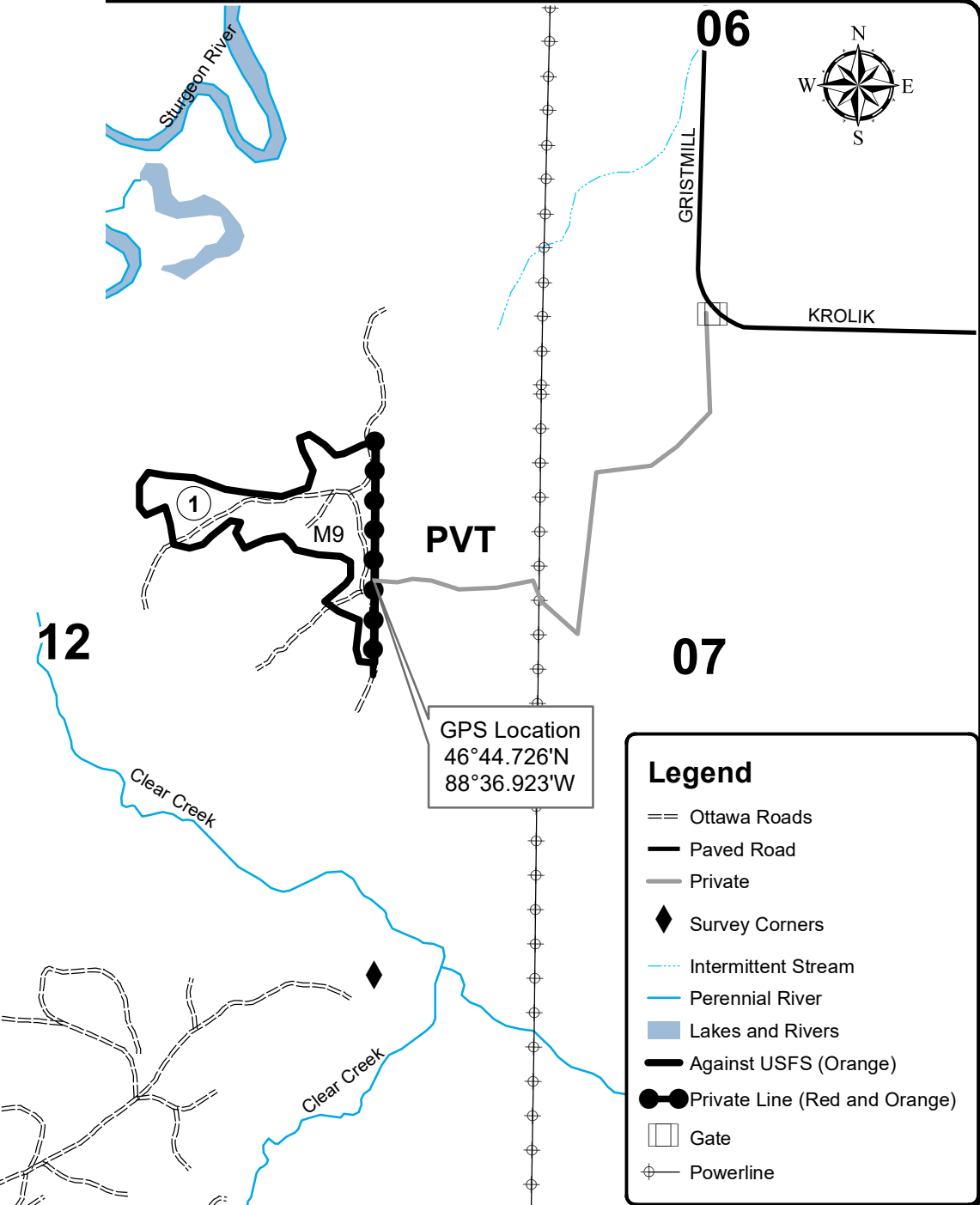

Legend	
==	Ottawa Roads
—	Paved Road
—	Private
◆	Survey Corners
---	Intermittent Stream
—	Perennial River
■	Lakes and Rivers
—	Against USFS (Orange)
●	Private Line (Red and Orange)
□	Gate
+	Powerline

