



TIMBER SALE MAP

This information provided by authority of Part 525, 1994 PA 451, as amended.

| | | |
|------------------|------------|----|
| Sale Number | Date | |
| 11-020-24 | 12/02/2024 | |
| Scale | Page | Of |
| 1:15,840 | 1 | 1 |

| | | |
|------------------------|---------------|--------------------------|
| Forest Management Unit | County | Mapped By: Ryan Mattila |
| Baraga Mgt Unit | Baraga | Cruised By: Baraga Staff |

| | | | |
|----------|-------|-------------------------------|-------------|
| Township | Range | Section(s) and Subdivision(s) | Sec. 20 NE; |
| 50N | 34W | | |

| Cover Type | | | |
|---------------------|-------------------------|-------------------------|------------------------|
| A = Aspen | J = Jack Pine | O = Oak | U = Upland Brush |
| B = Paper Birch | K = Rock | P = Lowland Poplar | UM = Upland Mix Forest |
| C = Cedar | L = Lowland Brush | Q = Mixed Swamp Conifer | V = Bog or Marsh |
| D = Treed Bog | LM = Lowland Mix Forest | R = Red Pine | W = White Pine |
| E = Swamp Hardwoods | M = Maple, Beech, Birch | S = Black Spruce | X = Non Stocked |
| F = Spruce/Fir | MC = Mixed Conifer | T = Tamarack | Y = Sand |
| G = Grass | MD = Mixed Deciduous | Z = Water | |
| H = Hemlock | N = Marsh | | |

| Density | |
|-----------------------------|------------------------|
| 0 = Non Stocked | 5 = Pole Timber Medium |
| 1 = Seedling Sapling Poor | 6 = Pole Timber Well |
| 2 = Seedling Sapling Medium | 7 = Saw Timber Poor |
| 3 = Seedling Sapling Well | 8 = Saw Timber Medium |
| 4 = Pole Timber Poor | 9 = Saw Timber Well |

Locator Map (1:200,000)

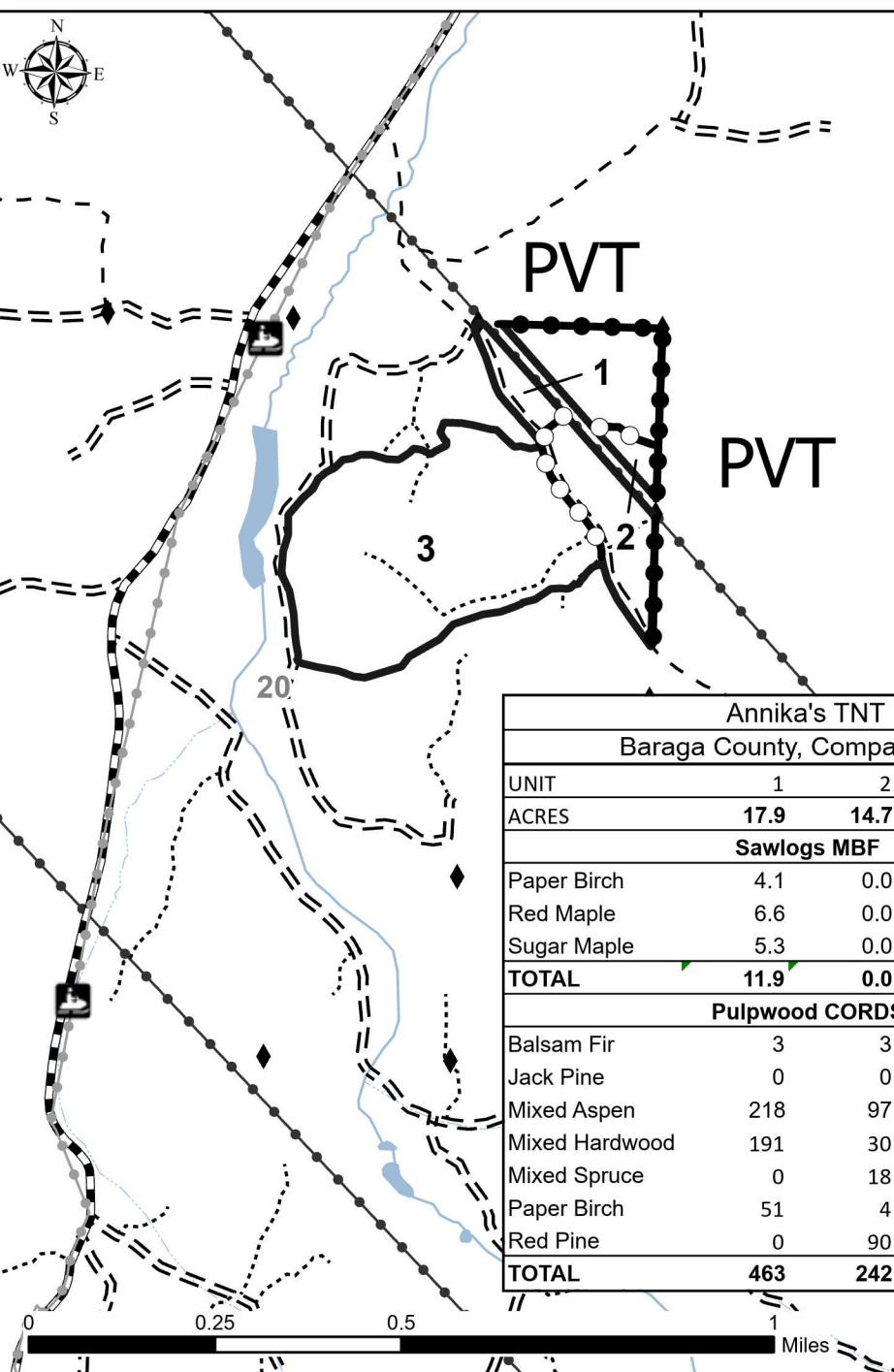
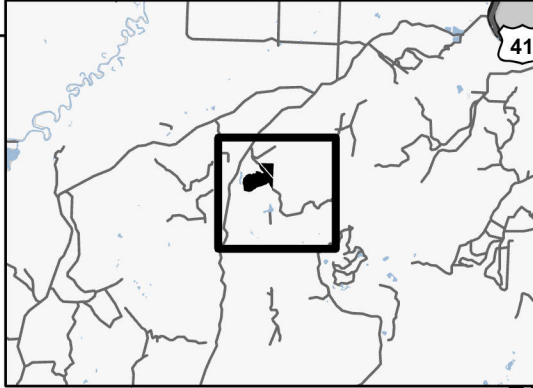

Legend

- Against State (Red)
- Payment Unit (Red)
- Private Line (Blue)
- Recreational Trail
- Powerline
- Primary Forest Road
- Forest Access Route
- Administrative Access Only
- Paved Road
- Government Gravel/Dirt
- Private Gravel/Dirt
- Survey Grade Corner

| Annika's TNT | | | | |
|------------------------------|-------------|------------|-------------|-------------|
| Baraga County, Compartment 6 | | | | |
| UNIT | 1 | 2 | 3 | TOTALS |
| ACRES | 17.9 | 14.7 | 61.1 | 93.7 |
| Sawlogs MBF | | | | |
| Paper Birch | 4.1 | 0.0 | 17.4 | 21.5 |
| Red Maple | 6.6 | 0.0 | 9.5 | 16.1 |
| Sugar Maple | 5.3 | 0.0 | 4.7 | 10.0 |
| TOTAL | 11.9 | 0.0 | 14.2 | 26.1 |
| Pulpwood CORDS | | | | |
| Balsam Fir | 3 | 3 | 19 | 25 |
| Jack Pine | 0 | 0 | 12 | 12 |
| Mixed Aspen | 218 | 97 | 1293 | 1608 |
| Mixed Hardwood | 191 | 30 | 704 | 925 |
| Mixed Spruce | 0 | 18 | 8 | 26 |
| Paper Birch | 51 | 4 | 181 | 236 |
| Red Pine | 0 | 90 | 0 | 90 |
| TOTAL | 463 | 242 | 2217 | 2922 |

Use QR Code to open Map in App

