



### TIMBER SALE MAP

This information provided by authority of Part 525, 1994 PA 451, as amended.

Sale Number <b>11-015-25</b>	Date <b>02/12/2025</b>	
Scale <b>1:15,840</b>	Page <b>1</b>	Of <b>1</b>

Forest Management Unit <b>Baraga Mgt Unit</b>	County <b>Houghton</b>	Mapped By: <b>Dorvinen</b>
		Cruised By: <b>Dorvinen, Hansen</b>

Township <b>52N</b>	Range <b>36W</b>	Section(s) and Subdivision(s) <b>Sec. 20 NW,N1/2SW,SWSW;</b>
------------------------	---------------------	--

Cover Type			
A = Aspen	J = Jack Pine	O = Oak	U = Upland Brush
B = Paper Birch	K = Rock	P = Lowland Poplar	UM = Upland Mix Forest
C = Cedar	L = Lowland Brush	Q = Mixed Swamp Conifer	V = Bog or Marsh
D = Treed Bog	LM = Lowland Mix Forest	R = Red Pine	W = White Pine
E = Swamp Hardwoods	M = Maple, Beech, Birch	S = Black Spruce	X = Non Stocked
F = Spruce/Fir	MC = Mixed Conifer	T = Tamarack	Y = Sand
G = Grass	MD = Mixed Deciduous	Z = Water	
H = Hemlock	N = Marsh		

Density	
0 = Non Stocked	5 = Pole Timber Medium
1 = Seedling Sapling Poor	6 = Pole Timber Well
2 = Seedling Sapling Medium	7 = Saw Timber Poor
3 = Seedling Sapling Well	8 = Saw Timber Medium
4 = Pole Timber Poor	9 = Saw Timber Well

### Locator Map 1:200,000

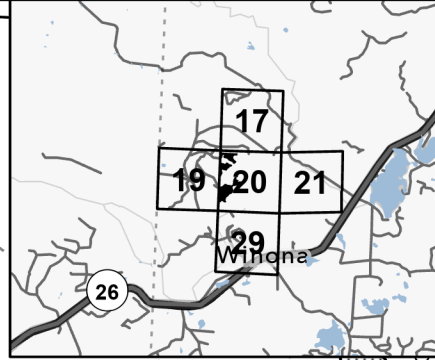

### Happy Days

Houghton County, Compartment 56

UNIT	1	2	TOTALS
ACRES	<b>37.4</b>	<b>43.5</b>	<b>80.9</b>

### Sawlogs MBF

Basswood	21.2	3.4	<b>24.6</b>
Red Maple	25.1	5.5	<b>30.6</b>
Sugar Maple	17.3	2.6	<b>19.9</b>
Yellow Birch	2.2	5.4	<b>7.6</b>
White Ash	0.0	1.5	<b>1.5</b>
<b>TOTAL</b>	<b>65.8</b>	<b>18.4</b>	<b>84.2</b>

### Pulpwood CORDS

Basswood	51	32	<b>83</b>
Mixed Hardwood	562	392	<b>954</b>
Balsam Fir	15	29	<b>44</b>
Mixed Aspen	0	273	<b>273</b>
Mixed Spruce	0	31	<b>31</b>
<b>TOTAL</b>	<b>628</b>	<b>453</b>	<b>1385</b>

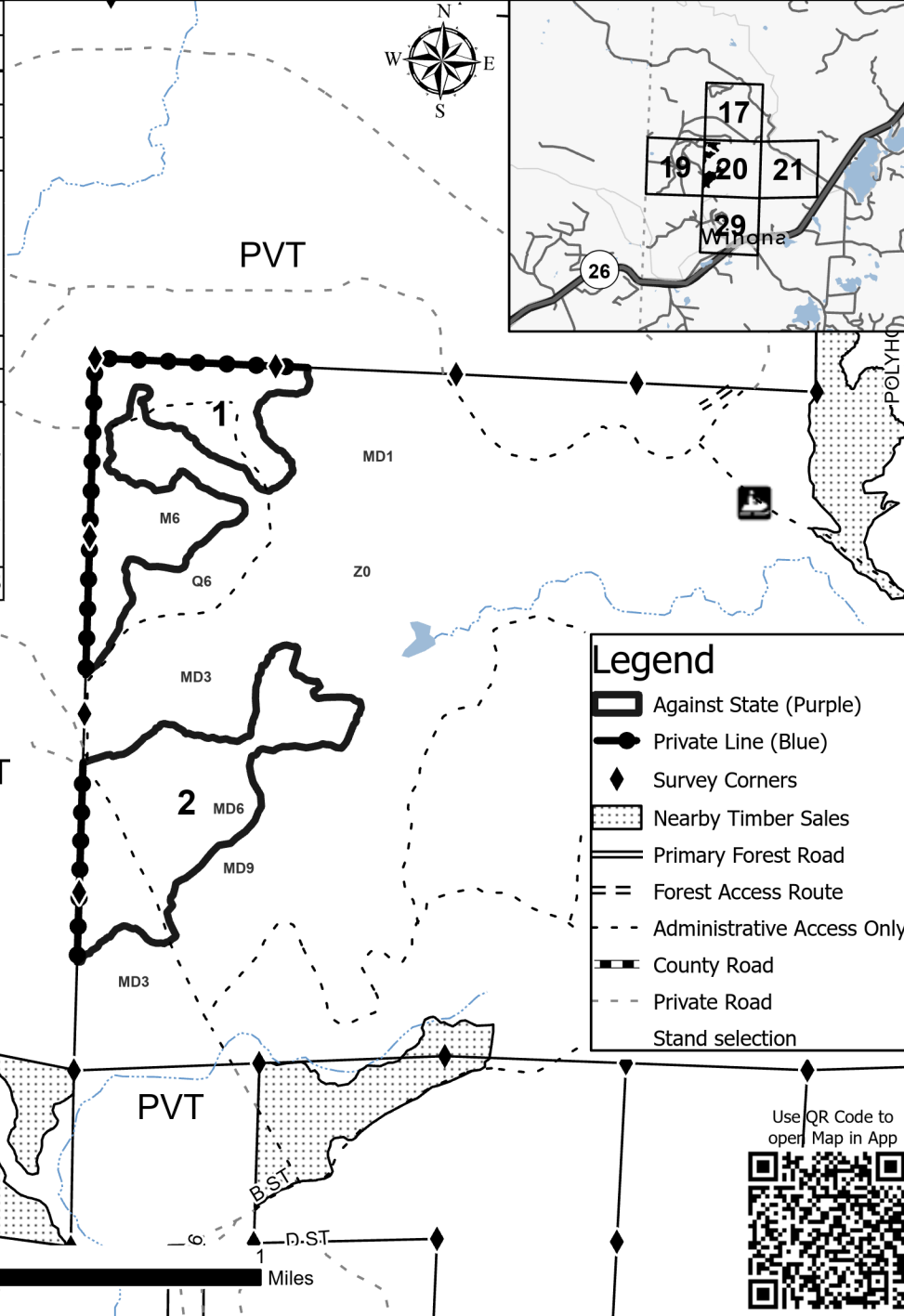

### Legend

- Against State (Purple)
- Private Line (Blue)
- Survey Corners
- Nearby Timber Sales
- Primary Forest Road
- Forest Access Route
- Administrative Access Only
- County Road
- Private Road
- Stand selection

Use QR Code to open Map in App

