



TIMBER SALE MAP

This information provided by authority of Part 525, 1994 PA 451, as amended.

Sale Number 29	Date 09/25/2024	
Scale 1:10,000	Page 1	Of 1

Forest Management Unit Cadillac	County Missaukee	Mapped By: Krugh
		Cruised By: Contractor

Township 24N	Range 05W	Section(s) and Subdivision(s) 1 W1/2NW,E1/2SW,SWSE 2 N1/2NE,SENE
------------------------	---------------------	--

Cover Type			
A = Aspen	J = Jack Pine	O = Oak	U = Upland Brush
B = Paper Birch	K = Rock	P = Lowland Poplar	UM = Upland Mix Forest
C = Cedar	L = Lowland Brush	Q = Mixed Swamp Conifer	V = Bog or Marsh
D = Treed Bog	LM = Lowland Mix Forest	R = Red Pine	W = White Pine
E = Swamp Hardwoods	M = Maple, Beech, Birch	S = Black Spruce	X = Non Stocked
F = Spruce/Fir	MC = Mixed Conifer	T = Tamarack	Y = Sand
G = Grass	MD = Mixed Deciduous	Z = Water	
H = Hemlock	N = Marsh		

Density	
0 = Non Stocked	5 = Pole Timber Medium
1 = Seedling Sapling Poor	6 = Pole Timber Well
2 = Seedling Sapling Medium	7 = Saw Timber Poor
3 = Seedling Sapling Well	8 = Saw Timber Medium
4 = Pole Timber Poor	9 = Saw Timber Well

Thinn Mint Pine

Acres 49.8

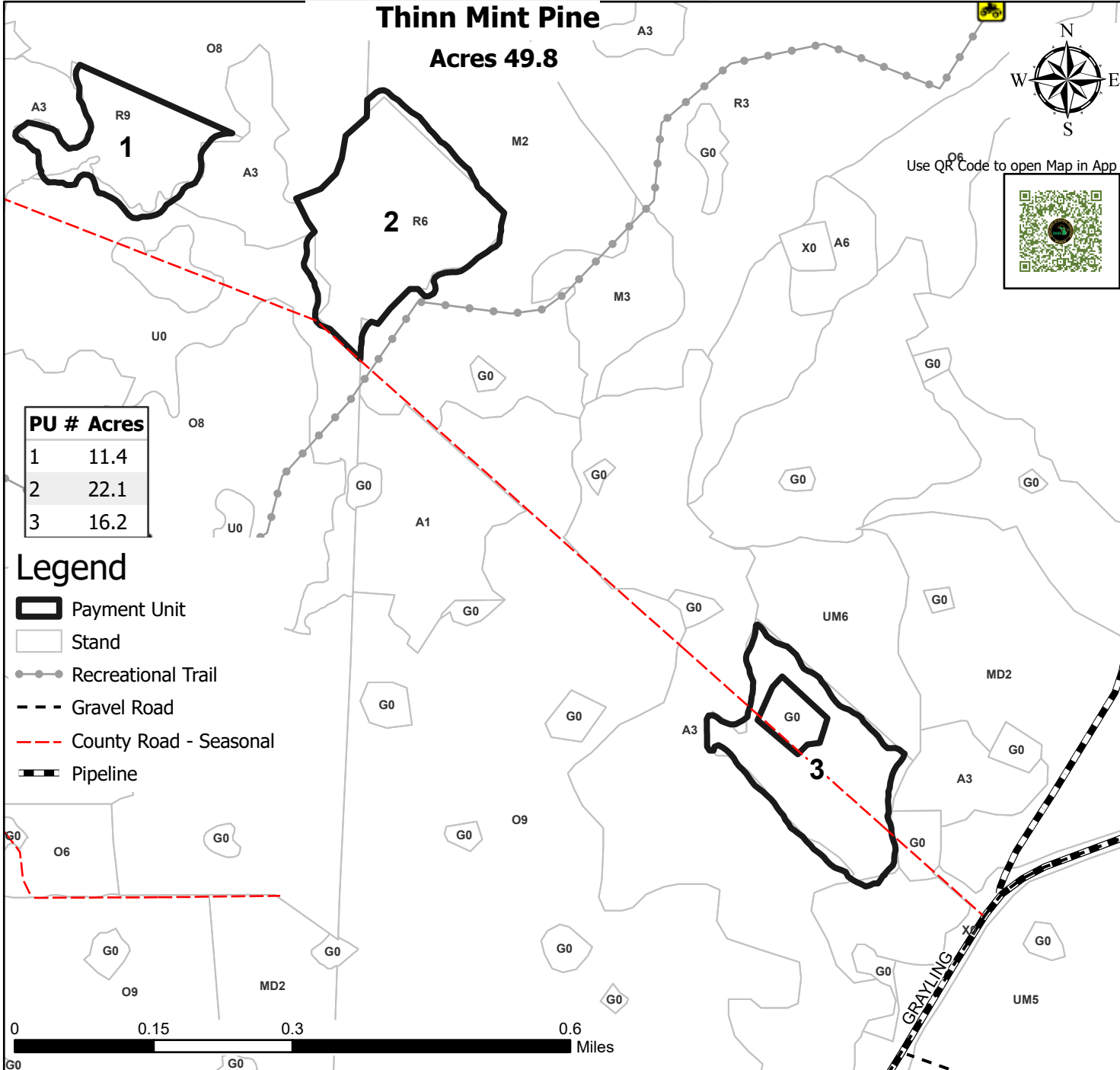

PU #	Acres
1	11.4
2	22.1
3	16.2

Legend

- Payment Unit
- Stand
- Recreational Trail
- Gravel Road
- County Road - Seasonal
- Pipeline