

**TIMBER SALE MAP**

This information provided by authority of Part 525, 1994 PA 451, as amended.

Sale Number

63-017-25

Date

08/25/2025

Forest Management Unit

Cadillac Mgt Unit

County

Missaukee

Mapped By: Adamczyk

Cruised By: Adamczyk

Scale

1:10,000

Page

1

Of

1

Township

22N

Range

07W

Section(s) and

Subdivision(s) Sec. 2 S1/2SW,NWSE;

Cover Type

A = Aspen	J = Jack Pine	O = Oak	U = Upland Brush
B = Paper Birch	K = Rock	P = Lowland Poplar	UM = Upland Mix Forest
C = Cedar	L = Lowland Brush	Q = Mixed Swamp Conifer	V = Bog or Marsh
D = Treed Bog	LM = Lowland Mix Forest	R = Red Pine	W = White Pine
E = Swamp Hardwoods	M = Maple, Beech, Birch	S = Black Spruce	X = Non Stocked
F = Spruce/Fir	MC = Mixed Conifer	T = Tamarack	Y = Sand
G = Grass	MD = Mixed Deciduous		Z = Water
H = Hemlock	N = Marsh		

Density

0 = Non Stocked	5 = Pole Timber Medium
1 = Seedling Sapling Poor	6 = Pole Timber Well
2 = Seedling Sapling Medium	7 = Saw Timber Poor
3 = Seedling Sapling Well	8 = Saw Timber Medium
4 = Pole Timber Poor	9 = Saw Timber Well

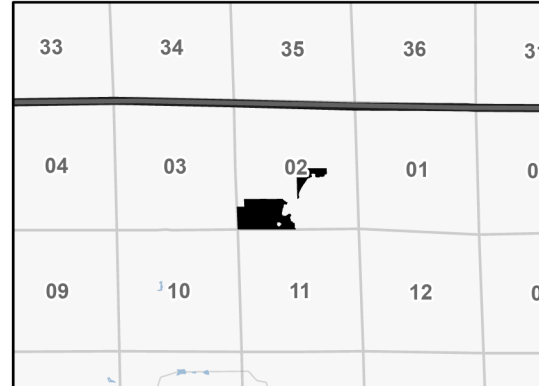
Locator Map 1:100,000**Payment Unit Acres**

1	18.7
2	11.4
3	34.1
4	15.7

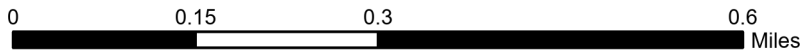
Ask MI Turkey**79.9 Acres****Legend**

- Payment Unit
- Private Line (Blue)
- Payment Unit (Yellow)
- Retention Areas
- Forest Access Route
- Administrative Access Only
- Paved Road
- Field Grade Corner

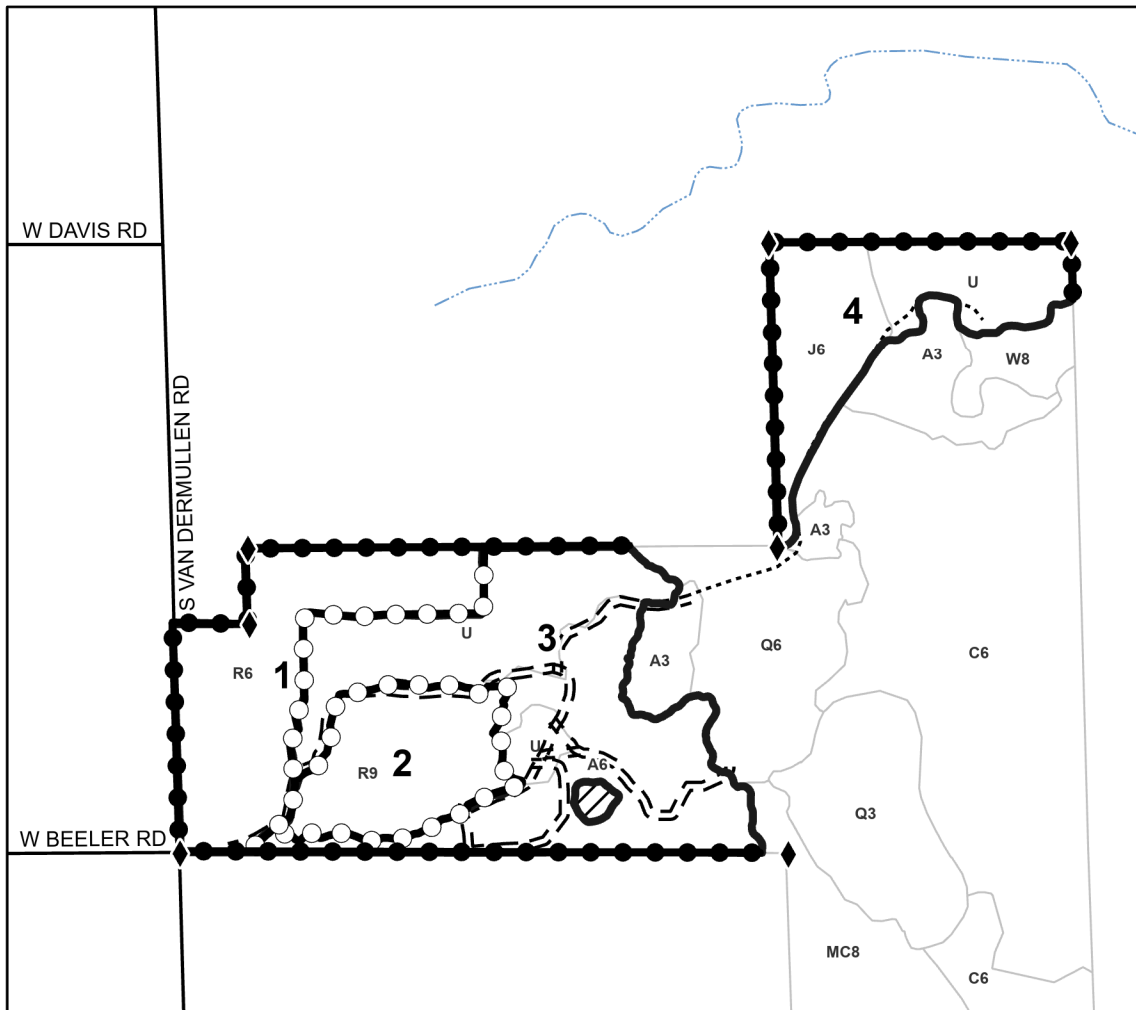
Use QR Code to
open Map in App