



# TIMBER SALE MAP

This information provided by authority of Part 525, 1994 PA 451, as amended.

Forest Management Unit Crystal Falls	County Dickinson	Mapped By Jacob Siler	Date 03/20/2020	Page 1	of 1
Township 41N	Range 27/28W	Section(s) and Subdivision(s) Section: 30, 31, 25 and 36	Scale 1:15,840		

Cover Type				Density	
A = Aspen	H = Hemlock	N = Marsh	U = Upland Brush	0 = Non Stocked	5 = Pole Timber Medium
B = Paper Birch	J = Jack Pine	O = Oak	UM = Upland Mixed	1 = Seedling Sapling Poor	6 = Pole Timber Well
C = Cedar	L = Lowland Brush	P = Lowland Poplar	V = Bog or Marsh	2 = Seedling Sapling Medium	7 = Saw Timber Poor
D = Tread Bog	LM = Lowland Mixed	Q = Mixed Swamp Conifer	W = White Pine	3 = Seedling Sapling Well	8 = Saw Timber Medium
E = Swamp Hdwoods	M = Mpl, Bch, Brch	R = Red Pine	X = Non Stocked	4 = Pole Timber Poor	9 = Saw Timber Well
F = Spruce Fir	MC = Mixed Conifer	S = Black Spruce	Z = Water		
G = Grass	MD = Mixed Deciduous	T = Tamarack			

1: 19.7	6: 8.4	11: 3.3	16: 6.8
2: 14.6	7: 7.0	12: 18.7	17: 4.1
3: 13.7	8: 2.5	13: 9.8	18: 5.8
4: 11.3	9: 6.7	14: 8.7	
5: 8.9	10: 4.8	15: 4.3	

## Bug Bungee

### Compartment 90

#### 161.6 Acres

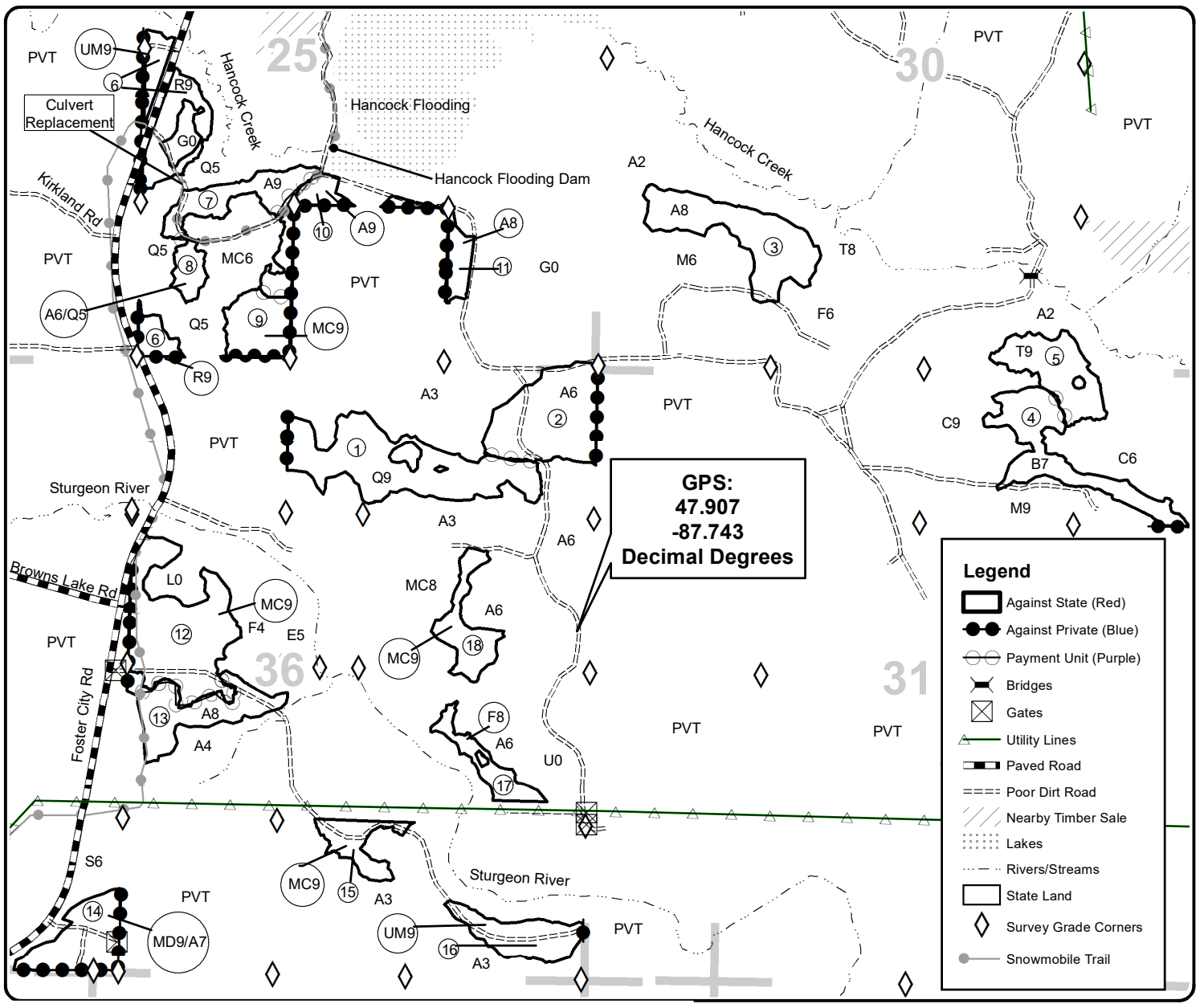

**GPS:**  
47.907  
-87.743  
Decimal Degrees

**Legend**

- Against State (Red)
- Against Private (Blue)
- Payment Unit (Purple)
- Bridges
- Gates
- Utility Lines
- Paved Road
- Poor Dirt Road
- Nearby Timber Sale
- Lakes
- Rivers/Streams
- State Land
- Survey Grade Corners
- Snowmobile Trail

