



# TIMBER SALE MAP

This information provided by authority of Part 525, 1994 PA 451, as amended.

Forest Management Unit Escanaba Management Unit	County Menominee County	Mapped By Beaudo	Date 9/20/2017	Page 1	of 1
Township 37N	Range 28W	Section(s) and Subdivision(s) Sec 9 - NESE, NWSE, SESE, SWSE; Sec 10 - NENE, NENW, NESE, NWNE, NWSW, SENE, SENW, SESE, SWNE, SWNW, SWSW; Sec 15 - NWNW; Sec 16 - NWNE	Scale 1:15,840		

Cover Type				Density	
A = Aspen	H = Hemlock	N = Marsh	U = Upland Brush	0 = Non Stocked	5 = Pole Timber Medium
B = Paper Birch	J = Jack Pine	O = Oak	UM = Upland Mixed	1 = Seedling Sapling Poor	6 = Pole Timber Well
C = Cedar	L = Lowland Brush	P = Lowland Poplar	V = Bog or Marsh	2 = Seedling Sapling Medium	7 = Saw Timber Poor
D = Tread Bog	LM = Lowland Mixed	Q = Mixed Swamp Conifer	W = White Pine	3 = Seedling Sapling Well	8 = Saw Timber Medium
E = Swamp Hdwoods	M = Mpl, Bch, Brch	R = Red Pine	X = Non Stocked	4 = Pole Timber Poor	9 = Saw Timber Well
F = Spruce Fir	MC = Mixed Conifer	S = Black Spruce	Z = Water		
G = Grass	MD = Mixed Deciduous	T = Tamarack			

PU	Acres	PU	Acres
1	27.1	7	7.6
2	36.2	8	4.1
3	14.0	9	10.5
4	16.9	10	18.2
5	28.0	11	12.5
6	20.3		

**Pile of Bones SBW**  
 Compartment 7  
 195.4 Acres

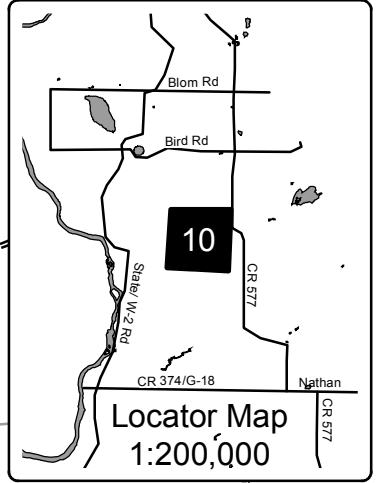

**Legend**

- Against State (Red)
- Payment Unit (Yellow)
- Private Line (Blue)
- Section Corners
- 10 Section Number
- Paved Roads
- Gravel Roads
- == Poor Dirt Roads
- Closed Roads
- State Land Boundary
- ① Payment Unit
- ⊠ Retention Patch
- ~ Creek/Seasonal Drain

