



TIMBER SALE MAP

This information provided by authority of Part 525, 1994 PA 451, as amended.

Forest Management Unit Escanaba		County Delta	Mapped By Racine	Date 9/22/2017	Page 1	of 1
Township 41N	Range 24W	Section(s) and Subdivision(s) 10) E1/2SW, SWSW 16) NE1/4, W1/2NW, NENW W1/2SW, SESW, NESE 17) SENE, NESE 9) SWSE, SESW			Scale 1:15,840	

Cover Type

A = Aspen	H = Hemlock	N = Marsh	U = Upland Brush
B = Paper Birch	J = Jack Pine	O = Oak	UM = Upland Mixed
C = Cedar	L = Lowland Brush	P = Lowland Poplar	V = Bog or Marsh
D = Treed Bog	LM = Lowland Mixed	Q = Mixed Swamp Conifer	W = White Pine
E = Swamp Hdwoods	M = Mpl, Bch, Brch	R = Red Pine	X = Non Stocked
F = Spruce Fir	MC = Mixed Conifer	S = Black Spruce	Z = Water
G = Grass	MD = Mixed Deciduous	T = Tamarack	

Density

0 = Non Stocked	5 = Pole Timber Medium
1 = Seedling Sapling Poor	6 = Pole Timber Well
2 = Seedling Sapling Medium	7 = Saw Timber Poor
3 = Seedling Sapling Well	8 = Saw Timber Medium
4 = Pole Timber Poor	9 = Saw Timber Well

PU	Acres	PU	Acres
1	7.8	5	10.8
2	28	6	13.9
3	34.7	7	4.7
4	17.3	8	68.1

426 Split
Compartment 85
185.3 Acres

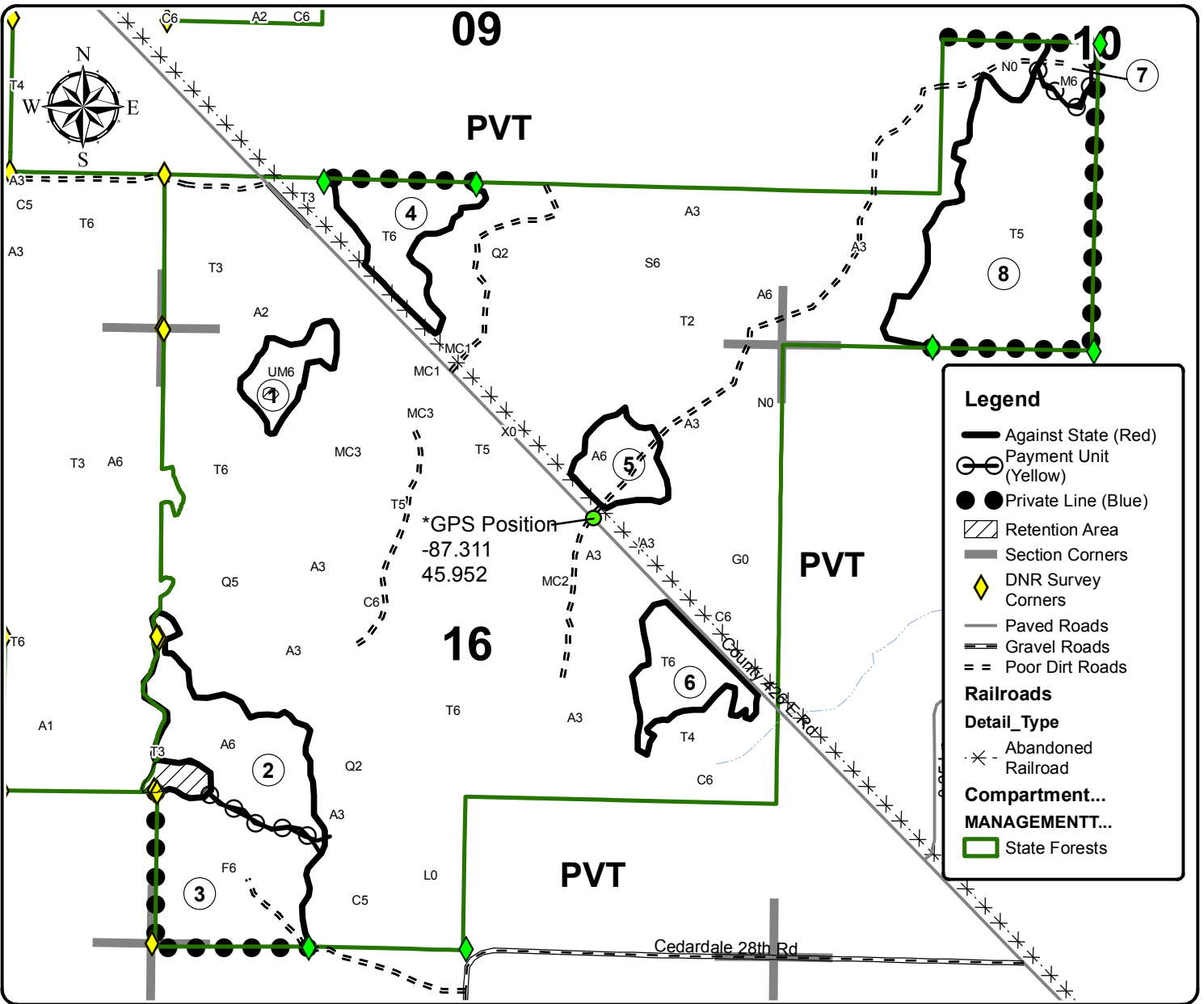

Legend

- Against State (Red)
- Payment Unit (Yellow)
- Private Line (Blue)
- Retention Area
- Section Corners
- Paved Roads
- Gravel Roads
- Poor Dirt Roads
- Railroads**
- Detail_Type**
- Abandoned Railroad
- Compartment...**
- MANAGEMENTT...**
- State Forests

