



# TIMBER SALE MAP

This information provided by authority of Part 525, 1994 PA 451, as amended.

Forest Management Unit Escanaba Management Unit		County Menominee County	Mapped By Beaudo	Date 7/26/2018	Page 1	of 1
Township 36N	Range 25W	Section(s) and Subdivision(s) Sec 24 - SENW, N1/2NE; Sec 25 - N1/2SW, NW1/4, NWNE.		Scale 1:15,840		
<b>Cover Type</b>			<b>Density</b>			
A = Aspen	H = Hemlock	N = Marsh	U = Upland Brush	0 = Non Stocked	5 = Pole Timber Medium	
B = Paper Birch	J = Jack Pine	O = Oak	UM = Upland Mixed	1 = Seedling Sapling Poor	6 = Pole Timber Well	
C = Cedar	L = Lowland Brush	P = Lowland Poplar	V = Bog or Marsh	2 = Seedling Sapling Medium	7 = Saw Timber Poor	
D = Treed Bog	LM = Lowland Mixed	Q = Mixed Swamp Conifer	W = White Pine	3 = Seedling Sapling Well	8 = Saw Timber Medium	
E = Swamp Hdwoods	M = Mpl, Bch, Brch	R = Red Pine	X = Non Stocked	4 = Pole Timber Poor	9 = Saw Timber Well	
F = Spruce Fir	MC = Mixed Conifer	S = Black Spruce	Z = Water			
G = Grass	MD = Mixed Deciduous	T = Tamarack				

## Deer Creek Maple Compartment 43 171.0 Acres



PU	Acres	PU	Acres
1	15.8	6	21.1
2	6.1	7	15.6
3	16.9	8	9.4
4	23.0	9	15.6
5	30.0	10	17.5

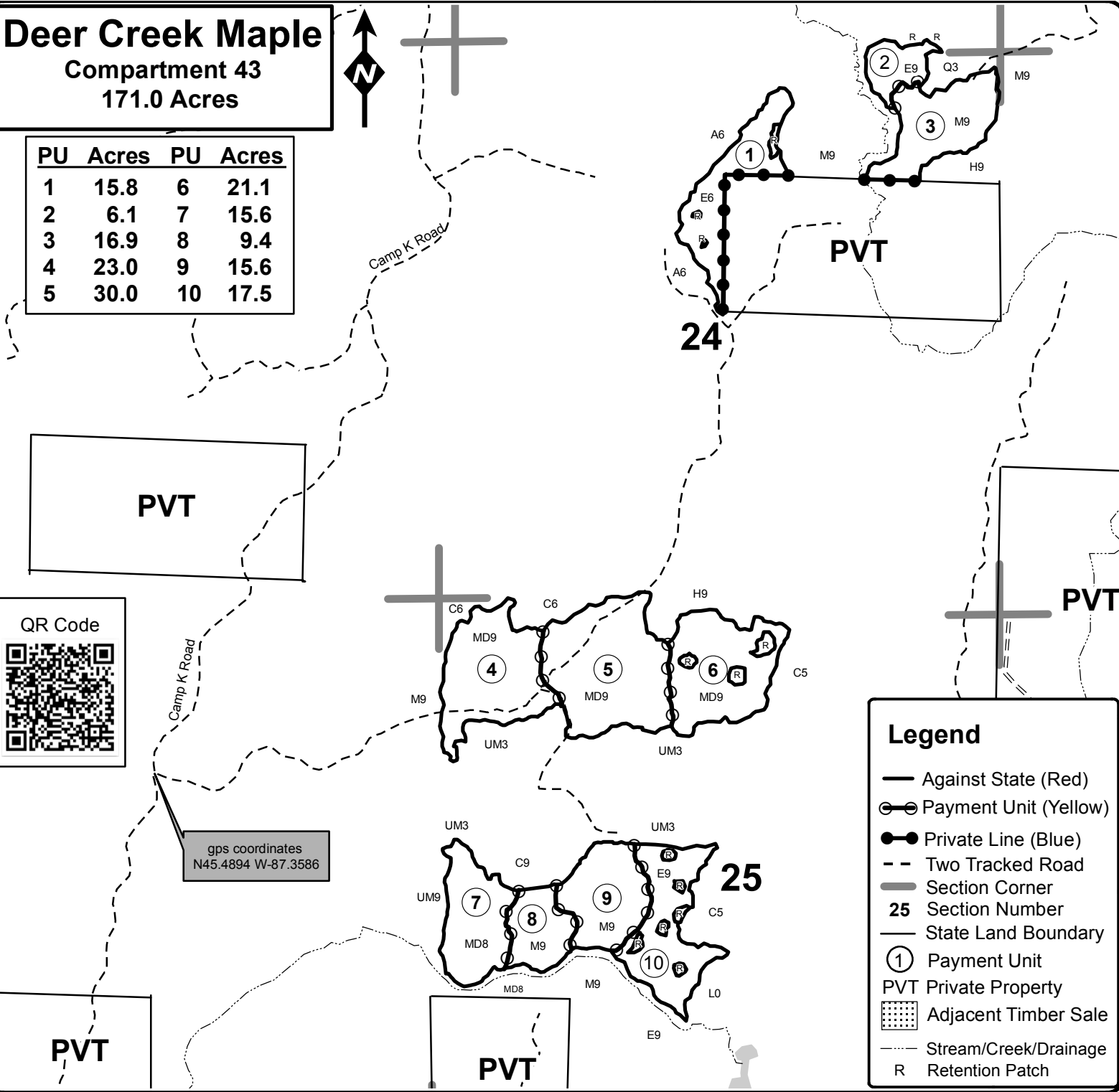

gps coordinates  
N45.4894 W-87.3586

### Legend

- Against State (Red)
- Payment Unit (Yellow)
- Private Line (Blue)
- - Two Tracked Road
- Section Corner
- 25 Section Number
- State Land Boundary
- ① Payment Unit
- PVT Private Property
- ▨ Adjacent Timber Sale
- Stream/Creek/Drainage
- R Retention Patch

