



TIMBER SALE MAP

This information provided by authority of Part 525, 1994 PA 451, as amended.

Forest Management Unit Escanaba		County Delta	Mapped By Urlich	Date 09/03/2020	Page 1	of 1
Township 41N	Range 22W	Section(s) and Subdivision(s) S1/2SW,SWSE Sec22 W1/2NW,W1/2SW Sec26 NE,S1/2SW,SE Sec27 NWNW Sec34	Cruised By Urlich, Racine	Scale 1:15,840		

Cover Type

A = Aspen	H = Hemlock	N = Marsh	U = Upland Brush
B = Paper Birch	J = Jack Pine	O = Oak	UM = Upland Mixed
C = Cedar	L = Lowland Brush	P = Lowland Poplar	V = Bog or Marsh
D = Treed Bog	LM = Lowland Mixed	Q = Mixed Swamp Conifer	W = White Pine
E = Swamp Hdwoods	M = Mpl, Bch, Brch	R = Red Pine	X = Non Stocked
F = Spruce Fir	MC = Mixed Conifer	S = Black Spruce	Z = Water
G = Grass	MD = Mixed Deciduous	T = Tamarack	

Density

0 = Non Stocked	5 = Pole Timber Medium
1 = Seedling Sapling Poor	6 = Pole Timber Well
2 = Seedling Sapling Medium	7 = Saw Timber Poor
3 = Seedling Sapling Well	8 = Saw Timber Medium
4 = Pole Timber Poor	9 = Saw Timber Well

South of Days

Compartment 106

281.5 Acres

PU	Acres	PU	Acres	PU	Acres	PU	Acres
1	14	6	38.8	11	15.4	16	4.2
2	2.6	7	13.5	12	38.1	17	3.2
3	8.4	8	3.7	13	25.2	18	2.2
4	26.8	9	41.5	14	14.7		
5	12.7	10	13.6	15	2.9		

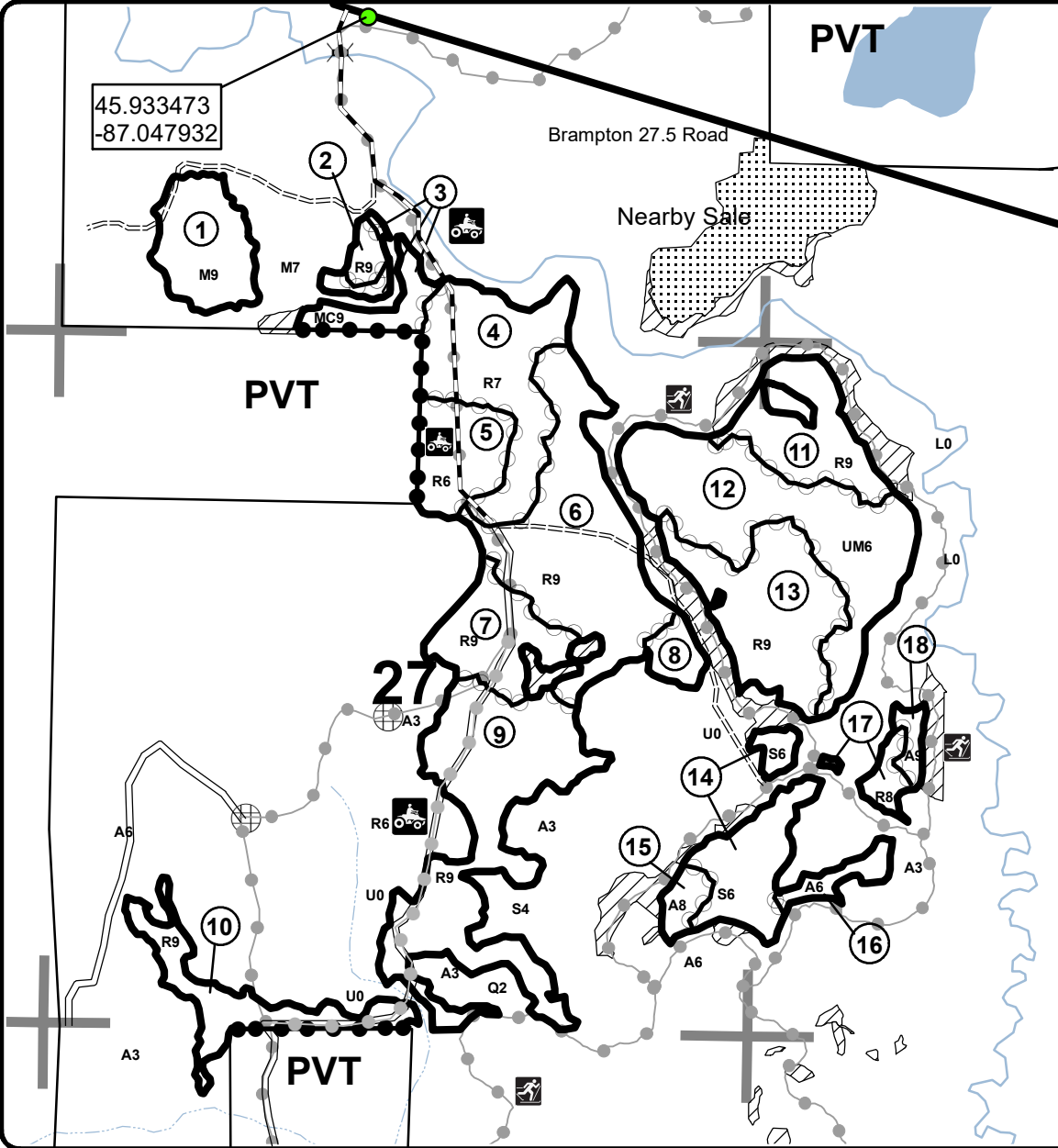

Legend

- Recreational Trails
- Highway
- Primary Forest Road
- Road
- Secondary Forest Road
- Forest Access Route
- Paved Road
- Gravel Road
- County Road - Seasonal
- Private
- DNR - Management Access
- Temporary Management Access
- Retention Area
- Against State (Red)
- Payment Unit (Yellow)
- Private Line (Blue)
- Section Corners

