



TIMBER SALE MAP

This information provided by authority of Part 525, 1994 PA 451, as amended.

Forest Management Unit Escanaba Management Unit		County Menominee County	Mapped By Beaudo	Date 8/19/2020	Page 1	of 1
Township 37N	Range 28W	Section(s) and Subdivision(s) Sec 26 - SWNW, SW, NWSE; Sec 27 - NWNE, S1/2NE, NESE.		Scale 1:15,840		

Cover Type				Density	
A = Aspen	H = Hemlock	N = Marsh	U = Upland Brush	0 = Non Stocked	5 = Pole Timber Medium
B = Paper Birch	J = Jack Pine	O = Oak	UM = Upland Mixed	1 = Seedling Sapling Poor	6 = Pole Timber Well
C = Cedar	L = Lowland Brush	P = Lowland Poplar	V = Bog or Marsh	2 = Seedling Sapling Medium	7 = Saw Timber Poor
D = Treed Bog	LM = Lowland Mixed	Q = Mixed Swamp Conifer	W = White Pine	3 = Seedling Sapling Well	8 = Saw Timber Medium
E = Swamp Hdwoods	M = Mpl, Bch, Brch	R = Red Pine	X = Non Stocked	4 = Pole Timber Poor	9 = Saw Timber Well
F = Spruce Fir	MC = Mixed Conifer	S = Black Spruce	Z = Water		
G = Grass	MD = Mixed Deciduous	T = Tamarack			

PU	Acres	PU	Acres
1	17.0	5	20.1
2	7.8	6	23.1
3	18.8	7	20.8
4	8.1		

Nathan Briar
Compartment 10
115.7 Acres

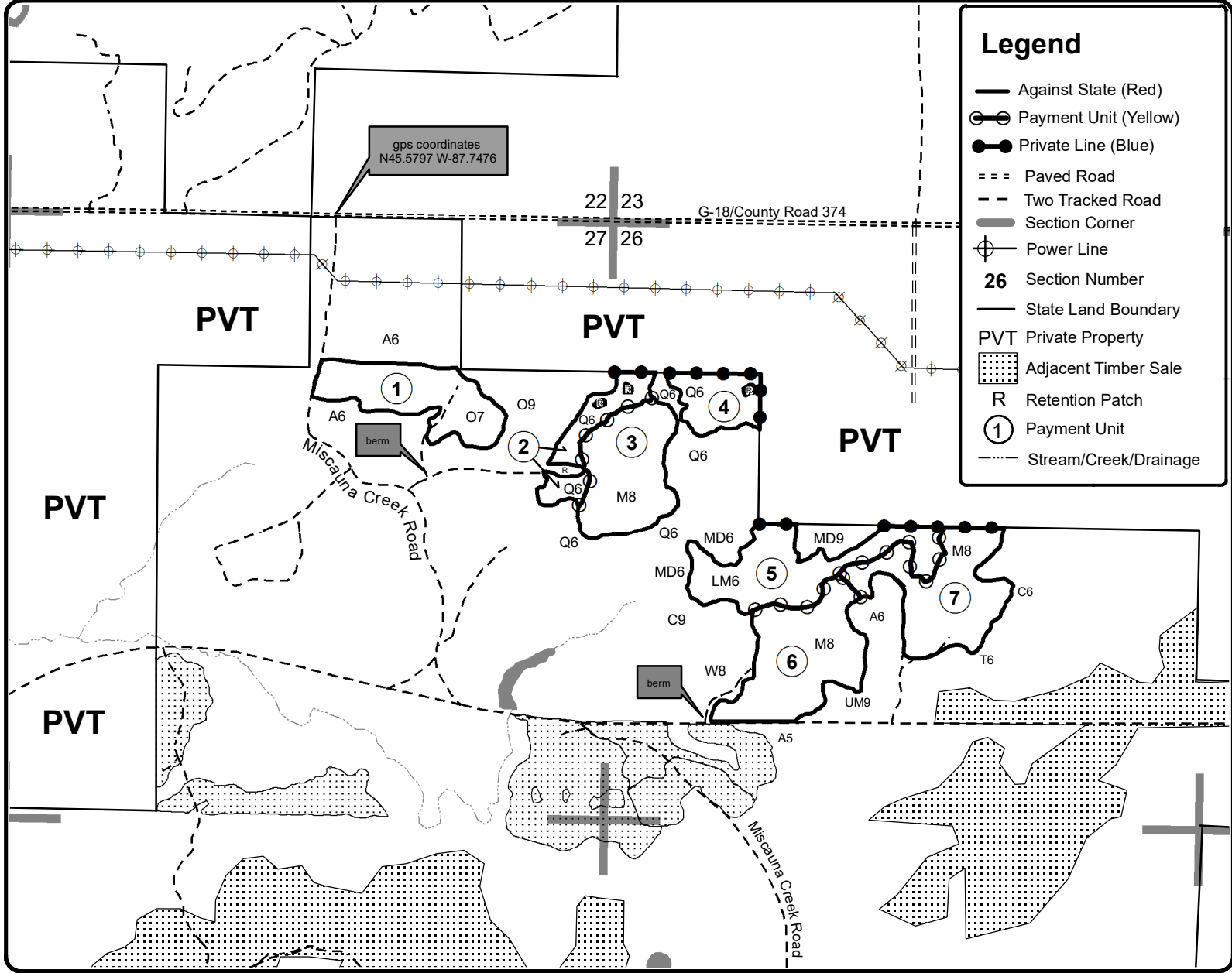

Legend

- Against State (Red)
- Payment Unit (Yellow)
- Private Line (Blue)
- == Paved Road
- - Two Tracked Road
- Section Corner
- ⊕ Power Line
- 26 Section Number
- State Land Boundary
- PVT Private Property
- ▤ Adjacent Timber Sale
- R Retention Patch
- ① Payment Unit
- Stream/Creek/Drainage

