



TIMBER SALE MAP

This information provided by authority of Part 525, 1994 PA 451, as amended.

Forest Management Unit Escanaba Management Unit		County Menominee County	Mapped By Beaudo	Date 11/2/2020	Page 1	of 1
Township 35N	Range 25W	Section(s) and Subdivision(s) Sec 13 - SWSW; Sec 14 - E1/2SE; Sec 23 - S1/2NW, E1/2NE, N1/2SW.		Scale 1:15,840		
Cover Type				Density		
A = Aspen B = Paper Birch C = Cedar D = Treed Bog E = Swamp Hdwoods F = Spruce Fir G = Grass	H = Hemlock J = Jack Pine L = Lowland Brush LM = Lowland Mixed M = Mpl, Bch, Brch MC = Mixed Conifer MD = Mixed Deciduous	N = Marsh O = Oak P = Lowland Poplar Q = Mixed Swamp Conifer R = Red Pine S = Black Spruce T = Tamarack	U = Upland Brush UM = Upland Mixed V = Bog or Marsh W = White Pine X = Non Stocked Z = Water	0 = Non Stocked 1 = Seedling Sapling Poor 2 = Seedling Sapling Medium 3 = Seedling Sapling Well 4 = Pole Timber Poor	5 = Pole Timber Medium 6 = Pole Timber Well 7 = Saw Timber Poor 8 = Saw Timber Medium 9 = Saw Timber Well	

Highway Cleanup Compartment 50 62.9 Acres

PU	Acres	PU	Acres
1	16.1	3	15.2
2	16.5	4	15.1

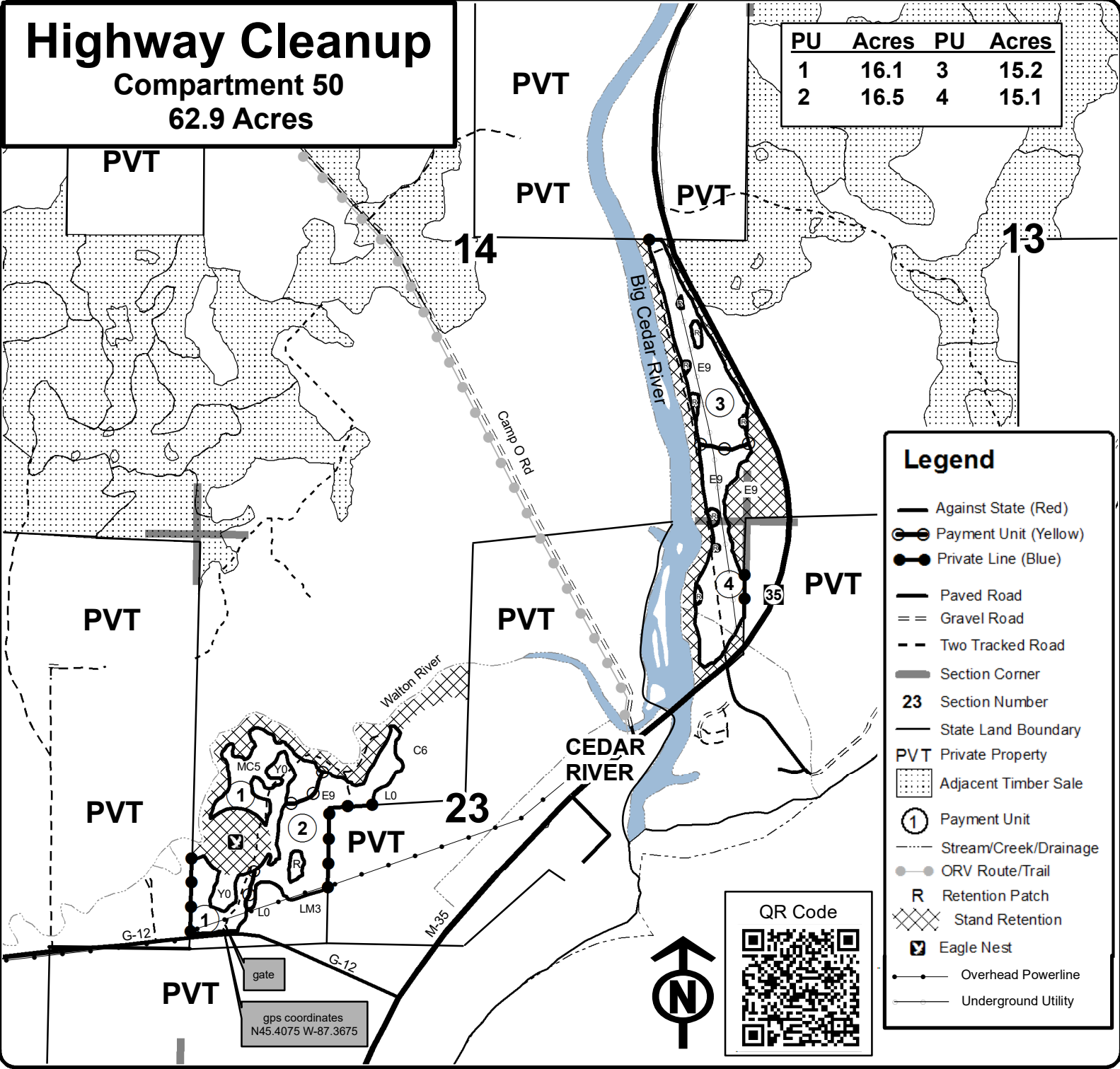

Legend

- Against State (Red)
- ⊙ Payment Unit (Yellow)
- Private Line (Blue)
- Paved Road
- == Gravel Road
- - Two Tracked Road
- Section Corner
- 23** Section Number
- State Land Boundary
- PVT Private Property
- ▨ Adjacent Timber Sale
- ① Payment Unit
- Stream/Creek/Drainage
- ORV Route/Trail
- R Retention Patch
- ▨ Stand Retention
- ☑ Eagle Nest
- Overhead Powerline
- Underground Utility



gate

gps coordinates
N45.4075 W-87.3675

