



# TIMBER SALE MAP

This information provided by authority of Part 525, 1994 PA 451, as amended.

Forest Management Unit		County	Mapped By		Date	Page	
Escanaba Management Unit		Menominee County	Beudo		9/11/2023	1	1
Township	Range	Section(s) and Subdivision(s)		Scale			
34N 35N	28W	Sec 5 - NWNW, Sec 6 - N1/2NE. Sec 31 - SENW, SWNE, N1/2SW, SE. Sec 32 - SENW, NWNE, N1/2SW, SWSW.		1:15,840			

Cover Type				Density	
A = Aspen	H = Hemlock	N = Marsh	U = Upland Brush	0 = Non Stocked	5 = Pole Timber Medium
B = Paper Birch	J = Jack Pine	O = Oak	UM = Upland Mixed	1 = Seedling Sapling Poor	6 = Pole Timber Well
C = Cedar	L = Lowland Brush	P = Lowland Poplar	V = Bog or Marsh	2 = Seedling Sapling Medium	7 = Saw Timber Poor
D = Treed Bog	LM = Lowland Mixed	Q = Mixed Swamp Conifer	W = White Pine	3 = Seedling Sapling Well	8 = Saw Timber Medium
E = Swamp Hdwoods	M = Mpl, Bch, Brch	R = Red Pine	X = Non Stocked	4 = Pole Timber Poor	9 = Saw Timber Well
F = Spruce Fir	MC = Mixed Conifer	S = Black Spruce	Z = Water		
G = Grass	MD = Mixed Deciduous	T = Tamarack			

PU	Acres	PU	Acres
1	22.1	8	20.4
2	20.1	9	26.7
3	20.2	10	28.0
4	8.0	11	1.5
5	6.2	12	6.3
6	27.5	13	12.8
7	3.4		

**Stinging Muskrat**  
**Compartment 25**  
**203.2 Acres**

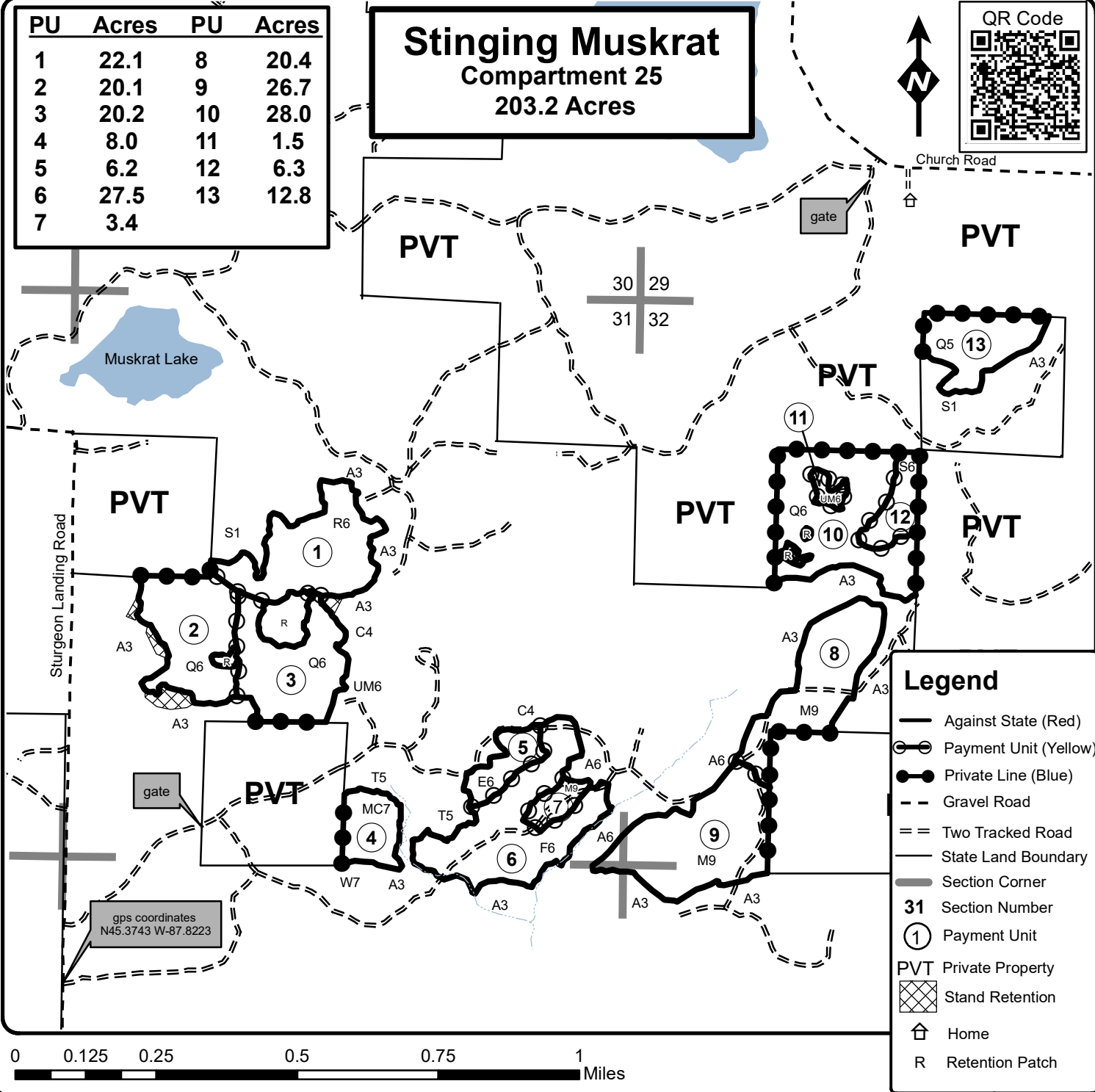

**Legend**

- Against State (Red)
- Payment Unit (Yellow)
- Private Line (Blue)
- - - Gravel Road
- == Two Tracked Road
- State Land Boundary
- Section Corner
- 31 Section Number
- ① Payment Unit
- PVT Private Property
- ▨ Stand Retention
- 🏠 Home
- R Retention Patch