



Michigan Department of Natural Resources
 Forest Resources Division
FOREST TREATMENT PROPOSAL

Location: **Gaylord Management Unit - North**

Proposal: **C52-526**

County: Cheboygan T34N R3W Sec. 4 NESW

YOE: 2016

Comp: 150

Stands: 12

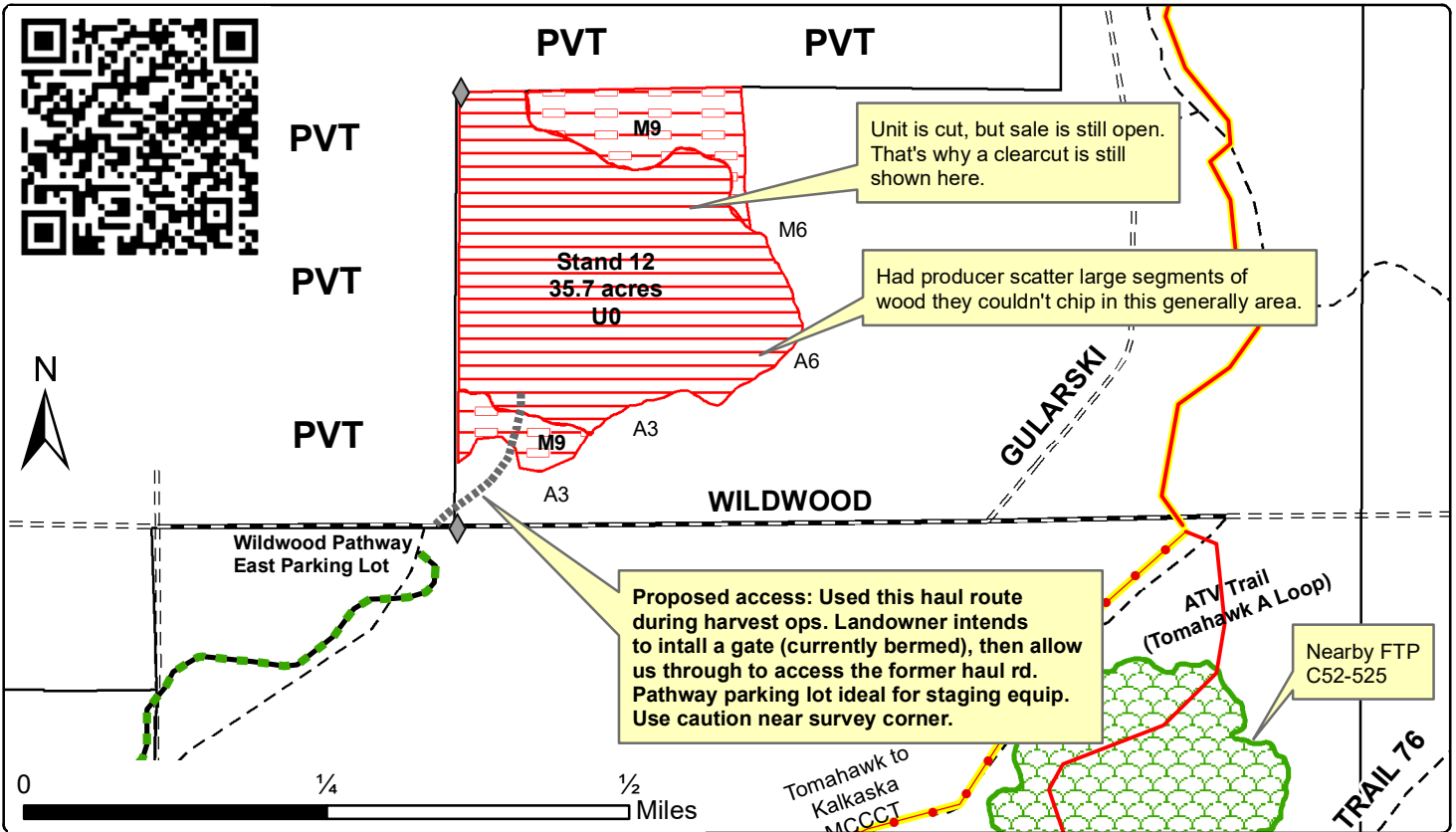

PROOFING COMMENTS
Rec: Wildwood Pathway east parking lot ~800ft S.W.
Water: Seasonally wet along areas of north boundary
HAL: None known at this time
MNFI: None known at this time
Reviewed: 11-17-21 JSP

ACTIVITY TRACKING	

Coverttype Objective: PLANTED RP	Acres: 35.7
Approved Methods: Trench & plant RP at standard spacing. Additional treatments may include roller-chopping and herbicide spraying.	
Timbersale number: 52-122-16-01, 'Wildman Gularski Mix'	
Sale admin staff: John St. Pierre	
Harvesting completed by: Unit cut June-July '19, Tulgestka	
Contract TCR date: Contract extended, one PU left to cut.	
Comments: Best access will be through private property located just north of the Wildwood Pathway east parking lot. Private landowner intends to put a gate at this location (currently bermed). This access point connects to a haul route on stateland that was used during harvest operations. Terrain is hilly but not steep, more level ground in E/SE. Was an M9 stand prior to harvest, features sandy loam hardwood soils. Cherry and/or aspen whips, 5-10ft, are quickly regenerating in most areas. Seedling density ranges 'medium to well'. Red oak left per Rx, most concentrated in a small area in east. Prescribed by Roell, prep/admin by JSP.	