



TIMBER SALE MAP

This information provided by authority of Part 525, 1994 PA 451, as amended.

Forest Management Unit Grayling		County Oscoda	Mapped By Trevor Kubitskey	Date 8/3/2022	Page 1	of 1
Township 27N	Range 01E	Section(s) and Subdivision(s) Sec 16 E1/2NW, NE1/4		Scale 1:7,920		
Cover Type				Density		
A = Aspen	H = Hemlock	N = Marsh	U = Upland Brush	0 = Non Stocked	5 = Pole Timber Medium	
B = Paper Birch	J = Jack Pine	O = Oak	UM = Upland Mixed	1 = Seedling Sapling Poor	6 = Pole Timber Well	
C = Cedar	L = Lowland Brush	P = Lowland Poplar	V = Bog or Marsh	2 = Seedling Sapling Medium	7 = Saw Timber Poor	
D = Treed Bog	LM = Lowland Mixed	Q = Mixed Swamp Conifer	W = White Pine	3 = Seedling Sapling Well	8 = Saw Timber Medium	
E = Swamp Hdwoods	M = Mpl, Bch, Brch	R = Red Pine	X = Non Stocked	4 = Pole Timber Poor	9 = Saw Timber Well	
F = Spruce Fir	MC = Mixed Conifer	S = Black Spruce	Z = Water			
G = Grass	MD = Mixed Deciduous	T = Tamarack				

PU Acres

1	30.6
2	19.8
3	25.7

Griffin Road Aspen

Compartment 005

76.1 Acres

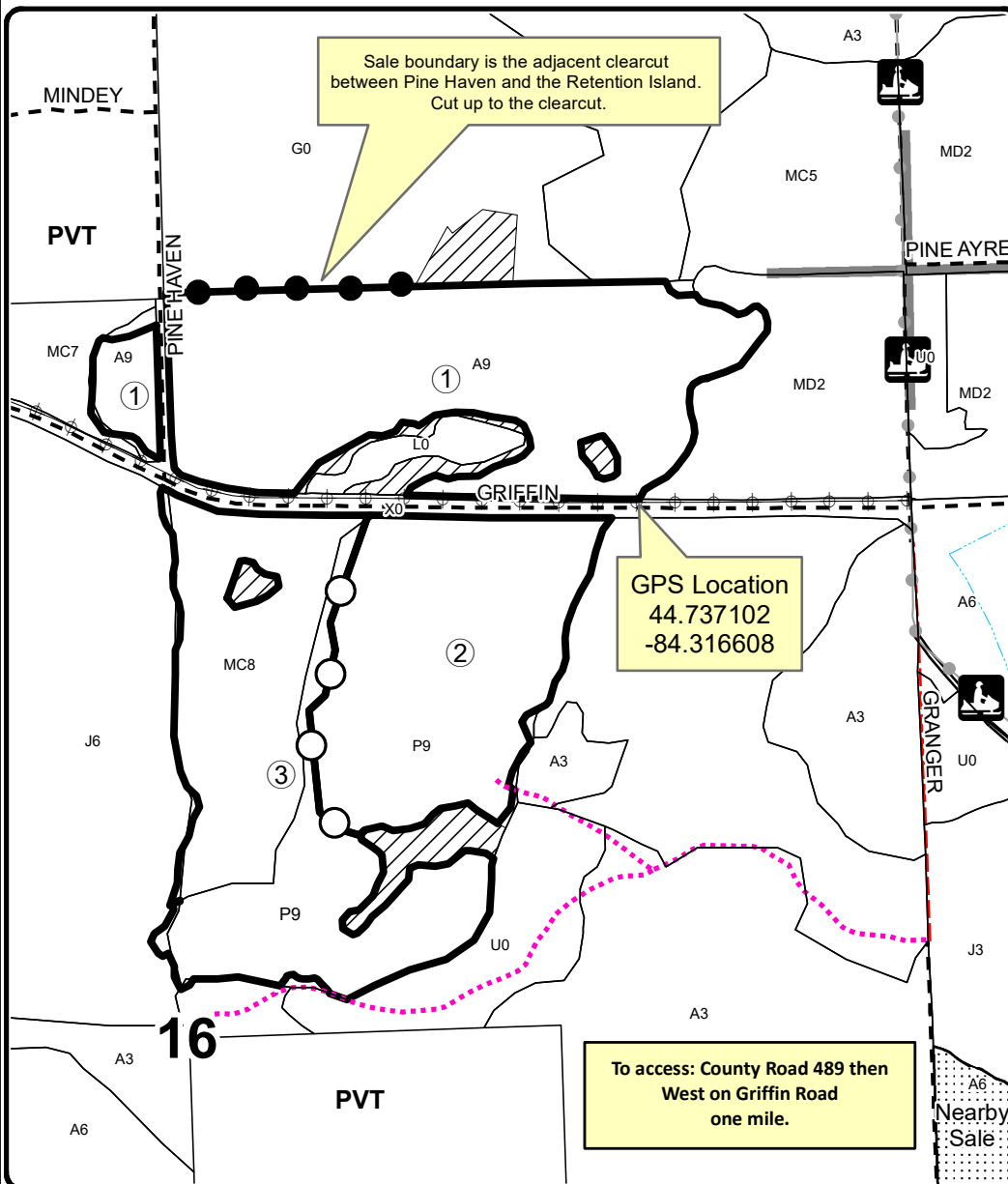
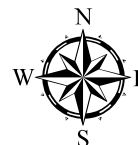

Legend

- Against State (Red)
- Payment Unit (Yellow)
- Unpainted Sale Boundary
- Retention Area
- Nearby Timber Sales
- Stand Boundaries
- Recreational Trail
- Secondary Forest Road
- Gravel Road
- County Road - Seasonal
- Temporary Management Access
- Intermittent Stream
- Section Corners
- Payment Unit
- PVT** Private Property
- Pipeline
- Powerline

Avenza Map

