



# TIMBER SALE MAP

This information provided by authority of Part 525, 1994 PA 451, as amended.

Sale Number	Year
72 - 013	19

Forest Management Unit	County	Mapped By	Date	Page	of
Grayling	Crawford	Scott McClarren	06/24/2019	1	2
Township	Range	Section(s) and Subdivision(s)	Scale		
27N	04W	Sec 25 NW, N1/2NE, SWNE, E1/2SW, Sec 24, NWNW, S1/2NW, SW, S1/2SE	1:15,840		

Cover Type				Density	
A = Aspen	H = Hemlock	N = Marsh	U = Upland Brush	0 = Non Stocked	5 = Pole Timber Medium
B = Paper Birch	J = Jack Pine	O = Oak	UM = Upland Mixed	1 = Seedling Sapling Poor	6 = Pole Timber Well
C = Cedar	L = Lowland Brush	P = Lowland Poplar	V = Bog or Marsh	2 = Seedling Sapling Medium	7 = Saw Timber Poor
D = Treed Bog	LM = Lowland Mixed	Q = Mixed Swamp Conifer	W = White Pine	3 = Seedling Sapling Well	8 = Saw Timber Medium
E = Swamp Hdwoods	M = Mpl, Bch, Brch	R = Red Pine	X = Non Stocked	4 = Pole Timber Poor	9 = Saw Timber Well
F = Spruce Fir	MC = Mixed Conifer	S = Black Spruce	Z = Water		
G = Grass	MD = Mixed Deciduous	T = Tamarack			

PU	Acres	PU	Acres
1	47.1	4	24.3
2	7.9	5	23.9
3	43.3		

## Left Field Mix

### Compartment 206

146.5 Acres

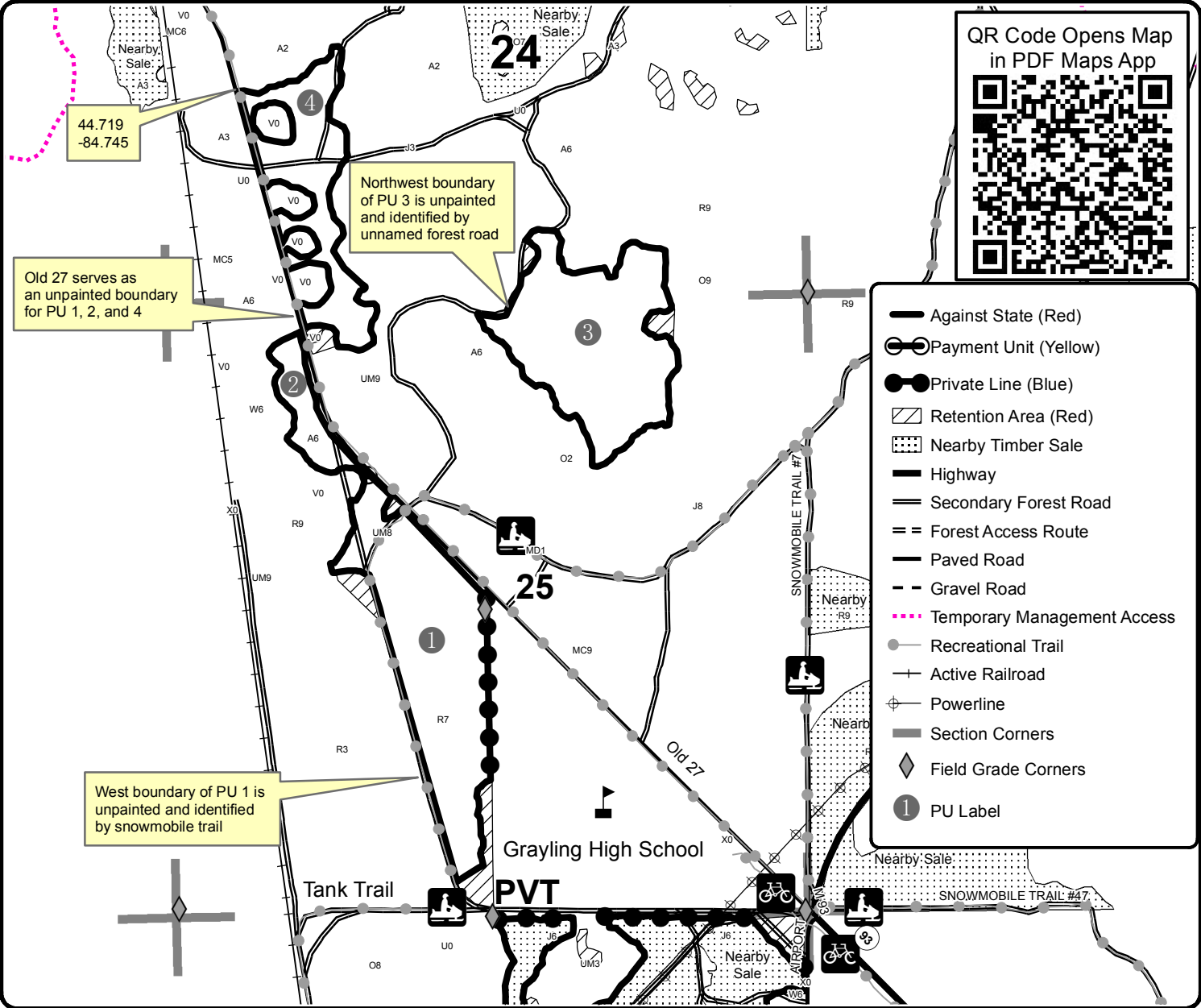

QR Code Opens Map in PDF Maps App

Old 27 serves as an unpainted boundary for PU 1, 2, and 4

Northwest boundary of PU 3 is unpainted and identified by unnamed forest road

West boundary of PU 1 is unpainted and identified by snowmobile trail

