



TIMBER SALE MAP

This information provided by authority of Part 525, 1994 PA 451, as amended.

| | | | | | | |
|-----------------------------------|--------------|---|------------------------------|--------------------|-------------------|---------|
| Forest Management Unit Graying | | County Oscoda | Mapped By Scott McClarren | Date 09/25/2020 | Page 1 | of 2 |
| Township 27N | Range 01E | Section(s) and Subdivision(s) Sec. 26: SESE Sec. 28: N1/2NE, SENE Sec. 35: N1/2NE. | | | Scale 1:15,840 | |

| Cover Type | | | | Density | |
|-------------------|----------------------|-------------------------|-------------------|-----------------------------|------------------------|
| A = Aspen | H = Hemlock | N = Marsh | U = Upland Brush | 0 = Non Stocked | 5 = Pole Timber Medium |
| B = Paper Birch | J = Jack Pine | O = Oak | UM = Upland Mixed | 1 = Seedling Sapling Poor | 6 = Pole Timber Well |
| C = Cedar | L = Lowland Brush | P = Lowland Poplar | V = Bog or Marsh | 2 = Seedling Sapling Medium | 7 = Saw Timber Poor |
| D = Treed Bog | LM = Lowland Mixed | Q = Mixed Swamp Conifer | W = White Pine | 3 = Seedling Sapling Well | 8 = Saw Timber Medium |
| E = Swamp Hdwoods | M = Mpl, Bch, Brch | R = Red Pine | X = Non Stocked | 4 = Pole Timber Poor | 9 = Saw Timber Well |
| F = Spruce Fir | MC = Mixed Conifer | S = Black Spruce | Z = Water | | |
| G = Grass | MD = Mixed Deciduous | T = Tamarack | | | |

| PU | Acres | PU | Acres |
|----|-------|----|-------|
| 1 | 32.6 | 4 | 29.5 |
| 2 | 33.7 | 5 | 38.2 |
| 3 | 28.4 | | |

Tetris Pine Final

Compartment 02

162.4 Acres

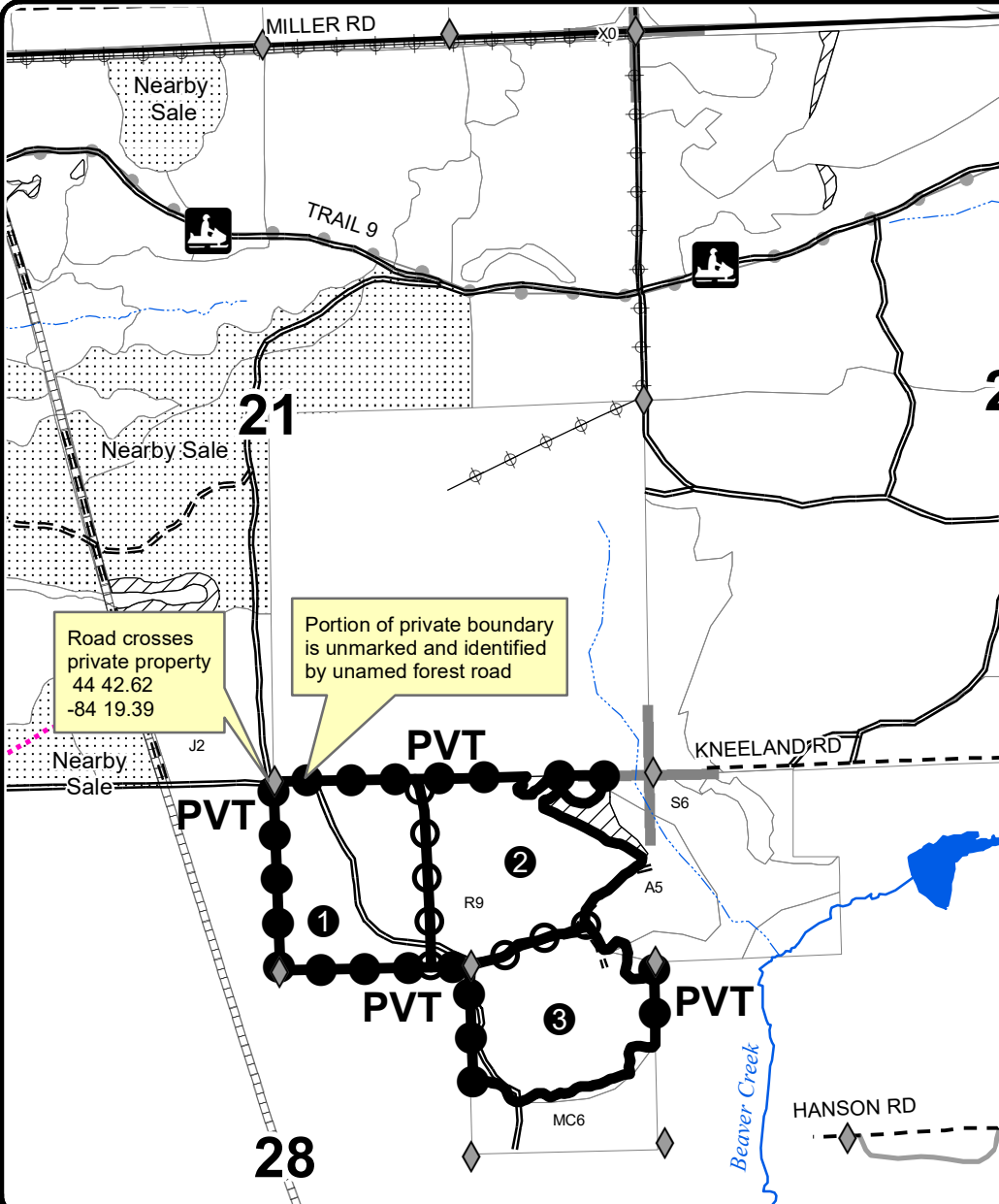
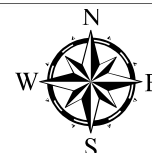

QR Code Opens Map in PDF Maps App

- Against State (Red)
- Payment Unit (Yellow)
- Private Line (Blue)
- Retention Area (Red)
- Stand Boundaries
- Nearby Sales
- Secondary Forest Road
- Forest Access Route
- Paved Road
- Gravel Road
- Private
- Temporary Management Access
- Recreation Trails
- Pipeline
- Powerline
- Perennial Stream
- Intermittent Stream
- Section Corners
- Field Grade Corners
- PU Label

