

**TIMBER SALE MAP**

This information provided by authority of Part 525, 1994 PA 451, as amended.

Sale Number

72-036-25

Date

10/03/2025

Forest Management Unit

Grayling Mgt Unit

County

Oscoda

Mapped By: Collin Whitsett

Cruised By: Whitsett & Price

Scale

1:7,920

Page

1

Of

1

Township

28N

Range

02E

Section(s) and

Subdivision(s) **Sec. 22 S1/2SW; Sec. 27 N1/2NW,SENW,W1/2NE;****Cover Type**

A = Aspen	J = Jack Pine	O = Oak	U = Upland Brush
B = Paper Birch	K = Rock	P = Lowland Poplar	UM = Upland Mix Forest
C = Cedar	L = Lowland Brush	Q = Mixed Swamp Conifer	V = Bog or Marsh
D = Treed Bog	LM = Lowland Mix Forest	R = Red Pine	W = White Pine
E = Swamp Hardwoods	M = Maple, Beech, Birch	S = Black Spruce	X = Non Stocked
F = Spruce/Fir	MC = Mixed Conifer	T = Tamarack	Y = Sand
G = Grass	MD = Mixed Deciduous	Z = Water	
H = Hemlock	N = Marsh		

Density

0 = Non Stocked	5 = Pole Timber Medium
1 = Seedling Sapling Poor	6 = Pole Timber Well
2 = Seedling Sapling Medium	7 = Saw Timber Poor
3 = Seedling Sapling Well	8 = Saw Timber Medium
4 = Pole Timber Poor	9 = Saw Timber Well

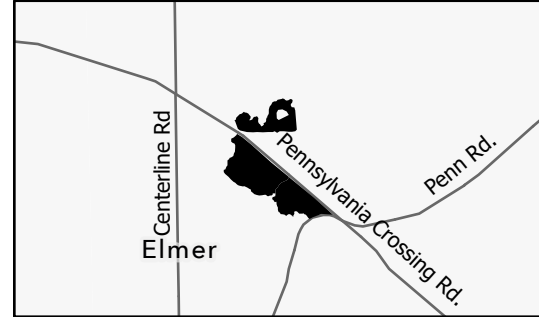
Locator Map 1:50,000**Payment Unit Acres**

1	12.8
2	22.7
3	13.6

**Ice- Back By
Poplar
Demand****49.1 Acres**

0 0.13 0.25 0.5 Miles

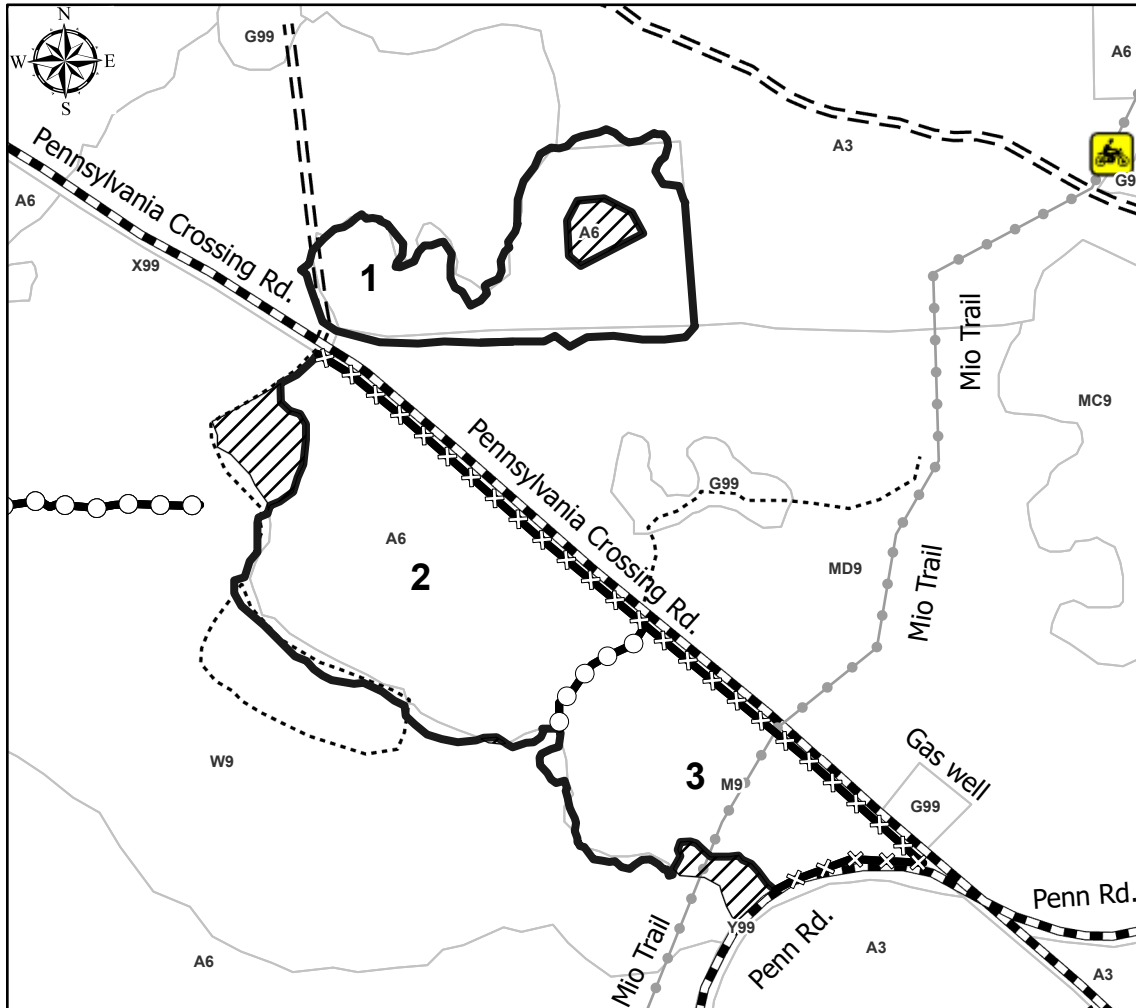
**Legend**

- Payment Unit
- Against State (Red)
- Against State (Unpainted)
- Payment Unit (Yellow)
- Forest Access Route
- Administrative Access Only
- Government Gravel/Dirt
- Recreational Trails
- Retention

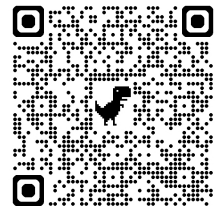
Use QR Code to
open Map in AppUse QR Code to
open the cruise tree list