



### TIMBER SALE MAP

This information provided by authority of Part 525, 1994 PA 451, as amended.

|                                 |                           |                |
|---------------------------------|---------------------------|----------------|
| Sale Number<br><b>72-004-25</b> | Date<br><b>02/04/2025</b> |                |
| Scale<br><b>1:7,920</b>         | Page<br><b>2</b>          | Of<br><b>2</b> |

|  |                           |                                    |
|--|---------------------------|------------------------------------|
| Forest Management Unit<br><b>Grayling Mgt Unit</b> | County<br><b>Crawford</b> | Mapped By: <b>Derek Nellis</b>     |
|  |                           | Cruised By: <b>Scott McClarren</b> |

|                        |                     |   |
|------------------------|---------------------|---|
| Township<br><b>28N</b> | Range<br><b>03W</b> | Section(s) and<br>Subdivision(s) <b>Sec. 31 S1/2NW,SW; Sec. 33 E1/2NE,NESE;</b> |
|------------------------|---------------------|---|

| Cover Type          |                         |                         |                        |
|---------------------|-------------------------|-------------------------|------------------------|
| A = Aspen           | J = Jack Pine           | O = Oak                 | U = Upland Brush       |
| B = Paper Birch     | K = Rock                | P = Lowland Poplar      | UM = Upland Mix Forest |
| C = Cedar           | L = Lowland Brush       | Q = Mixed Swamp Conifer | V = Bog or Marsh       |
| D = Treed Bog       | LM = Lowland Mix Forest | R = Red Pine            | W = White Pine         |
| E = Swamp Hardwoods | M = Maple, Beech, Birch | S = Black Spruce        | X = Non Stocked        |
| F = Spruce/Fir      | MC = Mixed Conifer      | T = Tamarack            | Y = Sand               |
| G = Grass           | MD = Mixed Deciduous    |                         | Z = Water              |
| H = Hemlock         | N = Marsh               |                         |                        |

| Density                     |                        |
|-----------------------------|------------------------|
| 0 = Non Stocked             | 5 = Pole Timber Medium |
| 1 = Seedling Sapling Poor   | 6 = Pole Timber Well   |
| 2 = Seedling Sapling Medium | 7 = Saw Timber Poor    |
| 3 = Seedling Sapling Well   | 8 = Saw Timber Medium  |
| 4 = Pole Timber Poor        | 9 = Saw Timber Well    |

| Payment Unit Number | Acres |
|---------------------|-------|
| 1                   | 42.9  |
| 2                   | 18.5  |
| 3                   | 1.4   |
| 4                   | 14.1  |

## Red Shouldered Pine Re-Do

### Comp 216

### 76.9 Acres

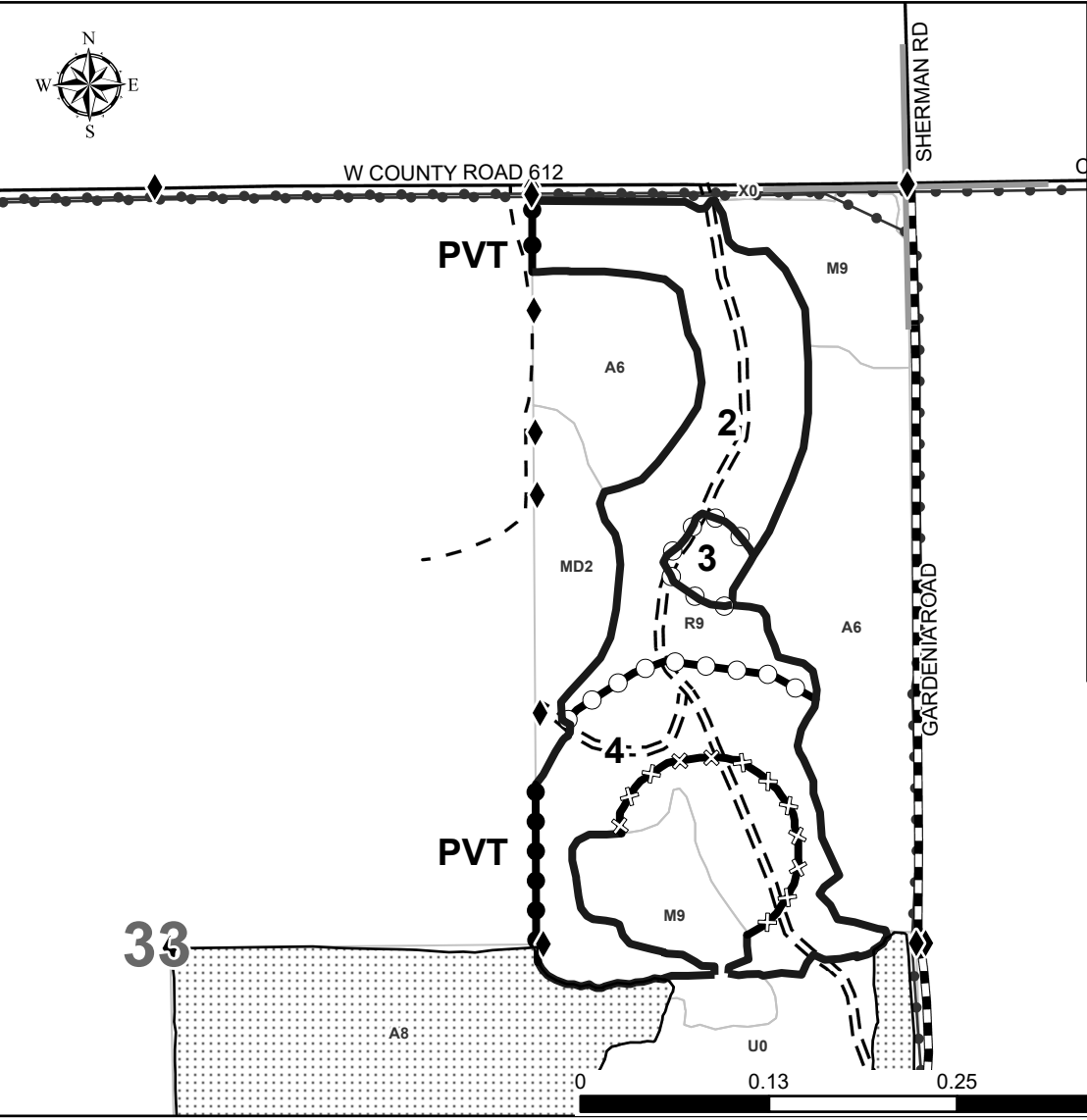

### Legend

- Against State (Red)
- x— Against State (Purple)
- Private Line (Blue)
- Payment Unit (Purple)
- x— Payment Unit (Red X)
- Stand
- ▨ Retention Areas
- - - Forest Access Route
- Paved Road
- x— Government Gravel/Dirt
- - - Private Gravel/Dirt
- Powerline
- ◆ Field Grade Corner
- MIRIS Section Corner
- ▤ Nearby Timber Sale