



TIMBER SALE MAP

This information provided by authority of Part 525, 1994 PA 451, as amended.

Forest Management Unit Gwinn		County Marquette	Mapped By McDonald	Date 09/26/2017	Page 1	of 1
Township 43N	Range 25W	Section(s) and Subdivision(s) Sections 29 and 30		Scale 1:15,840		

Cover Type				Density	
A = Aspen	H = Hemlock	N = Marsh	U = Upland Brush	0 = Non Stocked	5 = Pole Timber Medium
B = Paper Birch	J = Jack Pine	O = Oak	UM = Upland Mixed	1 = Seedling Sapling Poor	6 = Pole Timber Well
C = Cedar	L = Lowland Brush	P = Lowland Poplar	V = Bog or Marsh	2 = Seedling Sapling Medium	7 = Saw Timber Poor
D = Treed Bog	LM = Lowland Mixed	Q = Mixed Swamp Conifer	W = White Pine	3 = Seedling Sapling Well	8 = Saw Timber Medium
E = Swamp Hdwoods	M = Mpl, Bch, Brch	R = Red Pine	X = Non Stocked	4 = Pole Timber Poor	9 = Saw Timber Well
F = Spruce Fir	MC = Mixed Conifer	S = Black Spruce	Z = Water		
G = Grass	MD = Mixed Deciduous	T = Tamarack			

PU	Acres	PU	Acres
1	31	6	48.6
2	37.5	7	37.3
3	26.1	8	43.3
4	29.2	9	14.6
5	45.3		

Big West

Compartment 69

312.9 Acres

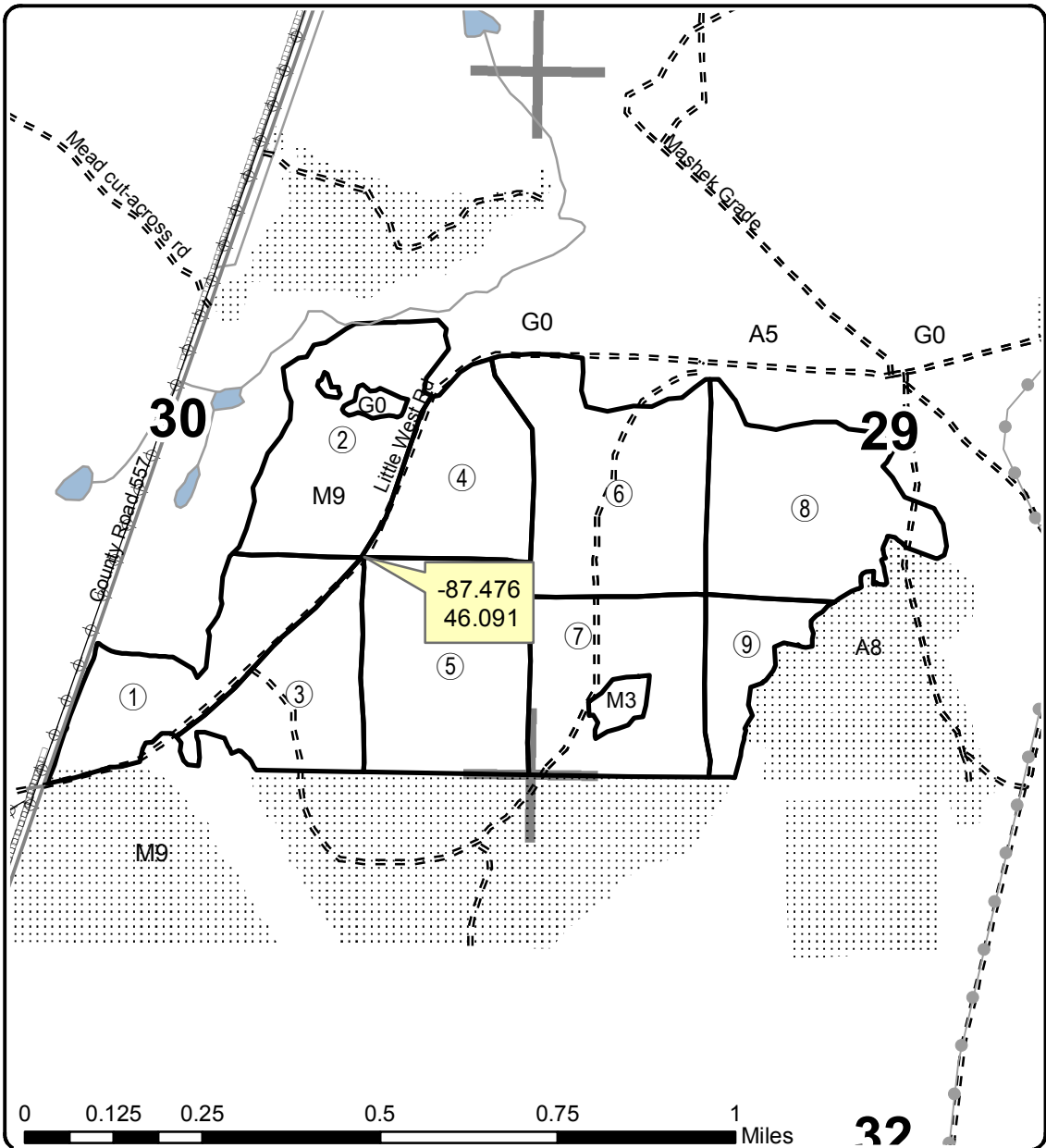

Legend

- Sale Boundary and Payment Unit (red)
- Section Corners
- Recreational Trail
- Paved Roads
- Poor Dirt Roads
- Pipeline
- Powerline
- Lakes and Rivers
- All
- Nearby Timber Sale

Locator Map
1:200,000

