



TIMBER SALE MAP

This information provided by authority of Part 525, 1994 PA 451, as amended.

Sale Number 32-003-26	Date 05/06/2025
Scale 1:20,000	Page 2
	Of 2

Forest Management Unit Gwinn Mgt Unit	County Marquette	Mapped By: Sean Fischer
		Cruised By: N/A

Township 45N	Range 24W	Section(s) and Subdivision(s) SWNE,E1/2SW,NWSE; Sec. 21 NENE,S1/2NE; Sec. 22 SWNW,NWSW; Sec. 26 N1/2NW,SWNW,NWNE,NESW; Sec. 5
------------------------	---------------------	--

Cover Type			
A = Aspen	J = Jack Pine	O = Oak	U = Upland Brush
B = Paper Birch	K = Rock	P = Lowland Poplar	UM = Upland Mix Forest
C = Cedar	L = Lowland Brush	Q = Mixed Swamp Conifer	V = Bog or Marsh
D = Treed Bog	LM = Lowland Mix Forest	R = Red Pine	W = White Pine
E = Swamp Hardwoods	M = Maple, Beech, Birch	S = Black Spruce	X = Non Stocked
F = Spruce/Fir	MC = Mixed Conifer	T = Tamarack	Y = Sand
G = Grass	MD = Mixed Deciduous	Z = Water	
H = Hemlock	N = Marsh		

Density	
0 = Non Stocked	5 = Pole Timber Medium
1 = Seedling Sapling Poor	6 = Pole Timber Well
2 = Seedling Sapling Medium	7 = Saw Timber Poor
3 = Seedling Sapling Well	8 = Saw Timber Medium
4 = Pole Timber Poor	9 = Saw Timber Well

**Comp 29 Contract Marking
258.0 Acres**

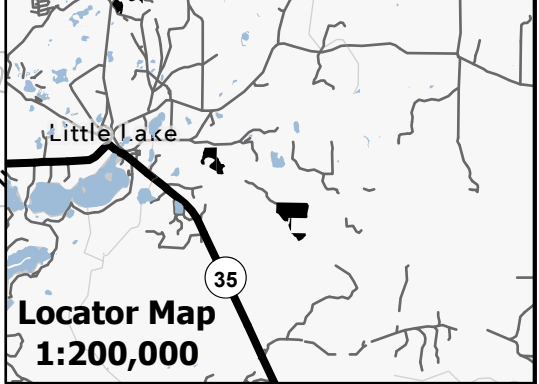
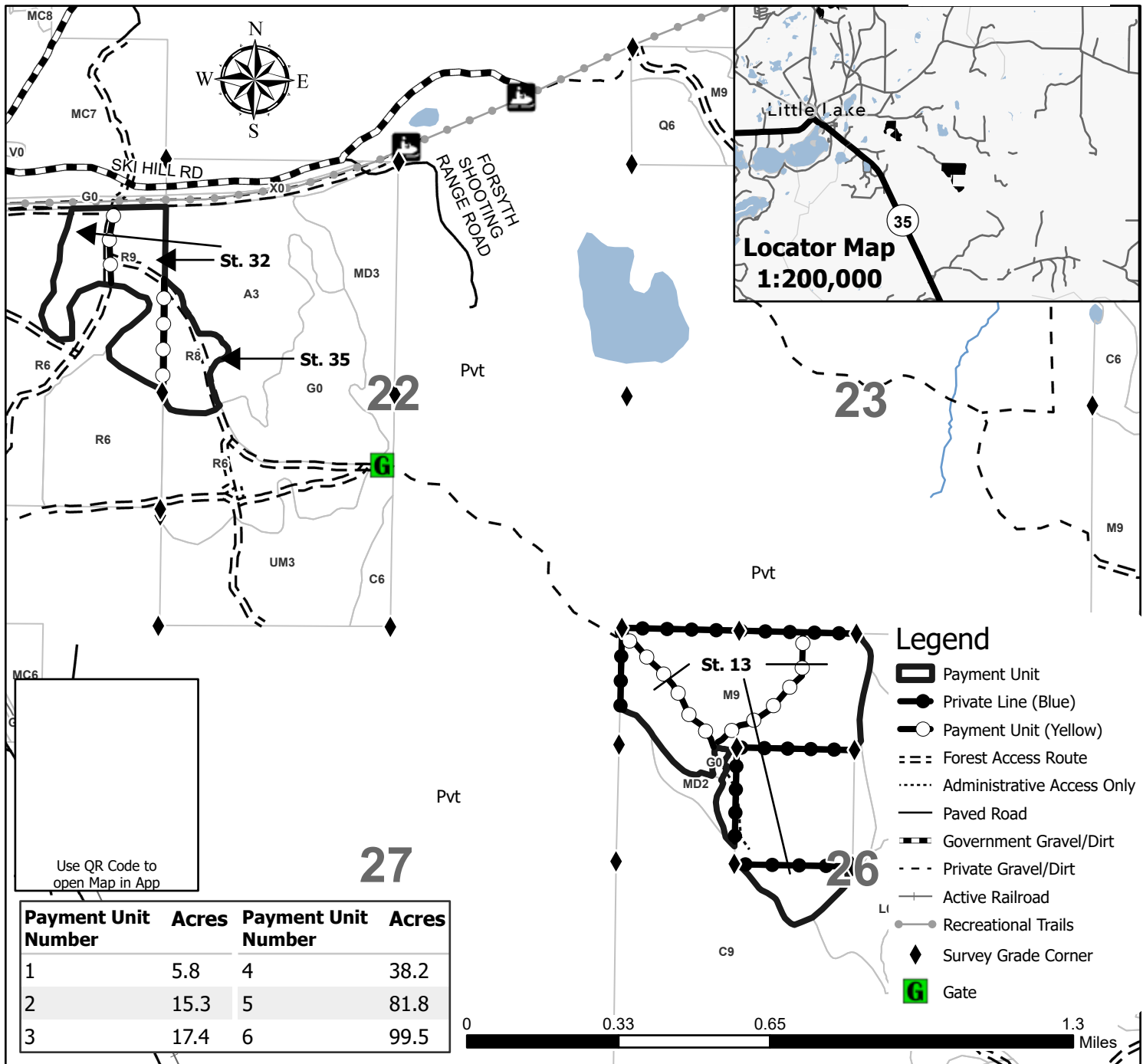

Legend

- Payment Unit
- Private Line (Blue)
- Payment Unit (Yellow)
- Forest Access Route
- Administrative Access Only
- Paved Road
- Government Gravel/Dirt
- Private Gravel/Dirt
- Active Railroad
- Recreational Trails
- Survey Grade Corner
- Gate

Use QR Code to open Map in App

Payment Unit Number	Acres	Payment Unit Number	Acres
1	5.8	4	38.2
2	15.3	5	81.8
3	17.4	6	99.5

