



TIMBER SALE MAP

This information provided by authority of Part 525, 1994 PA 451, as amended.

Forest Management Unit Gwinn		County Marquette	Mapped By Holodnick	Date 09/30/20	Page 1	of 2
Township 44N	Range 23W	Section(s) and Subdivision(s) Sec 24: NWNW, S1/2NW, S1/2NE, N1/2SW, SESW, N1/2SE, SWSE Sec 25: SENW, SWNE, NESW, S1/2SW, W1/2SE Sec 36: NW, NE, N1/2SE		Scale 1:15,840		

Cover Type				Density	
A = Aspen	H = Hemlock	N = Marsh	U = Upland Brush	0 = Non Stocked	5 = Pole Timber Medium
B = Paper Birch	J = Jack Pine	O = Oak	UM = Upland Mixed	1 = Seedling Sapling Poor	6 = Pole Timber Well
C = Cedar	L = Lowland Brush	P = Lowland Poplar	V = Bog or Marsh	2 = Seedling Sapling Medium	7 = Saw Timber Poor
D = Tread Bog	LM = Lowland Mixed	Q = Mixed Swamp Conifer	W = White Pine	3 = Seedling Sapling Well	8 = Saw Timber Medium
E = Swamp Hdwoods	M = Mpl, Bch, Brch	R = Red Pine	X = Non Stocked	4 = Pole Timber Poor	9 = Saw Timber Well
F = Spruce Fir	MC = Mixed Conifer	S = Black Spruce	Z = Water		
G = Grass	MD = Mixed Deciduous	T = Tamarack			

PU Acres

1	29.7	6	19.3	11	12.2	16	5.5
2	17.9	7	13.2	12	27	17	8.8
3	15.8	8	30	13	17.2	18	9.8
4	28.1	9	12.3	14	46.9		
5	20.5	10	7.1	15	32		

McMaple Horse Compartment 9 353.3 Acres



GPS:
46.04'31"
-87.24'45"
DMS

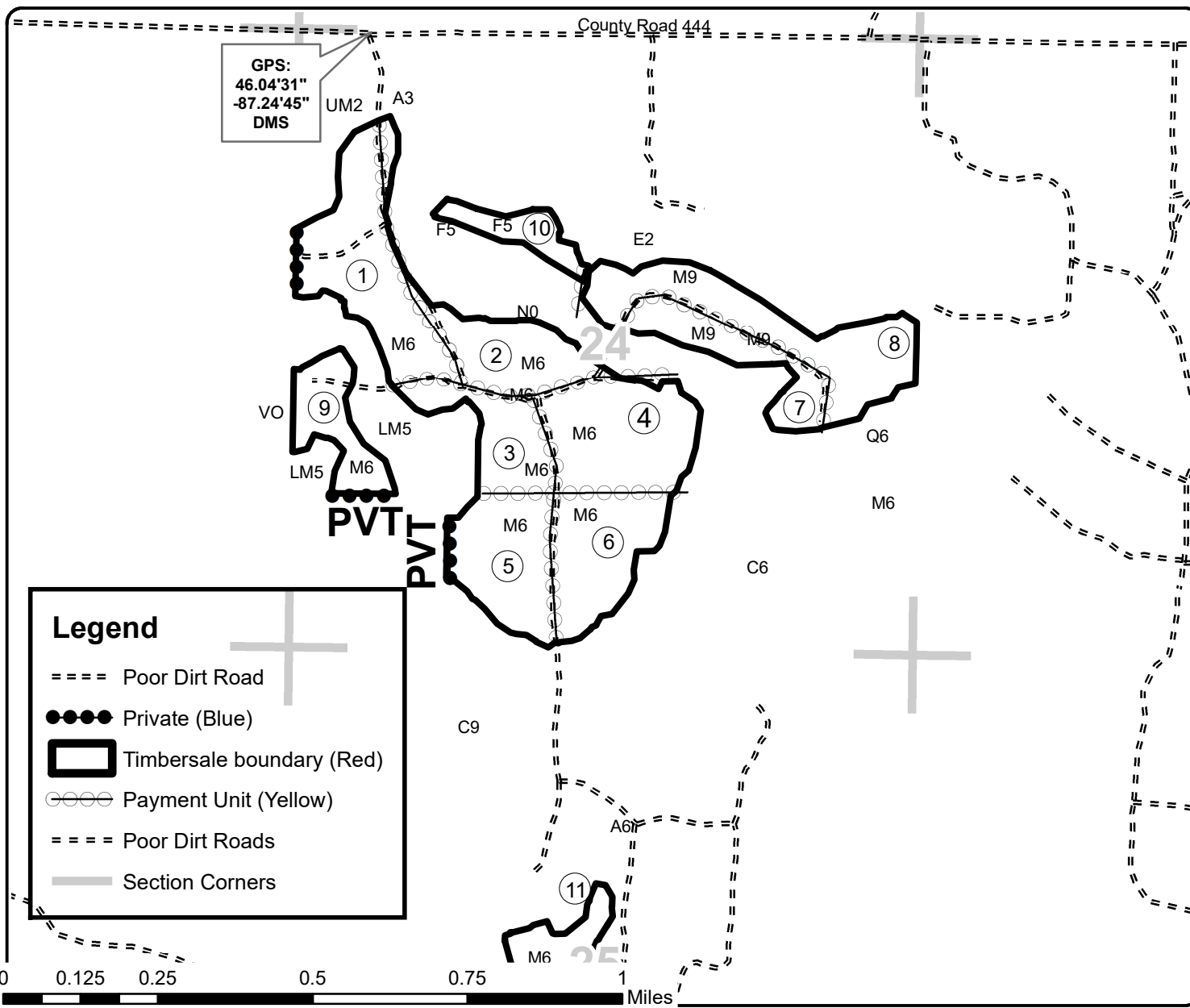

Legend

- ==== Poor Dirt Road
- Private (Blue)
- ▭ Timbersale boundary (Red)
- ⊖⊖⊖⊖ Payment Unit (Yellow)
- ==== Poor Dirt Roads
- Section Corners

