



TIMBER SALE MAP

This information provided by authority of Part 525, 1994 PA 451, as amended.

Forest Management Unit Gwinn		County Marquette	Mapped By Brolin	Date 09/10/2019	Page 1	of 1
Township 44N	Range 26W	Section(s) and Subdivision(s) Sections 23, 25, 26, 27, and 36		Scale 1:31,680		

Cover Type				Density			
A = Aspen	H = Hemlock	N = Marsh	U = Upland Brush	0 = Non Stocked	5 = Pole Timber Medium		
B = Paper Birch	J = Jack Pine	O = Oak	UM = Upland Mixed	1 = Seedling Sapling Poor	6 = Pole Timber Well		
C = Cedar	L = Lowland Brush	P = Lowland Poplar	V = Bog or Marsh	2 = Seedling Sapling Medium	7 = Saw Timber Poor		
D = Tread Bog	LM = Lowland Mixed	Q = Mixed Swamp Conifer	W = White Pine	3 = Seedling Sapling Well	8 = Saw Timber Medium		
E = Swamp Hdwoods	M = Mpl, Bch, Brch	R = Red Pine	X = Non Stocked	4 = Pole Timber Poor	9 = Saw Timber Well		
F = Spruce Fir	MC = Mixed Conifer	S = Black Spruce	Z = Water				
G = Grass	MD = Mixed Deciduous	T = Tamarack					

PU Acres	PU Acres	PU Acres	PU Acres	PU Acres
1 11.5	7 20.4	13 9.9	14 23.4	
2 9.4	8 8.0	15 4.3	16 31.5	
3 20.8	9 4.5			
4 23.0	10 18.4			
5 3.4	11 24.0			
6 19.3	12 23.3			

Patches of GEMS

Compartment 51

255.1 Acres



QR code for PDF Map app

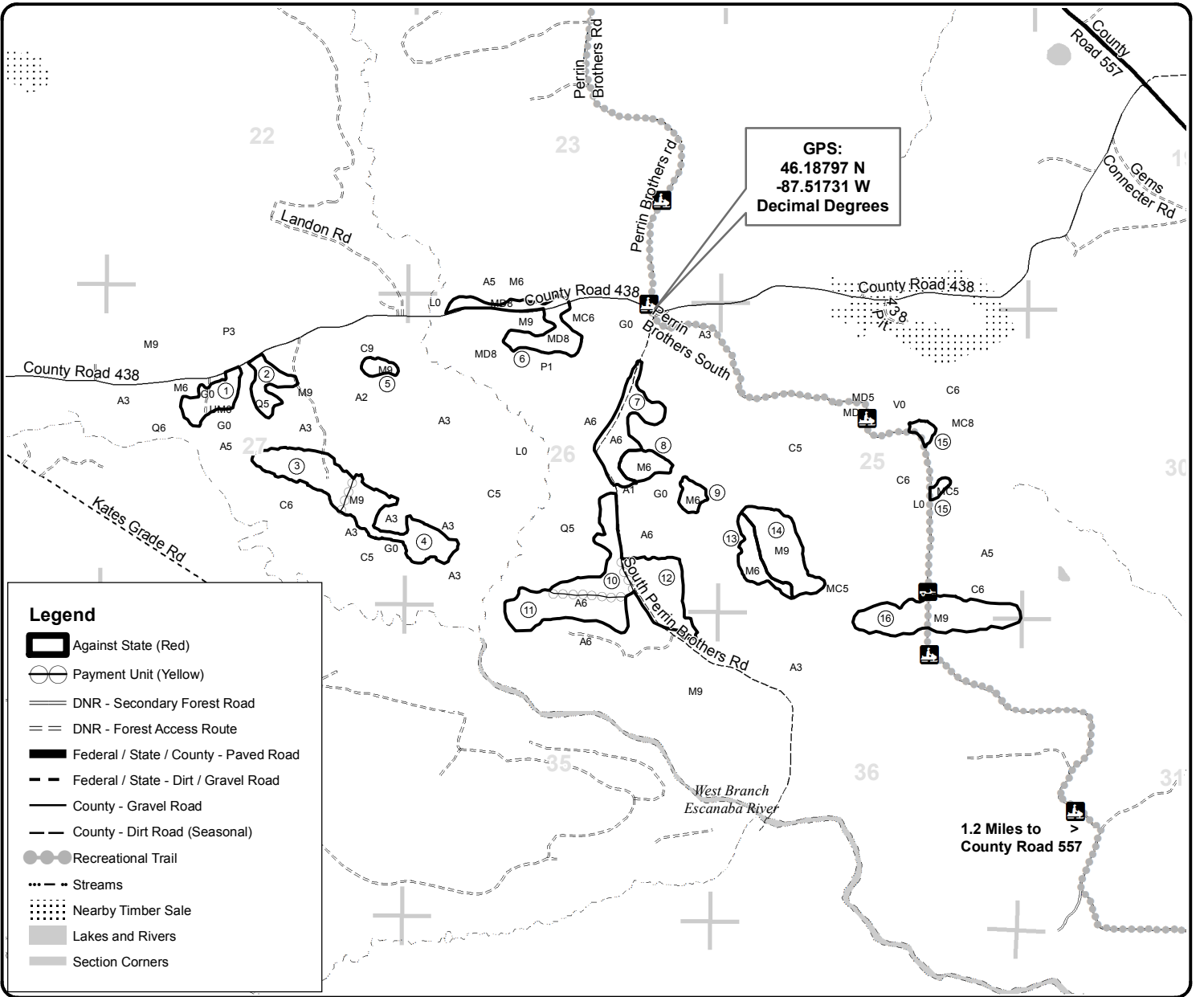

Legend

- Against State (Red)
- Payment Unit (Yellow)
- DNR - Secondary Forest Road
- DNR - Forest Access Route
- Federal / State / County - Paved Road
- Federal / State - Dirt / Gravel Road
- County - Gravel Road
- County - Dirt Road (Seasonal)
- Recreational Trail
- Streams
- Nearby Timber Sale
- Lakes and Rivers
- Section Corners

