



# TIMBER SALE MAP

This information provided by authority of Part 525, 1994 PA 451, as amended.

Forest Management Unit Gwinn Management Unit		County Marquette	Mapped By Brolin	Date 09/07/2021	Page 1	of 1
Township 45N	Range 23W	Section(s) and Subdivision(s) Sections 35 and 36		Scale 1:15,840		

Cover Type				Density	
A = Aspen	H = Hemlock	N = Marsh	U = Upland Brush	0 = Non Stocked	5 = Pole Timber Medium
B = Paper Birch	J = Jack Pine	O = Oak	UM = Upland Mixed	1 = Seedling Sapling Poor	6 = Pole Timber Well
C = Cedar	L = Lowland Brush	P = Lowland Poplar	V = Bog or Marsh	2 = Seedling Sapling Medium	7 = Saw Timber Poor
D = Treed Bog	LM = Lowland Mixed	Q = Mixed Swamp Conifer	W = White Pine	3 = Seedling Sapling Well	8 = Saw Timber Medium
E = Swamp Hdwoods	M = Mpl, Bch, Brch	R = Red Pine	X = Non Stocked	4 = Pole Timber Poor	9 = Saw Timber Well
F = Spruce Fir	MC = Mixed Conifer	S = Black Spruce	Z = Water		
G = Grass	MD = Mixed Deciduous	T = Tamarack			

PU Acres	PU Acres
1 15.4	5 20.2
2 15.0	6 15.3
3 16.3	7 24.6
4 17.0	

## Typical Maple Compartment 1 123.8 Acres



QR code for PDF Maps app

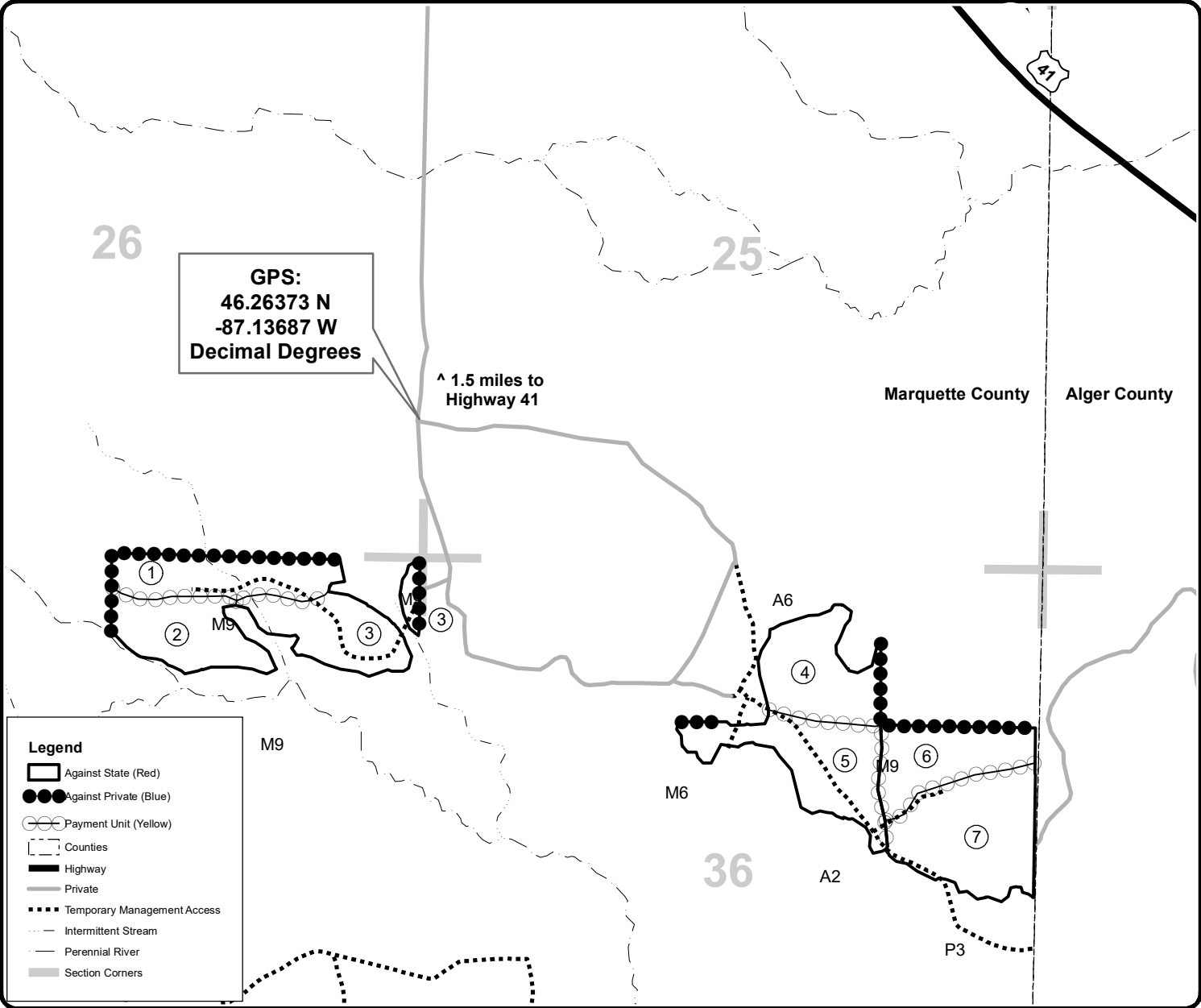

**Legend**

- Against State (Red)
- Against Private (Blue)
- Payment Unit (Yellow)
- Counties
- Highway
- Private
- Temporary Management Access
- Intermittent Stream
- Perennial River
- Section Corners

