



# TIMBER SALE MAP

This information provided by authority of Part 525, 1994 PA 451, as amended.

Forest Management Unit Newberry Management Unit		County Luce	Mapped By Douglass	Date 10/05/2018	Page 1	of 1
Township 50N	Range 08W	Section(s) and Subdivision(s) Sec 29 - SESW, W1/2SE; Sec 32 - NE1/4, E1/2NW, N1/2SE, SWSE		Scale 1:15,840		

Cover Type				Density	
A = Aspen	H = Hemlock	N = Marsh	U = Upland Brush	0 = Non Stocked	5 = Pole Timber Medium
B = Paper Birch	J = Jack Pine	O = Oak	UM = Upland Mixed	1 = Seedling Sapling Poor	6 = Pole Timber Well
C = Cedar	L = Lowland Brush	P = Lowland Poplar	V = Bog or Marsh	2 = Seedling Sapling Medium	7 = Saw Timber Poor
D = Treed Bog	LM = Lowland Mixed	Q = Mixed Swamp Conifer	W = White Pine	3 = Seedling Sapling Well	8 = Saw Timber Medium
E = Swamp Hdwoods	M = Mpl, Bch, Brch	R = Red Pine	X = Non Stocked	4 = Pole Timber Poor	9 = Saw Timber Well
F = Spruce Fir	MC = Mixed Conifer	S = Black Spruce	Z = Water		
G = Grass	MD = Mixed Deciduous	T = Tamarack			

PU	Acres	PU	Acres	PU	Acres
1	30.6	5	12.1	9	31.1
2	26.4	6	27.8	10	22.3
3	10.1	7	36.6		
4	20.6	8	37.9		

## Culhane Bridges Pine

### Compartment 44

### 255.5 Acres

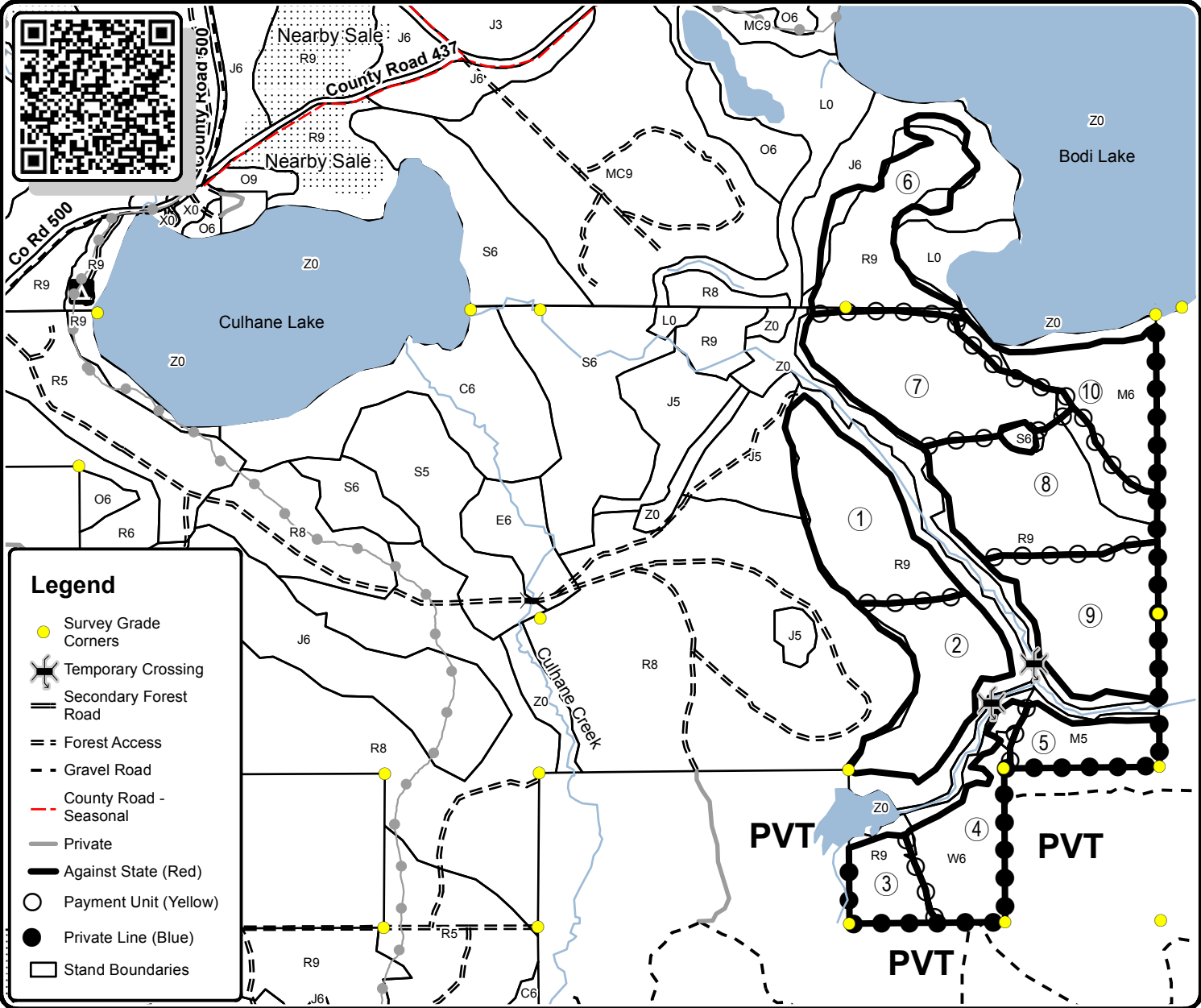

Legend	
	Survey Grade Corners
	Temporary Crossing
	Secondary Forest Road
	Forest Access
	Gravel Road
	County Road - Seasonal
	Private
	Against State (Red)
	Payment Unit (Yellow)
	Private Line (Blue)
	Stand Boundaries

