



TIMBER SALE MAP

This information provided by authority of Part 525, 1994 PA 451, as amended.

Sale Number 53-024-25	Date 05/10/2026	
Scale 1:14,000	Page 1	Of 1

Forest Management Unit Pigeon River Country Mgt Unit	County Otsego	Mapped By: Rekowski Cruised By: Rekowski/Mittig
---	------------------	--

Township 31N	Range 01W	Section(s) and Subdivision(s) Sec. 11 E1/2 SW, SE; Sec. 14 E1/2 NW, N1/2 NE, NESW
-----------------	--------------	---

Cover Type			
A = Aspen	J = Jack Pine	O = Oak	U = Upland Brush
B = Paper Birch	K = Rock	P = Lowland Poplar	UM = Upland Mix Forest
C = Cedar	L = Lowland Brush	Q = Mixed Swamp Conifer	V = Bog or Marsh
D = Treed Bog	LM = Lowland Mix Forest	R = Red Pine	W = White Pine
E = Swamp Hardwoods	M = Maple, Beech, Birch	S = Black Spruce	X = Non Stocked
F = Spruce/Fir	MC = Mixed Conifer	T = Tamarack	Y = Sand
G = Grass	MD = Mixed Deciduous	Z = Water	
H = Hemlock	N = Marsh		

Density	
0 = Non Stocked	5 = Pole Timber Medium
1 = Seedling Sapling Poor	6 = Pole Timber Well
2 = Seedling Sapling Medium	7 = Saw Timber Poor
3 = Seedling Sapling Well	8 = Saw Timber Medium
4 = Pole Timber Poor	9 = Saw Timber Well

Locator Map 1:100,000

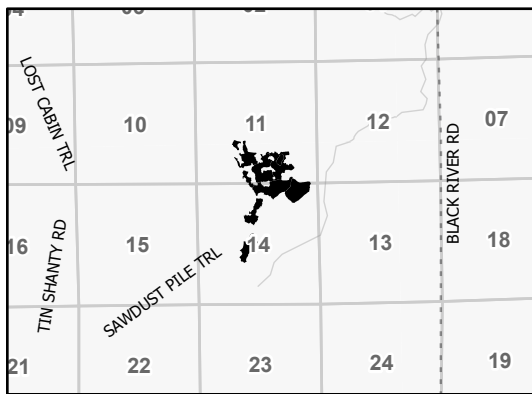

Payment Unit Number	Acres	Payment Unit Number	Acres
1	12.7	6	16.2
2	16	7	8.9
3	2.2	8	10.4
4	3.3	9	14.2
5	18.8		

Ice Bee Buzz Aspen

102.7 Acres

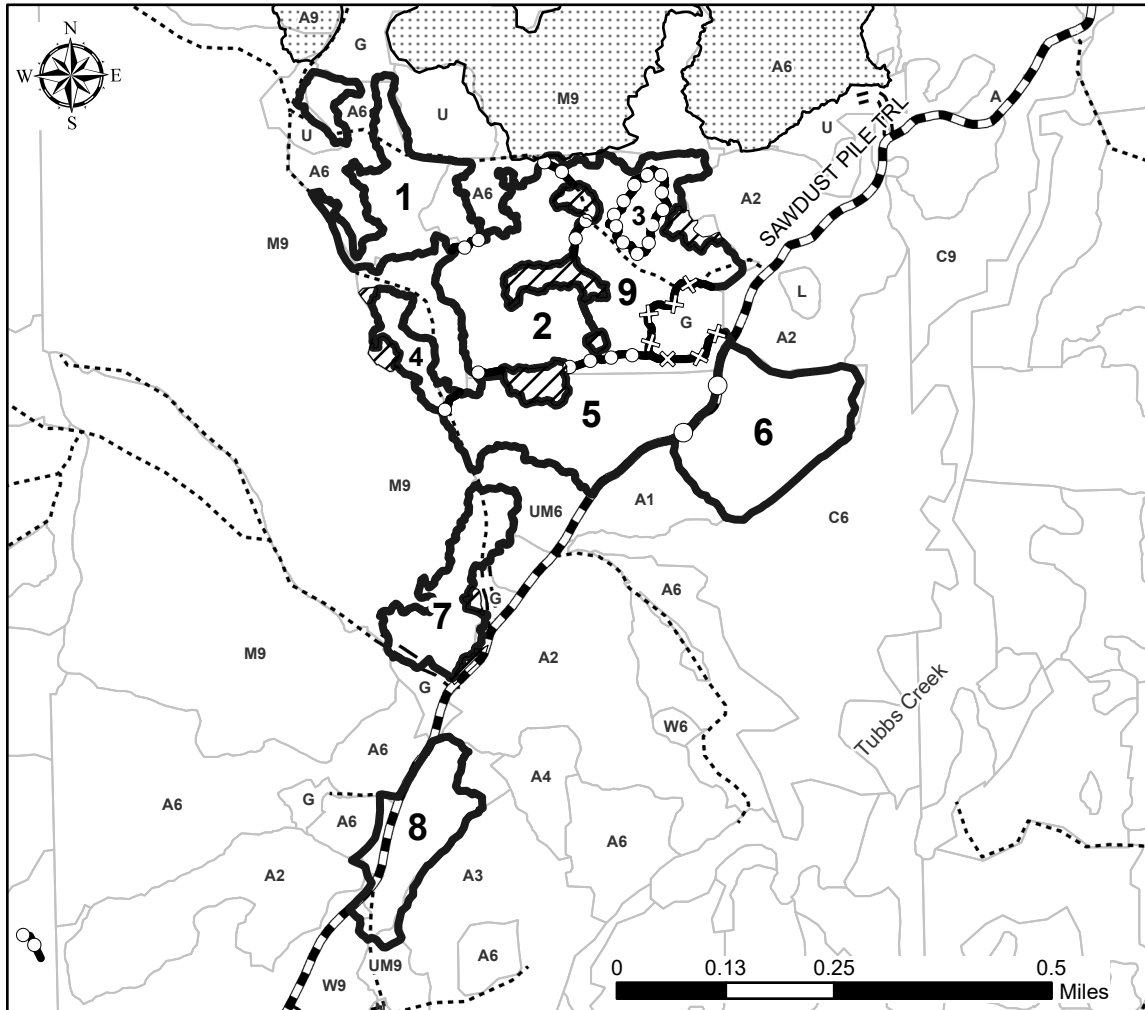

Legend

- Against State (Red)
- Against State (Unpainted)
- Payment Unit (Yellow)
- Payment Unit (Road)
- Retention Areas (Red)
- Nearby Timber Sales
- Recreational Trails
- Forest Access Route
- Administrative Access Only
- Government Gravel/Dirt

Use QR Code to open Map in App

