



TIMBER SALE MAP

This information provided by authority of Part 525, 1994 PA 451, as amended.

Sale Number

53-030-25

Date

08/22/2025

Forest Management Unit

Pigeon River Country Mgt Unit

County

Otsego

Mapped By: Rekowski

Cruised By: Rekowski

Scale

1:12,000

Page

1

Of

1

Township

32N

Range

02W

Section(s) and

Subdivision(s) **Sec. 13 SESE; Sec. 24 NE,NESW,SE;**

Cover Type

A = Aspen	J = Jack Pine	O = Oak	U = Upland Brush
B = Paper Birch	K = Rock	P = Lowland Poplar	UM = Upland Mix Forest
C = Cedar	L = Lowland Brush	Q = Mixed Swamp Conifer	V = Bog or Marsh
D = Treed Bog	LM = Lowland Mix Forest	R = Red Pine	W = White Pine
E = Swamp Hardwoods	M = Maple, Beech, Birch	S = Black Spruce	X = Non Stocked
F = Spruce/Fir	MC = Mixed Conifer	T = Tamarack	Y = Sand
G = Grass	MD = Mixed Deciduous	Z = Water	
H = Hemlock	N = Marsh		

Density

0 = Non Stocked	5 = Pole Timber Medium
1 = Seedling Sapling Poor	6 = Pole Timber Well
2 = Seedling Sapling Medium	7 = Saw Timber Poor
3 = Seedling Sapling Well	8 = Saw Timber Medium
4 = Pole Timber Poor	9 = Saw Timber Well

Locator Map 1:100,000

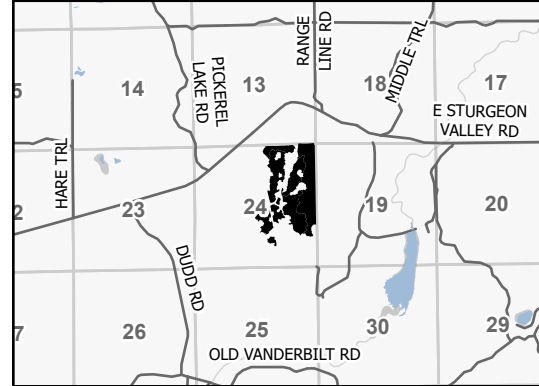

Payment Unit Number	Acres	Payment Unit Number	Acres
1	8.5	5	25.1
2	50.8	6	6
3	24.8	7	10.4
4	16.1		

**Ice-berg
Right Ahead**

141.7 Acres

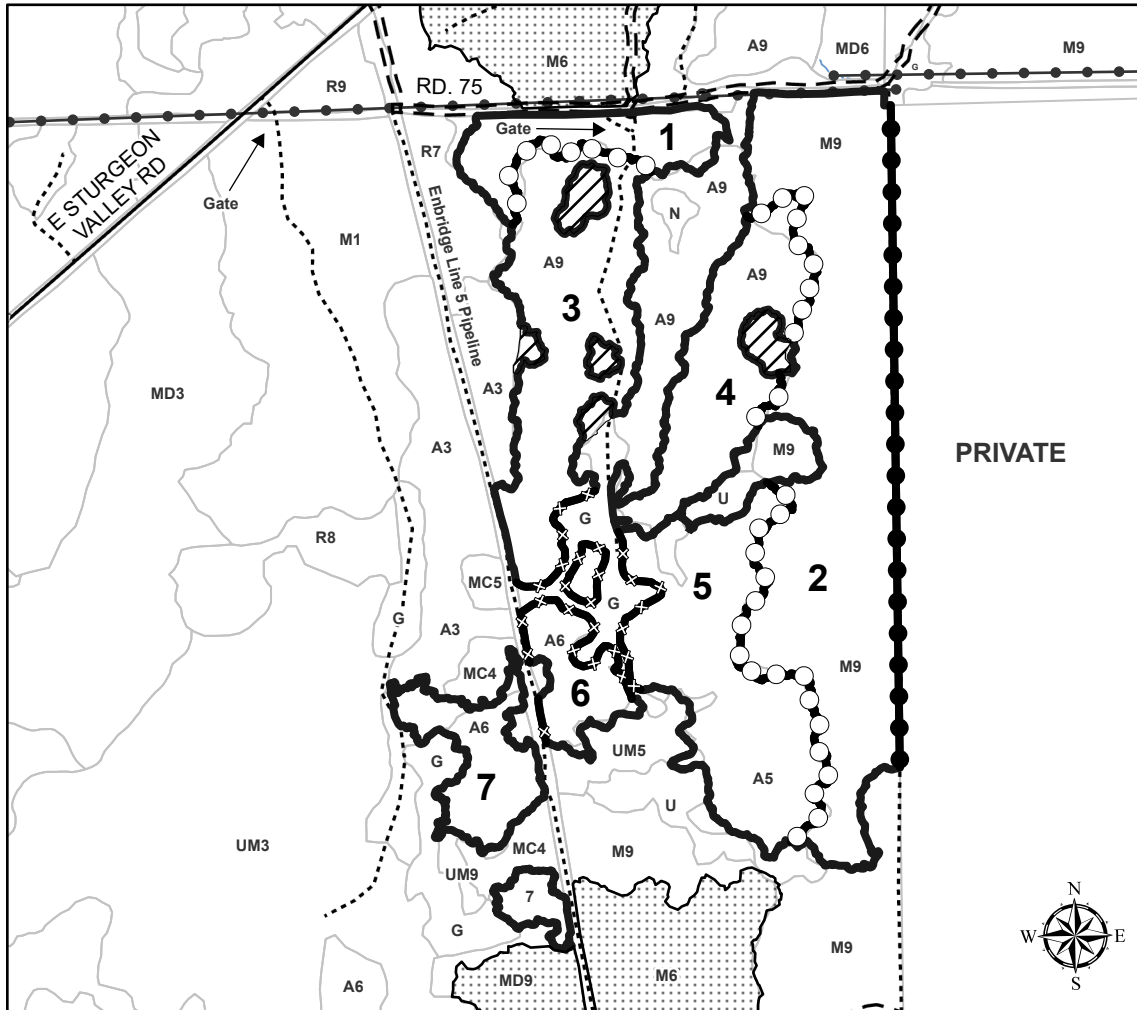
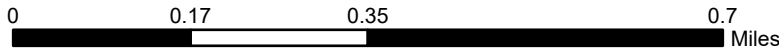

Legend

- Against State (Red)
- Against State (Unpainted)
- Private Line (Blue)
- Payment Unit (Yellow)
- Retention Areas (Red)
- Nearby Timber Sales
- Stand Boundary
- Powerline
- Forest Access Route
- Administrative Access Only
- Paved Road
- Government Gravel/Dirt

PRIVATE



Use QR Code to
open Map in App

