



TIMBER SALE MAP

This information provided by authority of Part 525, 1994 PA 451, as amended.

Forest Management Unit Gladwin		County Clare	Mapped By Martell and Lewicki	Date 9/17/20	Page 3	of 3
Township 20N	Range 04W	Section(s) and Subdivision(s) Sec. 4 - NE; Sec. 14 - S1/2SE; Sec. 22 - NE; Sec. 34 - SENE,W1/2SW,SE		Scale 1:7,920		

Cover Type

A = Aspen	H = Hemlock	N = Marsh	U = Upland Brush
B = Paper Birch	J = Jack Pine	O = Oak	UM = Upland Mixed
C = Cedar	L = Lowland Brush	P = Lowland Poplar	V = Bog or Marsh
D = Treed Bog	LM = Lowland Mixed	Q = Mixed Swamp Conifer	W = White Pine
E = Swamp Hdwoods	M = Mpl, Bch, Brch	R = Red Pine	X = Non Stocked
F = Spruce Fir	MC = Mixed Conifer	S = Black Spruce	Z = Water
G = Grass	MD = Mixed Deciduous	T = Tamarack	

Density

0 = Non Stocked	5 = Pole Timber Medium
1 = Seedling Sapling Poor	6 = Pole Timber Well
2 = Seedling Sapling Medium	7 = Saw Timber Poor
3 = Seedling Sapling Well	8 = Saw Timber Medium
4 = Pole Timber Poor	9 = Saw Timber Well

PU	Acres	PU	Acres
1	15.3	6	21.4
2	5.9	7	30.8
3	22.3	8	10.0
4	7.1	9	4.2
5	26.9	10	12.9

Jungle Hardwoods

Compartment 3

156.8 Acres

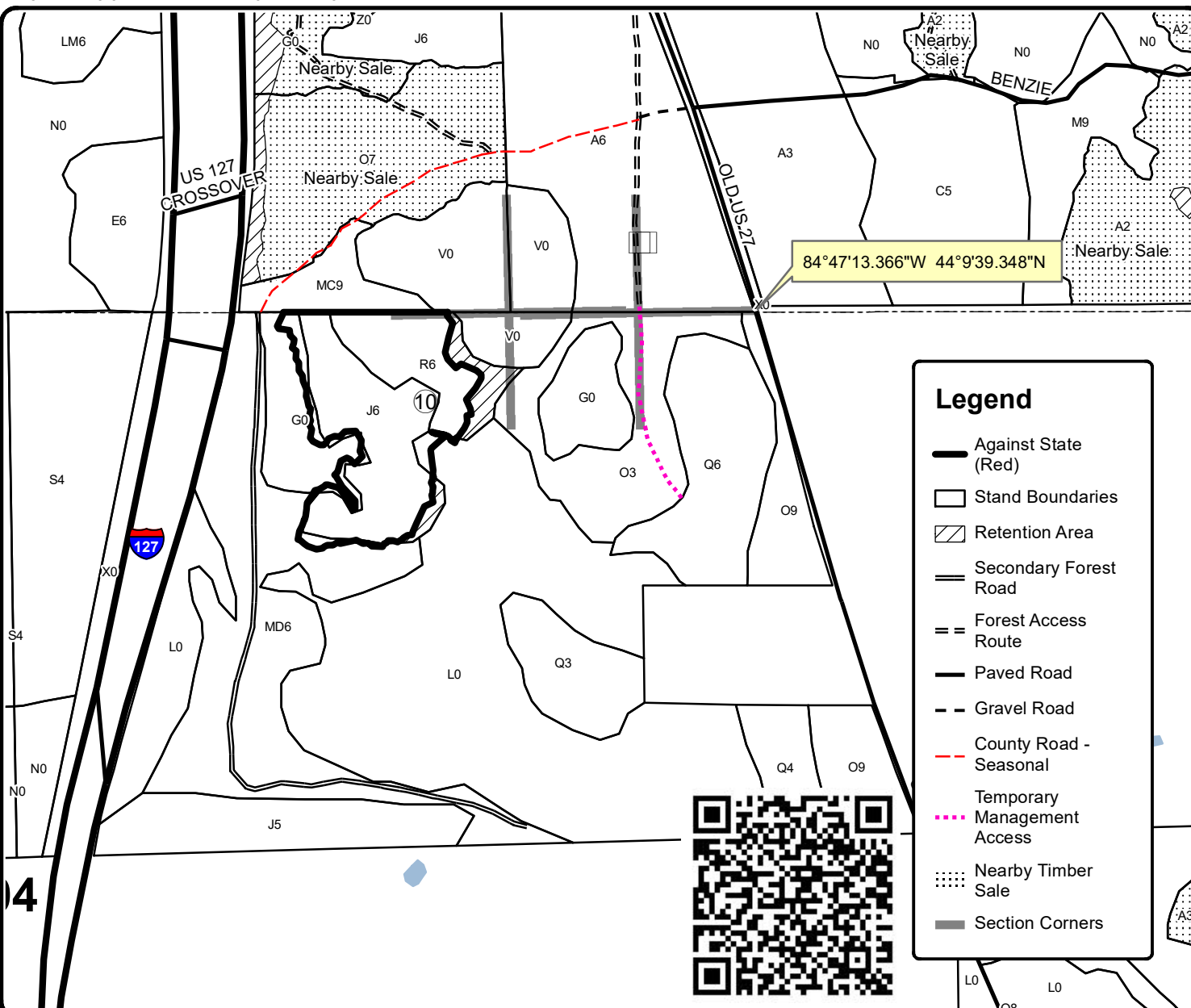
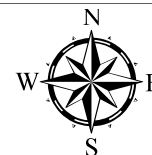

Legend

- Against State (Red)
- Stand Boundaries
- Retention Area
- Secondary Forest Road
- Forest Access Route
- Paved Road
- Gravel Road
- County Road - Seasonal
- Temporary Management Access
- Nearby Timber Sale
- Section Corners

