



TIMBER SALE MAP

This information provided by authority of Part 525, 1994 PA 451, as amended.

Sale Number 45-802-23	Date 06/20/2023	
Scale 1:31,680	Page 1	Of 1

Forest Management Unit Sault Ste Marie Mgt	County Mackinac	Mapped By: A. Livermore
		Cruised By: A. Livermore, Ciaramitaro

Township 43N	Range 02W	Section(s) and Subdivision(s) Sec. 17 E1/2NW,W1/2NE; Sec. 20 S1/2SW,SWSE; Sec. 29 NENW,NWNE;
------------------------	---------------------	--

Cover Type			
A = Aspen	J = Jack Pine	O = Oak	U = Upland Brush
B = Paper Birch	K = Rock	P = Lowland Poplar	UM = Upland Mix Forest
C = Cedar	L = Lowland Brush	Q = Mixed Swamp Conifer	V = Bog or Marsh
D = Treed Bog	LM = Lowland Mix Forest	R = Red Pine	W = White Pine
E = Swamp Hardwoods	M = Maple, Beech, Birch	S = Black Spruce	X = Non Stocked
F = Spruce/Fir	MC = Mixed Conifer	T = Tamarack	Y = Sand
G = Grass	MD = Mixed Deciduous	Z = Water	
H = Hemlock	N = Marsh		

Density	
0 = Non Stocked	5 = Pole Timber Medium
1 = Seedling Sapling Poor	6 = Pole Timber Well
2 = Seedling Sapling Medium	7 = Saw Timber Poor
3 = Seedling Sapling Well	8 = Saw Timber Medium
4 = Pole Timber Poor	9 = Saw Timber Well

GNA2 Aussie Aspen
Compartment: 7914186 Acres: **47.8**



Legend

- Against State
- Payment Unit
- Private Boundary
- Highway
- Paved Road
- - - Gravel Road
- MIRIS Section Corner
- Intermittent Stream
- Perennial River
- Lakes and Rivers
- Paved Road

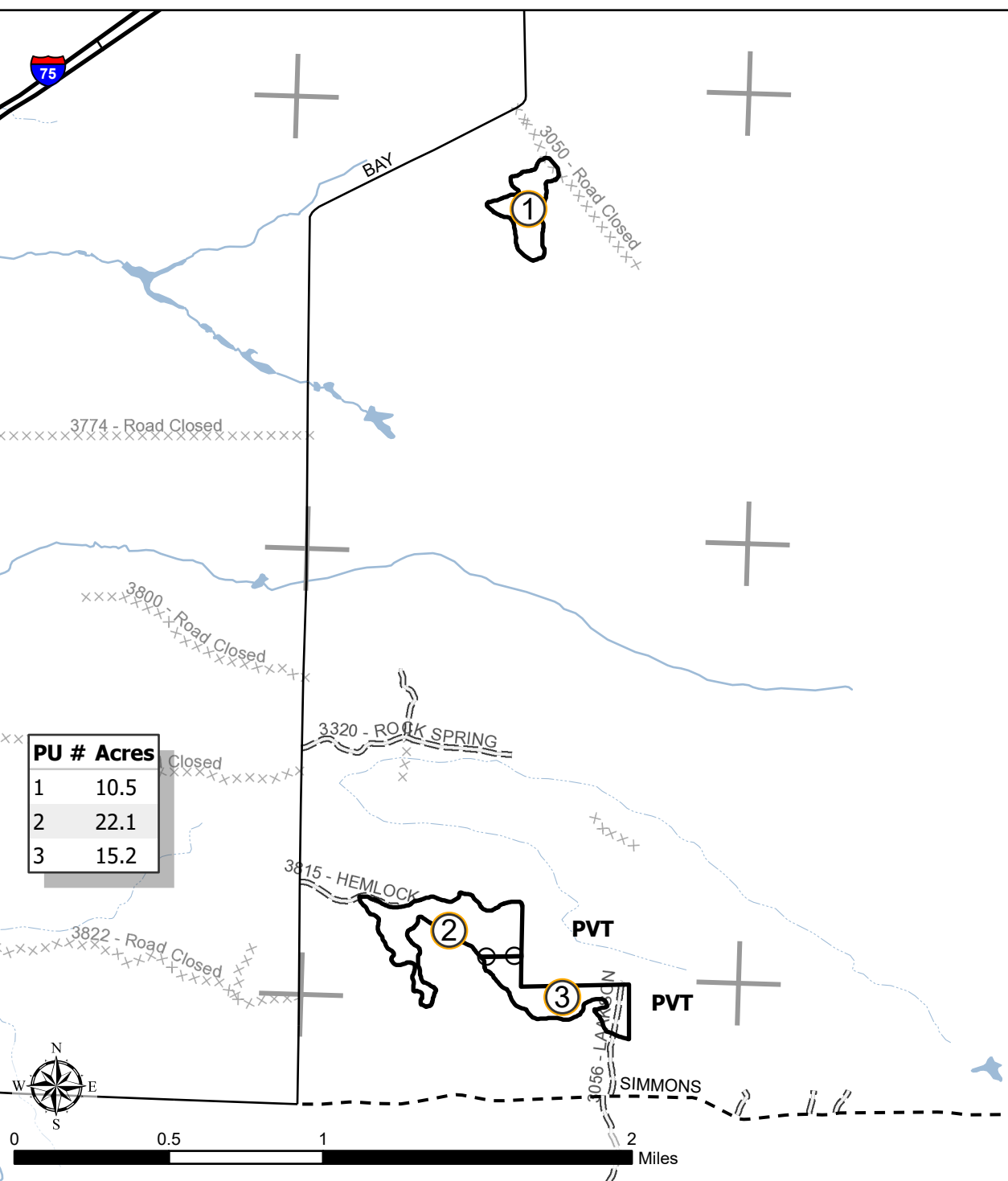
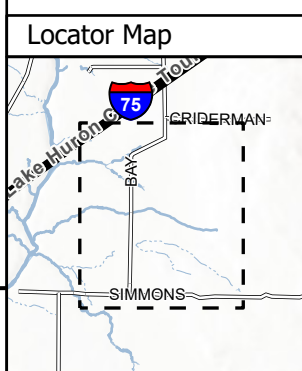

PU #	Acres
1	10.5
2	22.1
3	15.2