



TIMBER SALE MAP

This information provided by authority of Part 525, 1994 PA 451, as amended.

| | |
|-------------|------|
| Sale Number | Year |
| 45 - 120 | 2017 |

| | | | | | |
|---|--------------------|---|--------------------------------|-------------------|---------|
| Forest Management Unit Sault M.U. - Naubinway F.O. | County Mackinac | Mapped By Steve Tuovila | Date 10/4/17 | Page 1 | of 1 |
| Township 44N | Range 09W | Section(s) and Subdivision(s) 35-E1/2NE, NESE 36-N1/2NW, NWSW 25-SWNE, SENW, E1/2SW, SWSW, W1/2SE | Cruised By Edison / Tuovila | Scale 1:15,840 | |

| Cover Type | | | | Density | | | |
|-------------------|----------------------|-------------------------|-------------------|-----------------------------|------------------------|--|--|
| A = Aspen | H = Hemlock | N = Marsh | U = Upland Brush | 0 = Non Stocked | 5 = Pole Timber Medium | | |
| B = Paper Birch | J = Jack Pine | O = Oak | UM = Upland Mixed | 1 = Seedling Sapling Poor | 6 = Pole Timber Well | | |
| C = Cedar | L = Lowland Brush | P = Lowland Poplar | V = Bog or Marsh | 2 = Seedling Sapling Medium | 7 = Saw Timber Poor | | |
| D = Treed Bog | LM = Lowland Mixed | Q = Mixed Swamp Conifer | W = White Pine | 3 = Seedling Sapling Well | 8 = Saw Timber Medium | | |
| E = Swamp Hdwoods | M = Mpl, Bch, Brch | R = Red Pine | X = Non Stocked | 4 = Pole Timber Poor | 9 = Saw Timber Well | | |
| F = Spruce Fir | MC = Mixed Conifer | S = Black Spruce | Z = Water | | | | |
| G = Grass | MD = Mixed Deciduous | T = Tamarack | | | | | |

Cranberry Run Mix
110.4 Acres

| Unit | Acres | Cords |
|------|-------|-------|
| 1 | 48.0 | 1,165 |
| 2 | 62.4 | 1,670 |

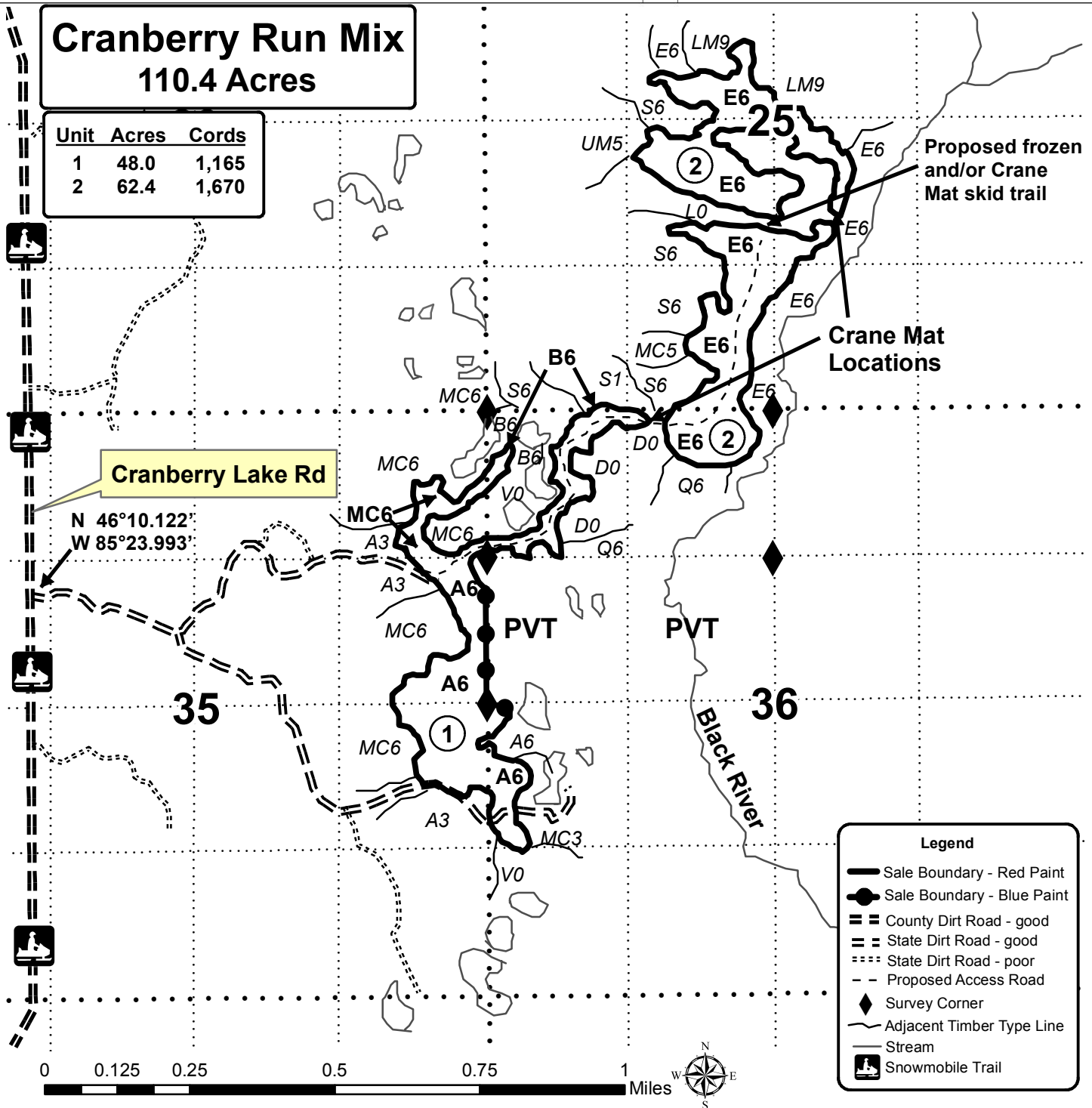

Proposed frozen and/or Crane Mat skid trail

Crane Mat Locations

Cranberry Lake Rd

N 46°10.122'
W 85°23.993'

Legend

- Sale Boundary - Red Paint
- Sale Boundary - Blue Paint
- County Dirt Road - good
- State Dirt Road - good
- State Dirt Road - poor
- Proposed Access Road
- Survey Corner
- Adjacent Timber Type Line
- Stream
- Snowmobile Trail

