



TIMBER SALE MAP

This information provided by authority of Part 525, 1994 PA 451, as amended.

Sale Number	Year
45-004-22	2022

Forest Management Unit Sault Ste. Marie	County Mackinac	Mapped By Brinks	Date 04/01/22	Page 1	of 1
Township T42N	Range R01W	Section(s) and Subdivision(s) Sec. 8- S1/2NW, N1/2SW, SESW, W1/2SE	Scale 1:15,840 1 inch= 1/4 mile		

Cover Type				Density	
A = Aspen	H = Hemlock	N = Marsh	U = Upland Brush	0 = Non Stocked	5 = Pole Timber Medium
B = Paper Birch	J = Jack Pine	O = Oak	UM = Upland Mixed	1 = Seedling Sapling Poor	6 = Pole Timber Well
C = Cedar	L = Lowland Brush	P = Lowland Poplar	V = Bog or Marsh	2 = Seedling Sapling Medium	7 = Saw Timber Poor
D = Treed Bog	LM = Lowland Mixed	Q = Mixed Swamp Conifer	W = White Pine	3 = Seedling Sapling Well	8 = Saw Timber Medium
E = Swamp Hdwoods	M = Mpl. Bch. Brch	R = Red Pine	X = Non Stocked	4 = Pole Timber Poor	9 = Saw Timber Well
F = Spruce Fir	MC = Mixed Conifer	S = Black Spruce	Z = Water		
G = Grass	MD = Mixed Deciduous	T = Tamarack			

Bay City Lake Red Pine
75.3 Acres
851 Cords

Unit 1- 20.8 ac, 235 cords
 Unit 2- 30.4 ac, 344 cords
 Unit 3- 24.1 ac, 272 cords



St. Ignace Road

Webb Rd.
 46.0576° N
 84.4673° W

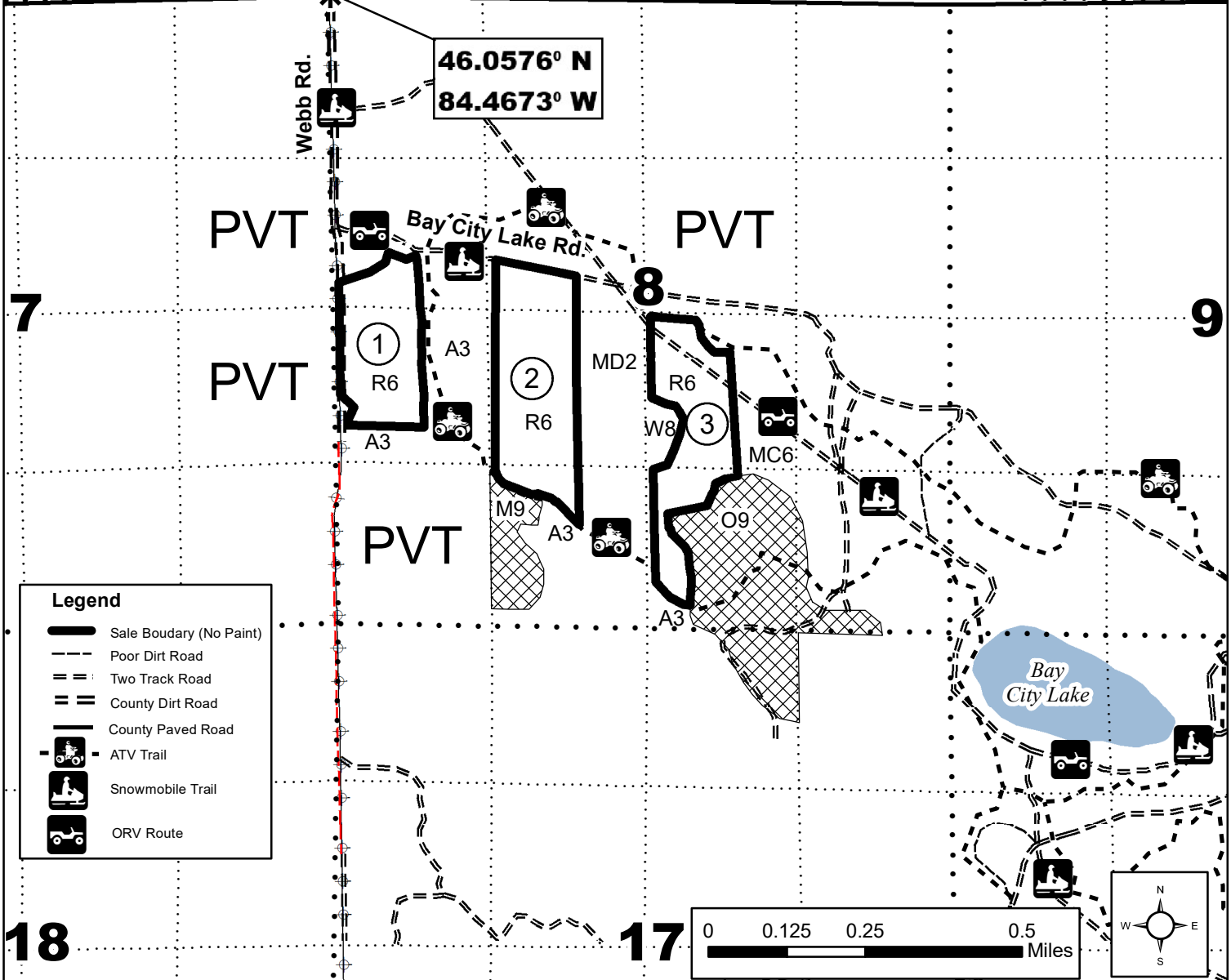

Legend

	Sale Boundary (No Paint)
	Poor Dirt Road
	Two Track Road
	County Dirt Road
	County Paved Road
	ATV Trail
	Snowmobile Trail
	ORV Route

18

17

