



TIMBER SALE MAP

This information provided by authority of Part 525, 1994 PA 451, as amended.

| | | |
|---------------------------------|---------------------------|----------------|
| Sale Number 45-004-24 | Date 06/18/2024 | |
| Scale 1:15,840 | Page 2 | Of 2 |

| | | |
|---|---------------------------|----------------------------|
| Forest Management Unit Sault Ste Marie Mgt Unit | County Chippewa | Mapped By: Fanelli |
| | | Cruised By: Fanelli |

| | | |
|------------------------|---------------------|--|
| Township 44N | Range 01W | Section(s) and Subdivision(s) S1/2NW,S1/2NE,NESE; Sec. 17 S1/2NE; Sec. 18 NWSE,S1/2SE; Sec. 19 N1/2NE; Sec. 20 NW,S1/2NE; Sec. 21 |
|------------------------|---------------------|--|

| Cover Type | | | |
|---------------------|-------------------------|-------------------------|------------------------|
| A = Aspen | J = Jack Pine | O = Oak | U = Upland Brush |
| B = Paper Birch | K = Rock | P = Lowland Poplar | UM = Upland Mix Forest |
| C = Cedar | L = Lowland Brush | Q = Mixed Swamp Conifer | V = Bog or Marsh |
| D = Treed Bog | LM = Lowland Mix Forest | R = Red Pine | W = White Pine |
| E = Swamp Hardwoods | M = Maple, Beech, Birch | S = Black Spruce | X = Non Stocked |
| F = Spruce/Fir | MC = Mixed Conifer | T = Tamarack | Y = Sand |
| G = Grass | MD = Mixed Deciduous | Z = Water | |
| H = Hemlock | N = Marsh | | |

| Density | |
|-----------------------------|------------------------|
| 0 = Non Stocked | 5 = Pole Timber Medium |
| 1 = Seedling Sapling Poor | 6 = Pole Timber Well |
| 2 = Seedling Sapling Medium | 7 = Saw Timber Poor |
| 3 = Seedling Sapling Well | 8 = Saw Timber Medium |
| 4 = Pole Timber Poor | 9 = Saw Timber Well |

Bald Ridge and a Fridge Mix

187.8 Acres

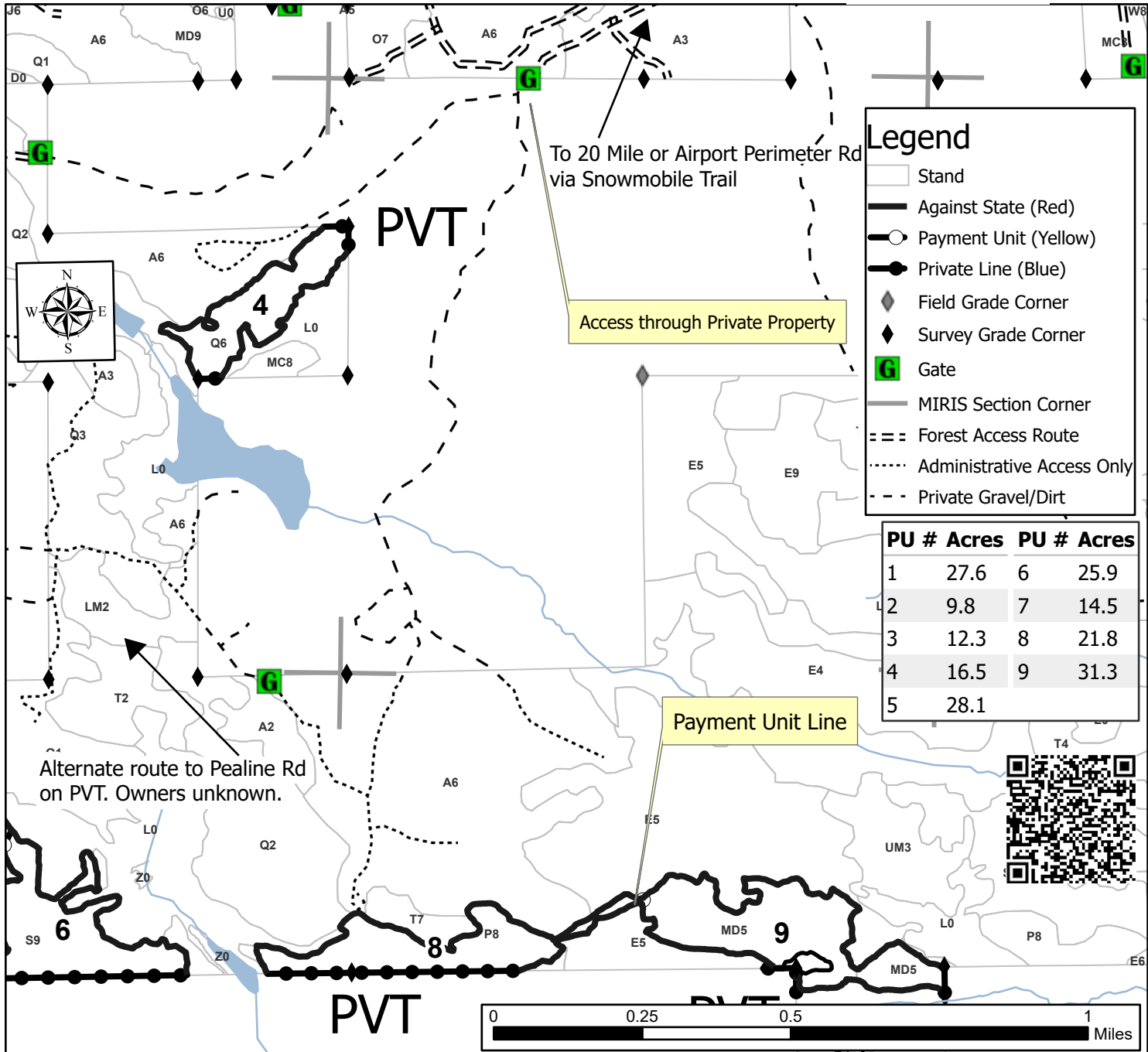

| Legend | |
|--------|----------------------------|
| | Stand |
| | Against State (Red) |
| | Payment Unit (Yellow) |
| | Private Line (Blue) |
| | Field Grade Corner |
| | Survey Grade Corner |
| | Gate |
| | MIRIS Section Corner |
| | Forest Access Route |
| | Administrative Access Only |
| | Private Gravel/Dirt |

| PU # | Acres | PU # | Acres |
|------|-------|------|-------|
| 1 | 27.6 | 6 | 25.9 |
| 2 | 9.8 | 7 | 14.5 |
| 3 | 12.3 | 8 | 21.8 |
| 4 | 16.5 | 9 | 31.3 |
| 5 | 28.1 | | |