



### TIMBER SALE MAP

This information provided by authority of Part 525, 1994 PA 451, as amended.

Sale Number <b>45-008-24</b>	Date <b>08/28/2024</b>	
Scale <b>1:15,840</b>	Page <b>1</b>	Of <b>2</b>

Forest Management Unit <b>Sault Ste Marie Mgt Unit</b>	County <b>Mackinac</b>	Mapped By: <b>Louis Radecki</b>
		Cruised By: <b>Louis Radecki</b>

Township <b>43N</b>	Range <b>01W</b>	Section(s) and Subdivision(s) <b>Sec. 19 NENE; Sec. 20 NWNW,S1/2NW,S1/2NE; Sec. 27 NWNW; Sec. 28 E1/2NE;</b>
------------------------	---------------------	--

Cover Type			
A = Aspen	J = Jack Pine	O = Oak	U = Upland Brush
B = Paper Birch	K = Rock	P = Lowland Poplar	UM = Upland Mix Forest
C = Cedar	L = Lowland Brush	Q = Mixed Swamp Conifer	V = Bog or Marsh
D = Treed Bog	LM = Lowland Mix Forest	R = Red Pine	W = White Pine
E = Swamp Hardwoods	M = Maple, Beech, Birch	S = Black Spruce	X = Non Stocked
F = Spruce/Fir	MC = Mixed Conifer	T = Tamarack	Y = Sand
G = Grass	MD = Mixed Deciduous	Z = Water	
H = Hemlock	N = Marsh		

Density	
0 = Non Stocked	5 = Pole Timber Medium
1 = Seedling Sapling Poor	6 = Pole Timber Well
2 = Seedling Sapling Medium	7 = Saw Timber Poor
3 = Seedling Sapling Well	8 = Saw Timber Medium
4 = Pole Timber Poor	9 = Saw Timber Well

PU #	Acres
1	18.5
2	16.5
3	21.8
4	27

## Clear the Way

**83.8 Acres**

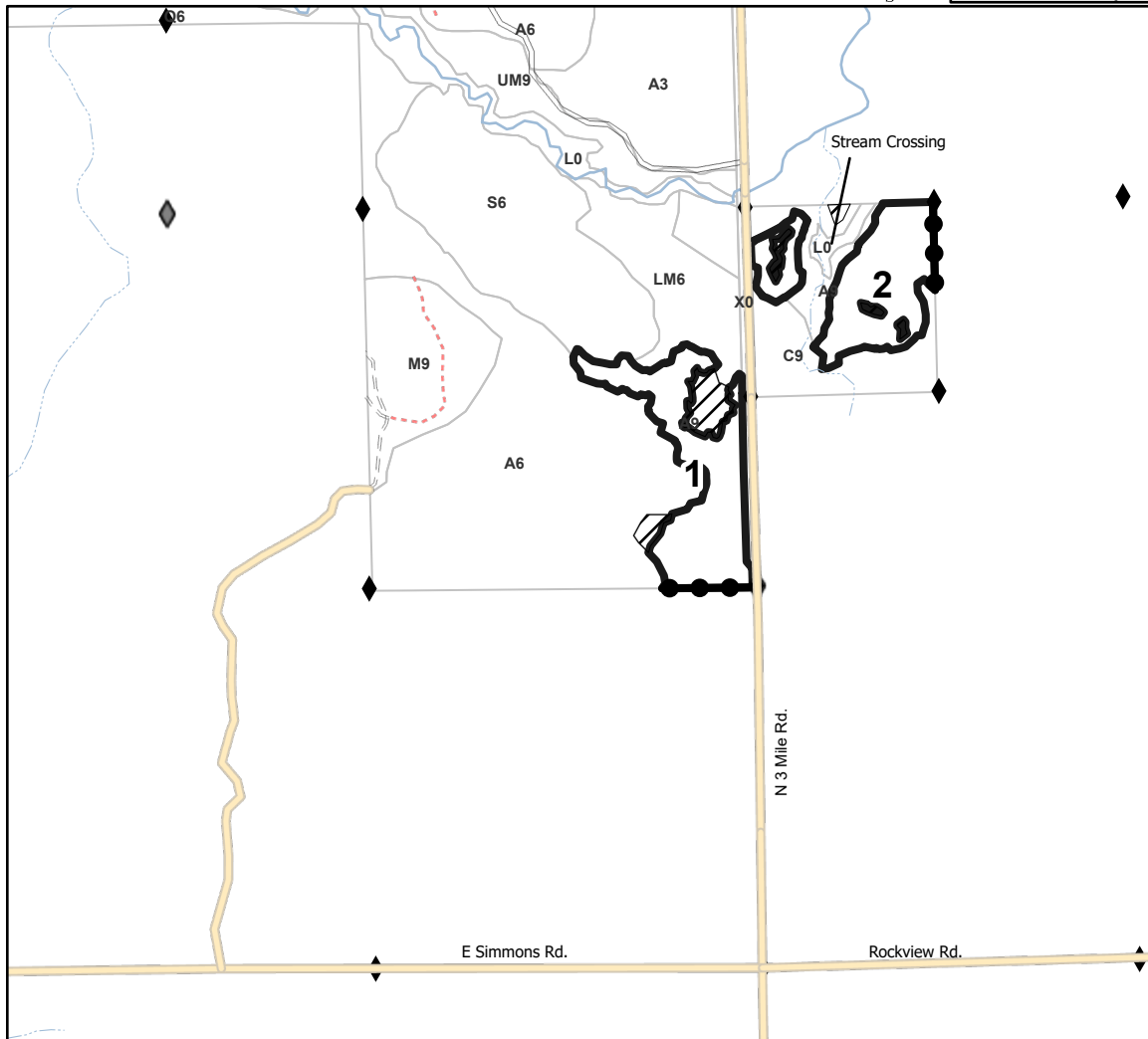
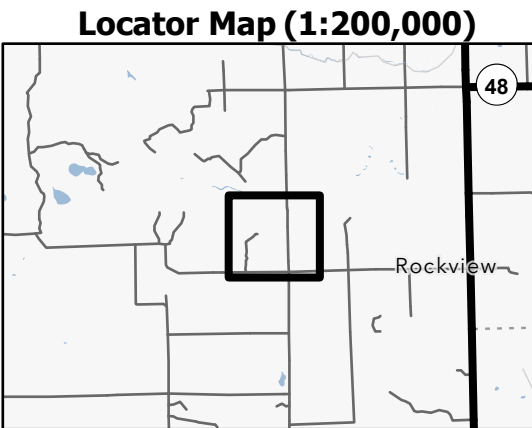

### Legend

- Payment Unit
- Stand
- Retention Areas
- Against State (Red)
- Private Line (Blue)
- Secondary Forest Road
- Forest Access Route
- Administrative Access Only
- Non-DNR Road
- Field Grade Corner
- Survey Grade Corner

Use QR Code to open Map in App

