



TIMBER SALE MAP

This information provided by authority of Part 525, 1994 PA 451, as amended.

Forest Management Unit Sault Ste. Marie		County Chippewa	Mapped By Amy Livermore	Date 01/27/2021	Page 1	of 1
Township 46N	Range 06W	Section(s) and Subdivision(s) E½ NW, W½ NE, SENE, NESW, S½ SE sec. 33 & NWNW, W½ NE, N½ SW, S1/2 NW sec. 34 & SE sec. 27 & W½ SW, NESW sec. 26	Cruised By A. Livermore & Brinks	Scale 1:15,840		
Cover Type			Density			
A = Aspen	H = Hemlock	N = Marsh	U = Upland Brush	0 = Non Stocked	5 = Pole Timber Medium	
B = Paper Birch	J = Jack Pine	O = Oak	UM = Upland Mixed	1 = Seedling Sapling Poor	6 = Pole Timber Well	
C = Cedar	L = Lowland Brush	P = Lowland Poplar	V = Bog or Marsh	2 = Seedling Sapling Medium	7 = Saw Timber Poor	
D = Treed Bog	LM = Lowland Mixed	Q = Mixed Swamp Conifer	W = White Pine	3 = Seedling Sapling Well	8 = Saw Timber Medium	
E = Swamp Hdwoods	M = Mpl, Bch, Brch	R = Red Pine	X = Non Stocked	4 = Pole Timber Poor	9 = Saw Timber Well	
F = Spruce Fir	MC = Mixed Conifer	S = Black Spruce	Z = Water			
G = Grass	MD = Mixed Deciduous	T = Tamarack				

PU	Acres	MBF	Cords
1	13	16.6	84
2	7.8	8.1	37
3	34.9	47.6	217
4	37.8	88.9	268
5	57.4	134.9	406
6	50.7	102.9	349
7	30.2	38.6	244

GNA2 Atlantic#1

Compartments 7915066, 7915068
231.7 Acres

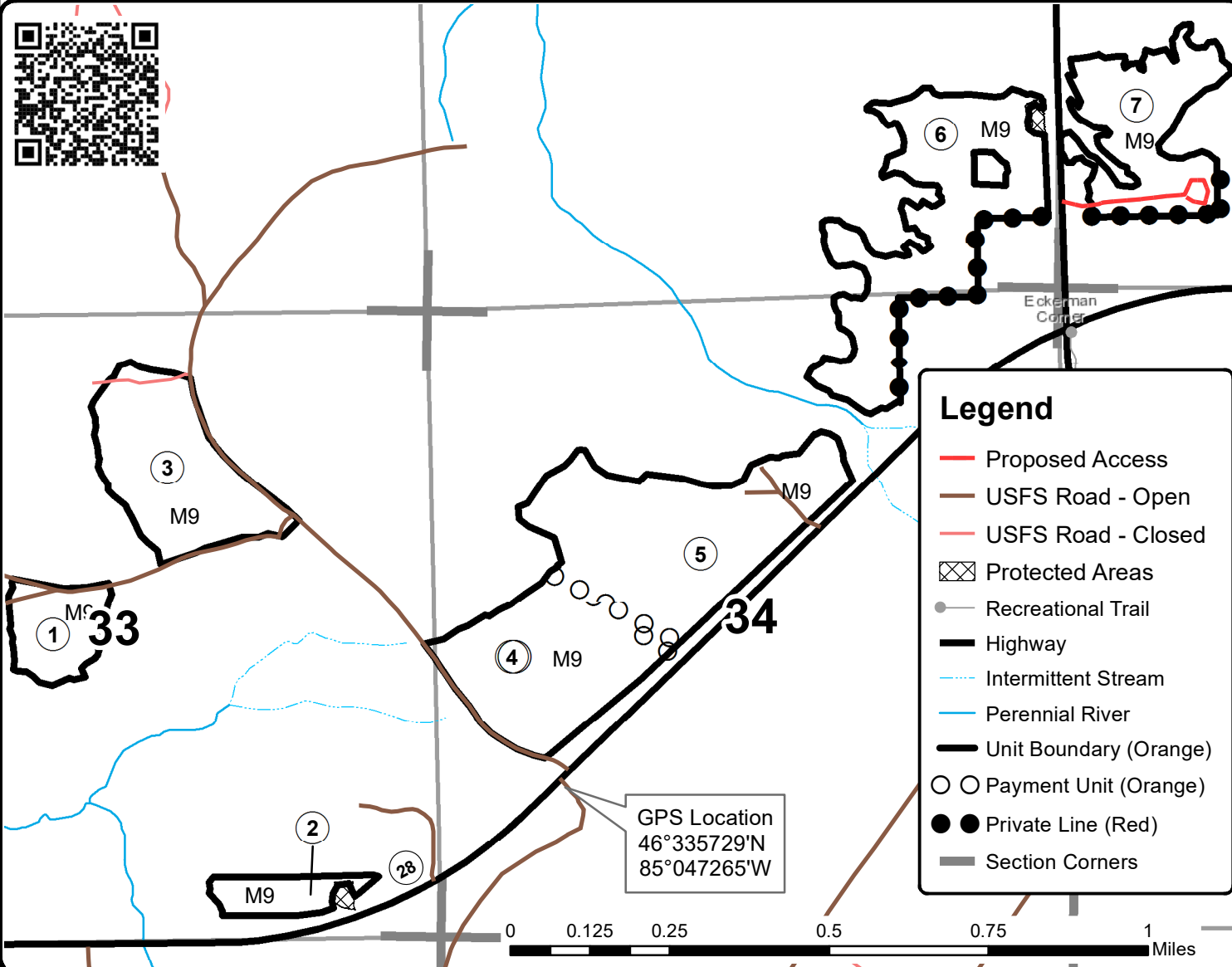

Legend

- Proposed Access (Red line)
- USFS Road - Open (Brown line)
- USFS Road - Closed (Red line)
- Protected Areas (X in square)
- Recreational Trail (Grey line with circles)
- Highway (Thick black line)
- Intermittent Stream (Dashed blue line)
- Perennial River (Solid blue line)
- Unit Boundary (Orange line)
- Payment Unit (Orange line)
- Private Line (Red dot)
- Section Corners (Grey square)