



# TIMBER SALE MAP

45-802-18

2018

*This information provided by authority of Part 525, 1994 PA 451, as amended.*

Forest Management Unit <b>Sault Ste. Marie</b>		County <b>Mackinac</b>	Mapped By <b>Brinks</b>	Date <b>8/02/2018</b>	Page <b>1</b>	of <b>1</b>
Township <b>T41N</b>	Range <b>R05W</b>	Section(s) and Subdivision(s) <b>See Below</b>		Scale <b>1:15840 or 4"=1 mile</b>		
Cover Type				Density		
A = Aspen	H = Hemlock	N = Marsh	U = Upland Brush	0 = Non Stocked	5 = Pole Timber Medium	
B = Paper Birch	J = Jack Pine	O = Oak	UM = Upland Mixed	1 = Seedling Sapling Poor	6 = Pole Timber Well	
C = Cedar	L = Lowland Brush	P = Lowland Poplar	V = Bog or Marsh	2 = Seedling Sapling Medium	7 = Saw Timber Poor	
D = Treed Bog	LM = Lowland Mixed	Q = Mixed Swamp Conifer	W = White Pine	3 = Seedling Sapling Well	8 = Saw Timber Medium	
E = Swamp Hdwoods	M = Mpl, Bch, Brch	R = Red Pine	X = Non Stocked	4 = Pole Timber Poor	9 = Saw Timber Well	
F = Spruce Fir	MC = Mixed Conifer	S = Black Spruce	Z = Water			
G = Grass	MD = Mixed Deciduous	T = Tamarack				

## GNA Cape Cod 134.9 Acres

**Legend**

- Against USFS (Orange)
- Against Private (Red)
- County Paved Rd.
- USFS Gravel Rd.
- USFS Poor Dirt Rd.
- USFS Closed Rd.
- Temporary Rd. (Approx.)
- North Country Trail
- Pipeline
- Powerline
- Temporary Landing
- Survey Corner
- Snowmobile Trail

Sec 11- E1/2SW, W1/2SE  
 Sec 14- NW1/4, N1/2NE,  
 SWNE, NESW, S1/2SW, NWSE  
 Sec 15- E1/2SE  
 Sec 22- NENE

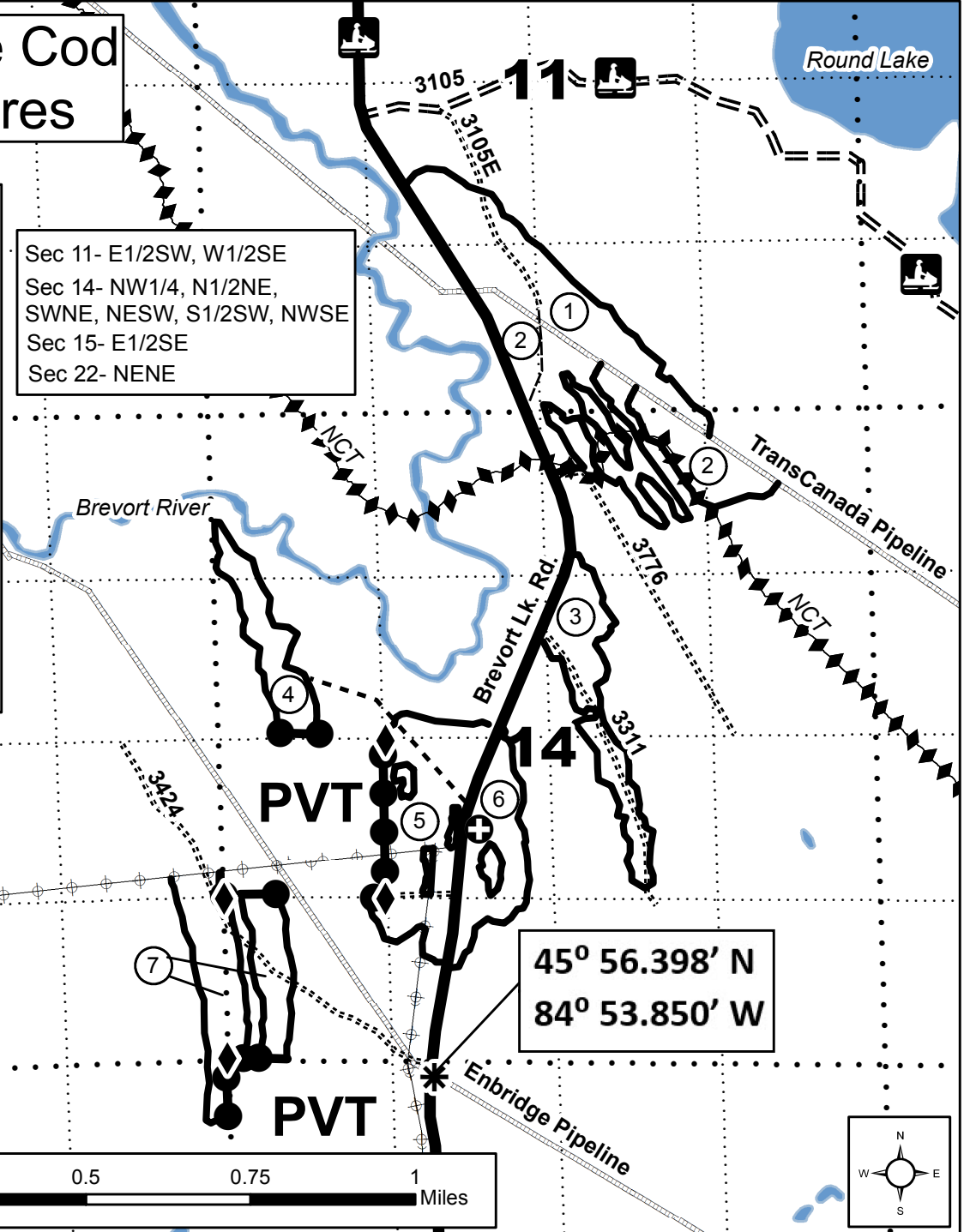

**45° 56.398' N**  
**84° 53.850' W**

