



TIMBER SALE MAP

This information provided by authority of Part 525, 1994 PA 451, as amended.

Forest Management Unit Sault Ste. Marie		County Chippewa	Mapped By Brinks	Date 8/10/20	Page 1	of 1
Township T42N	Range R07E	Section(s) and Subdivision(s) See Below		Scale 1:15,840 1 inch= 1/4 mile		

Cover Type				Density	
A = Aspen	H = Hemlock	N = Marsh	U = Upland Brush	0 = Non Stocked	5 = Pole Timber Medium
B = Paper Birch	J = Jack Pine	O = Oak	UM = Upland Mixed	1 = Seedling Sapling Poor	6 = Pole Timber Well
C = Cedar	L = Lowland Brush	P = Lowland Poplar	V = Bog or Marsh	2 = Seedling Sapling Medium	7 = Saw Timber Poor
D = Treed Bog	LM = Lowland Mixed	Q = Mixed Swamp Conifer	W = White Pine	3 = Seedling Sapling Well	8 = Saw Timber Medium
E = Swamp Hdwoods	M = Mpl, Bch, Brch	R = Red Pine	X = Non Stocked	4 = Pole Timber Poor	9 = Saw Timber Well
F = Spruce Fir	MC = Mixed Conifer	S = Black Spruce	Z = Water		
G = Grass	MD = Mixed Deciduous	T = Tamarack			

Sand Bay Mix 135.1 Acres

- Unit 1- 29.5 ac
- Unit 2- 40.2 ac
- Unit 3- 23.8 ac
- Unit 4- 43.7 ac

Sec 21- SENE, NESE
 Sec 22- W1/2W1/2
 Sec 27- NENW, W1/2NE, SENE

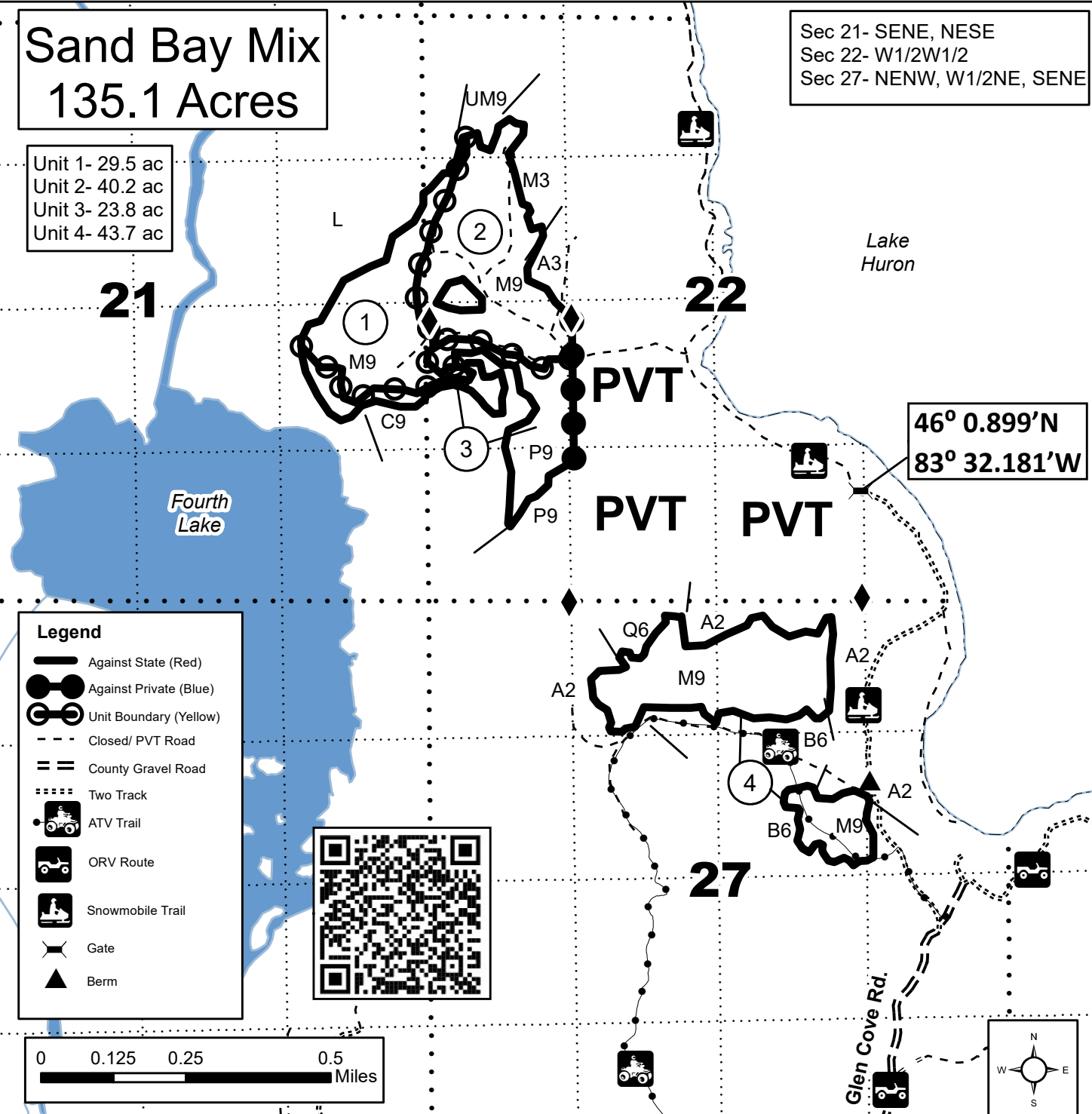

Legend

- Against State (Red)
- Against Private (Blue)
- Unit Boundary (Yellow)
- - - Closed/ PVT Road
- == County Gravel Road
- ⋯⋯ Two Track
- 🛵 ATV Trail
- 🛵 ORV Route
- 🛵 Snowmobile Trail
- ⚡ Gate
- ▲ Berm

46° 0.899'N
 83° 32.181'W

