



TIMBER SALE MAP

This information provided by authority of Part 525, 1994 PA 451, as amended.

Sale Number 41-014-23	Date 11/17/2023	
Scale 1:15,840	Page 1	Of 1

Forest Management Unit Shingleton Mgt Unit	County Schoolcraft	Mapped By: Sean Fischer Cruised By: Kentner, Bramer, Bonnett, Molin
---	-----------------------	--

Township 45N/46N	Range 14W	Section(s) and Subdivision(s) Sec. 32 N1/2NE,SENE,NESE; Sec. 33 NW,W1/2NE,NWSW,S1/2SW,SE; Sec. 34 W1/2SW; Sec. 4 NENW, NENE;
---------------------	--------------	--

Cover Type

A = Aspen	J = Jack Pine	O = Oak	U = Upland Brush
B = Paper Birch	K = Rock	P = Lowland Poplar	UM = Upland Mix Forest
C = Cedar	L = Lowland Brush	Q = Mixed Swamp Conifer	V = Bog or Marsh
D = Treed Bog	LM = Lowland Mix Forest	R = Red Pine	W = White Pine
E = Swamp Hardwoods	M = Maple, Beech, Birch	S = Black Spruce	X = Non Stocked
F = Spruce/Fir	MC = Mixed Conifer	T = Tamarack	Y = Sand
G = Grass	MD = Mixed Deciduous	Z = Water	
H = Hemlock	N = Marsh		

Density

0 = Non Stocked	5 = Pole Timber Medium
1 = Seedling Sapling Poor	6 = Pole Timber Well
2 = Seedling Sapling Medium	7 = Saw Timber Poor
3 = Seedling Sapling Well	8 = Saw Timber Medium
4 = Pole Timber Poor	9 = Saw Timber Well

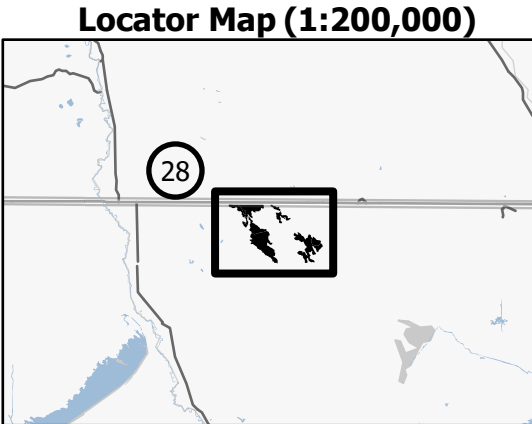

PU #	Acres	PU #	Acres
1	9.6	6	3.4
2	53.5	7	1.8
3	15.2	8	20.4
4	4.2	9	67.7
5	37.5		

Stuck in a Ditch

213.3 Acres

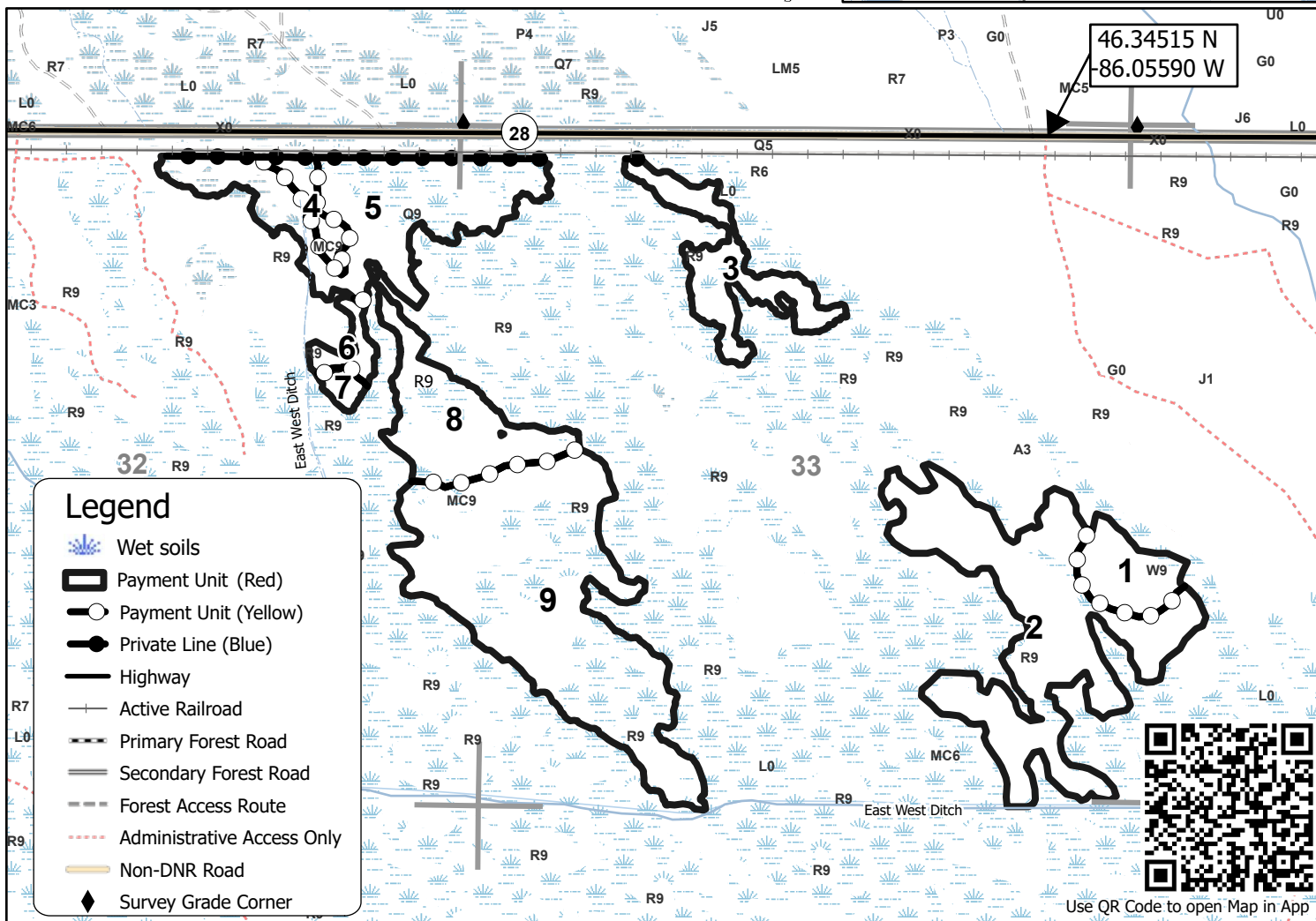

Legend

- Wet soils
- Payment Unit (Red)
- Payment Unit (Yellow)
- Private Line (Blue)
- Highway
- Active Railroad
- Primary Forest Road
- Secondary Forest Road
- Forest Access Route
- Administrative Access Only
- Non-DNR Road
- Survey Grade Corner



Use QR Code to open Map in App