

NORTH CENTRAL SURVEY, INC.

LAND SURVEYING AND MAPPING
RUSSELL A. CAVANAGH, P.S.

211 W. WEST BRANCH ROAD, SUITE 101 • PRUDENVILLE, MICHIGAN 48651
PHONE: 989-366-5000 • FAX: 989-366-5000

MEMBER OF MICHIGAN SOCIETY OF
PROFESSIONAL SURVEYORS

russ@northcentralsurvey.com

northcentralsurvey.com



Grayling (SE)

Township 26N - Range 2W

Copyright © 2016 Mapping Solutions

SEE PAGE 19

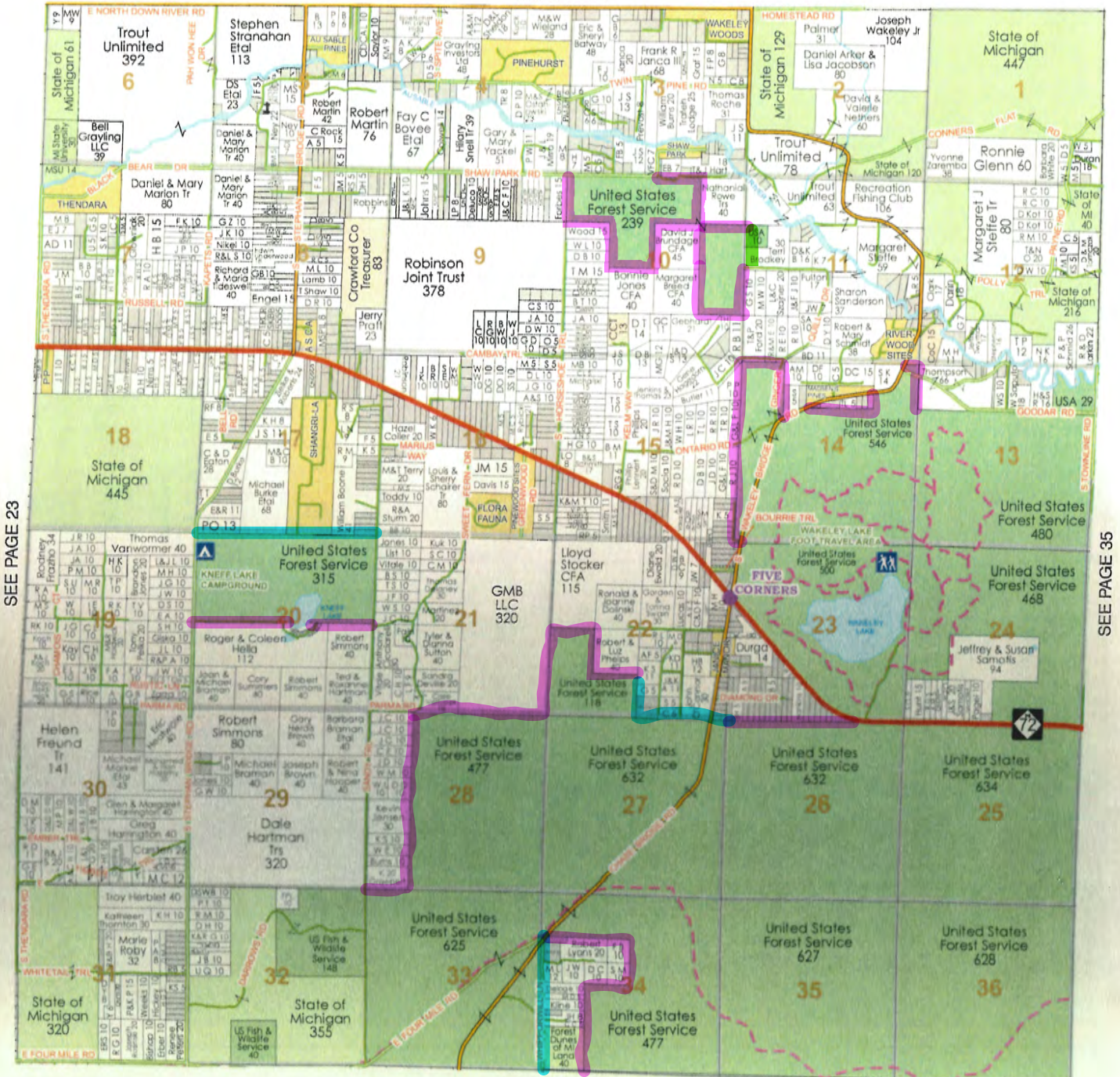

SEE PAGE 23

SEE PAGE 35

SEE PAGE 37