

**SURVEY &
REMONUMENTATION**

MAR 02 2009



DELIVERED TO NEWAYGO CO
02/05/2009 3:11:56 PM

2008 Newaygo County Remonumentation Project

SECTION

LAND CORNER RECORDATION CERTIFICATE
Filing Requirement of Act 74, Mich. P.A. 1970

For corners in
Newaygo
(County)

Located in: Corner Code #

VOL. 6 137

- Public Land Survey
T13N R11W F-7
T N R W
T N R W
T N R W
T N R W
- Property Controlling in Section
S
S
S
S
- Miscellaneous Property in Sec.
S
S
S
S



LINDA M. LANDHEER
NEWAYGO COUNTY REGISTER OF DEEDS
RECEIVED AND RECORDED
02/05/2009 3:19:08 PM

Register of Deeds Stamp & File Number

- Lot No. _____ Recorded Plat _____
 - Private Claims _____
- I, Norman L. Ochs, in a field survey on January 4, 2008 do hereby certify that under requirements of P.A. 74, Michigan P.A. of 1970, the corner points mentioned in lines 1 and 2 above were in conformance with regulations and rules therefore as required in the current manual of survey instructions of the United States Department of the Interior, Bureau of Land Management or by a decree of a Court of Law and/or that the corner points mentioned in lines 2, 4 and 5 above were in conformance with the rules of the Michigan Board of Land Surveyors or by a Decree of a Court of Law; established, re-established, monumented, re-monumented, recovered, found as expressed below:
- Note: Not more than 2 corners, all in the same town and range, may be Recorded on this certificate.**
- Quarter corner common to Sections 16 and 21, T13N R11W, Big Prairie Township.
- | | | | | | | | | | | | | |
|----|----|----|----|----|----|----|---|---|---|---|---|---|
| A | B | C | D | E | F | G | H | I | J | K | L | M |
| 2 | 6 | 5 | 4 | 3 | 2 | 1 | | | | | | |
| 3 | | | | | | | | | | | | |
| 4 | 7 | 8 | 9 | 10 | 11 | 12 | | | | | | |
| 5 | | | | | | | | | | | | |
| 6 | 18 | 17 | 16 | 15 | 14 | 13 | | | | | | |
| 7 | | | | | | | | | | | | |
| 8 | 19 | 20 | 21 | 22 | 23 | 24 | | | | | | |
| 9 | | | | | | | | | | | | |
| 10 | 30 | 29 | 28 | 27 | 26 | 25 | | | | | | |
| 11 | | | | | | | | | | | | |
| 12 | 31 | 32 | 33 | 34 | 35 | 36 | | | | | | |
| 13 | | | | | | | | | | | | |

A. DESCRIPTION OF ORIGINAL MONUMENT AND ACCESSORIES AND/OR SUBSEQUENT RESTORATION:

GLO - James H. Mullett
4th quarter 1837 Set quarter section post
#1 12" Pine S70°E 32 links (21.12')
#2 18" Pine N48°W 27 links (17.82')
Lyle S. Shepherd, R.L.S. # 503
Fargo Engineering 1925
Found old stake and two US witnesses Set standard marker
Book 21, Page 133 July 1926 Pipe
#1 12" Pine S70°E 32 links (21.12') OBT
#2 18" Pine N48°W 27 links (17.82') OBT
#3 5" White Oak S17°E .17 chains (11.22')
#4 6" White Oak N89½°E .21 chains (13.86')

OVER

B. DESCRIPTION OF CORNER EVIDENCE FOUND AND/OR METHOD APPLIED IN RESTORING OR REESTABLISHING CORNER:

I found a Consumer Power Company Standard Marker. The corner is on line with the occupation of "Sportsman's Park" South and East. The condition of the witnesses are as follows: #1 thru #4 gone, #5 found 10" White Oak N10°W 30.0' to center, #6 4" - 10" Clump Maple S80°W 30.6' to center, #7 thru #10 in good condition.

C. DESCRIPTION OF MONUMENT FOR CORNER AND ACCESSORIES ESTABLISHED TO PERPETUATE LOCATING THE POSITION OF THE CORNER:

I accepted the Consumer Power Company Standard Marker 2.5' below grade as a substantial marker for the corner and is accepted as a careful and faithful perpetuation of the position of the original quarter corner.

- #7 18" Black Oak S58°E 9.08'
 - #8 14" Black Oak N50°E 26.88'
 - #9 8" Maple S83°W 3.85'
 - #10 18" Black Oak N47°W 35.65'
- Found spike with tag #22439 in North side
Found spike with tag #22439 in Northwest side
Found spike with tag #22439 in North side
Found spike with tag # 22439 in Northeast side

Signed by Norman L. Ochs
Norman L. Ochs

Date January 23, 2009

Surveyor's Michigan License No. 22439

Form approved by Michigan State Board of Land Surveyors, Jan. 28, 1971
Revised May 14, 1975
Revised Jan., 1983

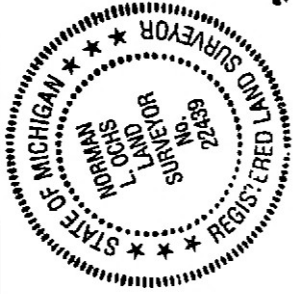

Approved by Peer Review Group on July 16, 2008
Norman L. Ochs, County Representative.

N.L.O.